

T.3S. R.2W. Section 19, W.M.

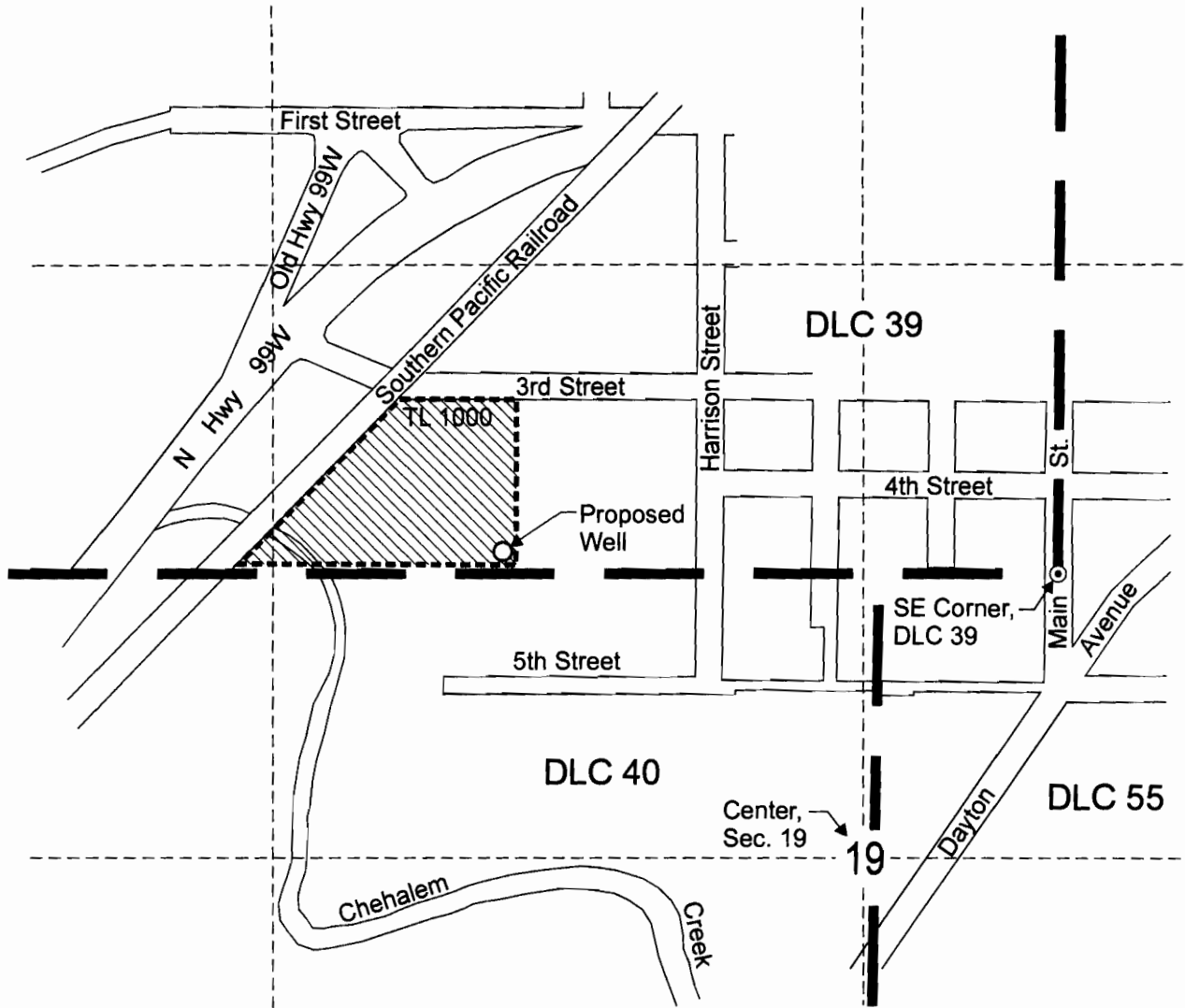

Proposed well is located 50 feet north and 1,240 feet west from the SE corner of DLC 39.

 Area proposed for industrial use.

----- Tax lot boundary

RECEIVED

OCT 28 2005

WATER RESOURCES DEPT
SALEM, OREGON

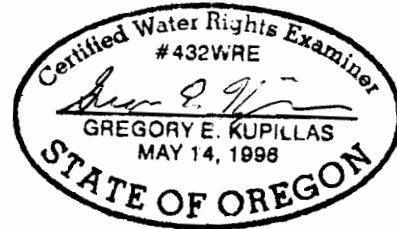

EXPIRATION DATE: 6/30/07

Scale: 1" = 400'

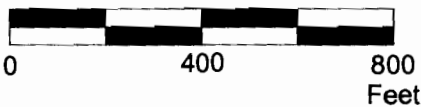

This map was prepared for the purpose of identifying the location of a water right only and is not intended to provide legal dimensions or location of property ownership lines.



BakerRockNewbergApp.cdr

Pacific Hydro-Geology Inc.

Water Right Application Map

Baker Rock Resources Redi-Mix
T.3S. R.2W. Section 19BD, W.M., Tax Lot 1000

8/2005

App no G-110559