

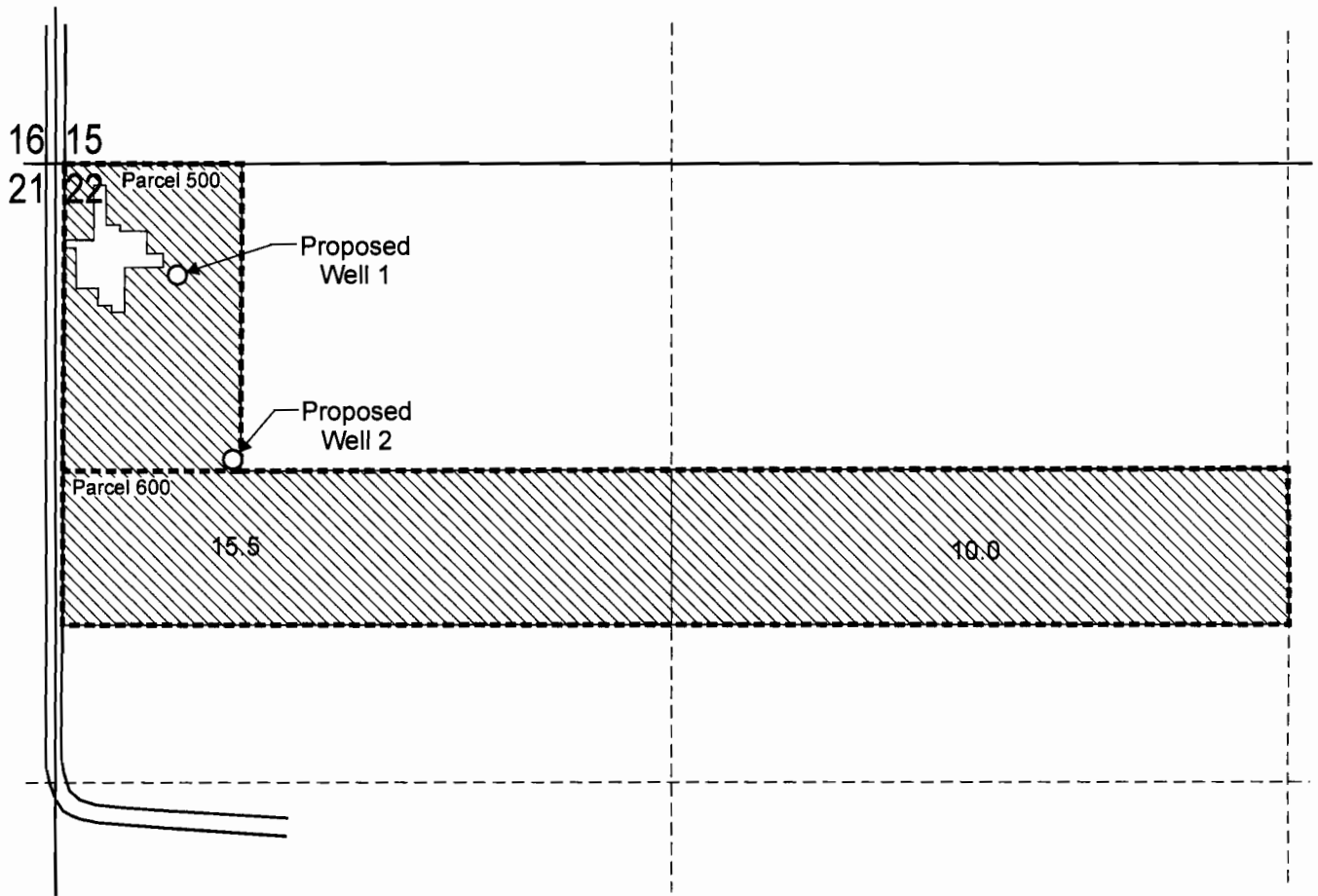

# T.5S. R.1E. Section 22, W.M.



Proposed Well 1 is located 240 feet south and 260 feet east from the NW corner of Section 22.  
 Proposed Well 2 is located 630 feet south and 380 feet east from the NW corner of Section 22.

 Area (25.5 Acres) to be irrigated.

 Tax lot boundary

**RECEIVED**

MAR 22 2007

WATER RESOURCES DEPT  
 SALEM, OREGON

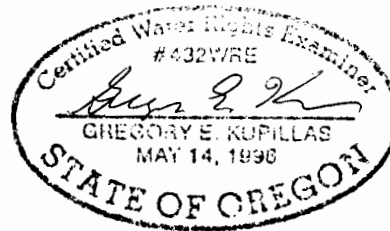

EXPIRATION DATE: 6/30/07

Scale: 1" = 400'

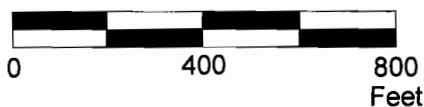

This map was prepared for the purpose of identifying the location of a water right only and is not intended to provide legal dimensions or location of property ownership lines.



**Water Right Application Map**

Carlos and Rachel Maldonado  
 Tax Lots 5 1E 22 500 and 5 1E 22 600

Pacific Hydro-Geology Inc.

2/2007

MaldonadoGWAppMap.cdr

App No G-16821