

Recd 1/22/92

AMENDED APPLICATION MAP
IN THE NAME OF RUSSELL S. or PATTI FRASER

SECTIONS 12 & 13, T. 30 S., R. 15 W., W.M.

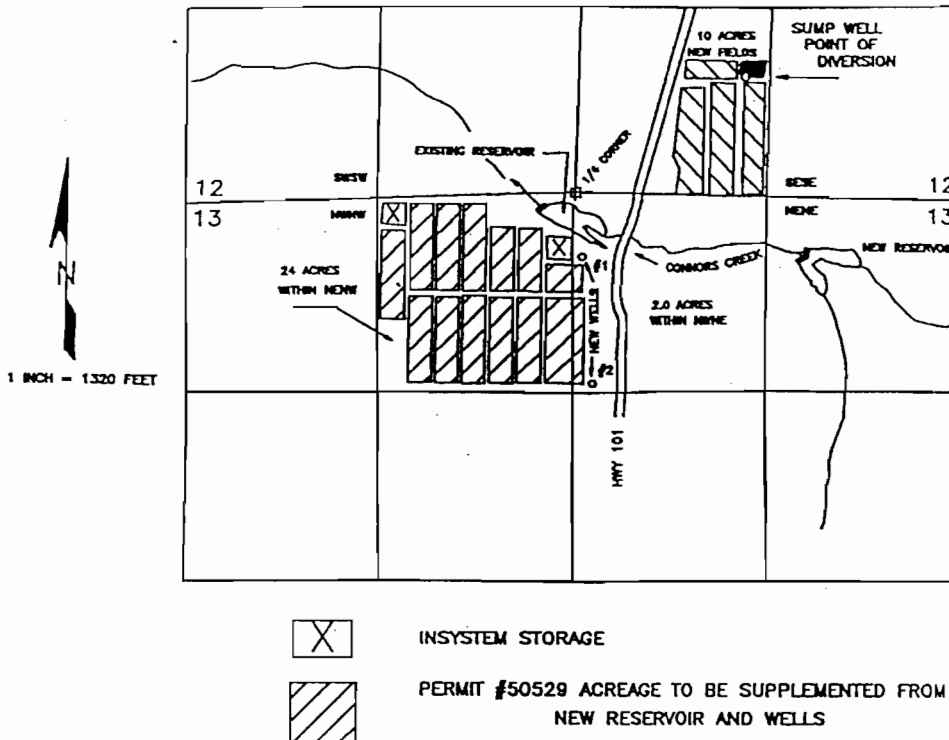

THE POINTS OF DIVERSION ARE TO BE LOCATED:

SUMP WELL:	800 FEET NORTH AND 1170 FEET EAST WITHIN THE SW $\frac{1}{4}$ SE $\frac{1}{4}$ OF SECTION 12; (SERVES ONLY THE 10 ACRES WITHIN THE SW $\frac{1}{4}$ SE $\frac{1}{4}$ OF SECTION 12)
NEW RESERVOIR:	400 FEET SOUTH AND 1600 FEET EAST WITHIN THE NE $\frac{1}{4}$ NE $\frac{1}{4}$ OF SECTION 13;
EXISTING RESERVOIR:	100 FEET SOUTH AND 230 FEET WEST WITHIN THE NE $\frac{1}{4}$ NW $\frac{1}{4}$ OF SECTION 13;
WELL No. 1:	440 FEET SOUTH AND 60 FEET EAST WITHIN THE NW $\frac{1}{4}$ NE $\frac{1}{4}$ OF SECTION 13;
WELL No. 2:	1320 FEET SOUTH AND 120 FEET EAST WITHIN THE NW $\frac{1}{4}$ NE $\frac{1}{4}$ OF SECTION 13;

ALL FROM THE NORTH $\frac{1}{4}$ CORNER OF SECTION 13, TOWNSHIP 30 SOUTH, RANGE 15 WEST, W.M., COOS COUNTY.

THE PURPOSE OF THIS MAP IS TO IDENTIFY THE LOCATION OF THE WATER RIGHT. IT IS NOT INTENDED TO PROVIDE INFORMATION RELATIVE TO THE LOCATION OF PROPERTY OWNERSHIP BOUNDARY LINES.

Certified Water Right Examiner
 #054 WRE
James F. Gosson
 James F. Gosson
 Nov. 19, 1987
 STATE OF OREGON