

WATER RIGHT APPLICATION MAP

FOR THE CITY OF GEARHART
SECTION 3, 4, 9, & 10, TOWNSHIP 6 NORTH, RANGE 10 WEST
SECTION 33 & 34, TOWNSHIP 7 NORTH, RANGE 10 WEST
CLATSOP COUNTY, OREGON
AUGUST 24, 2005

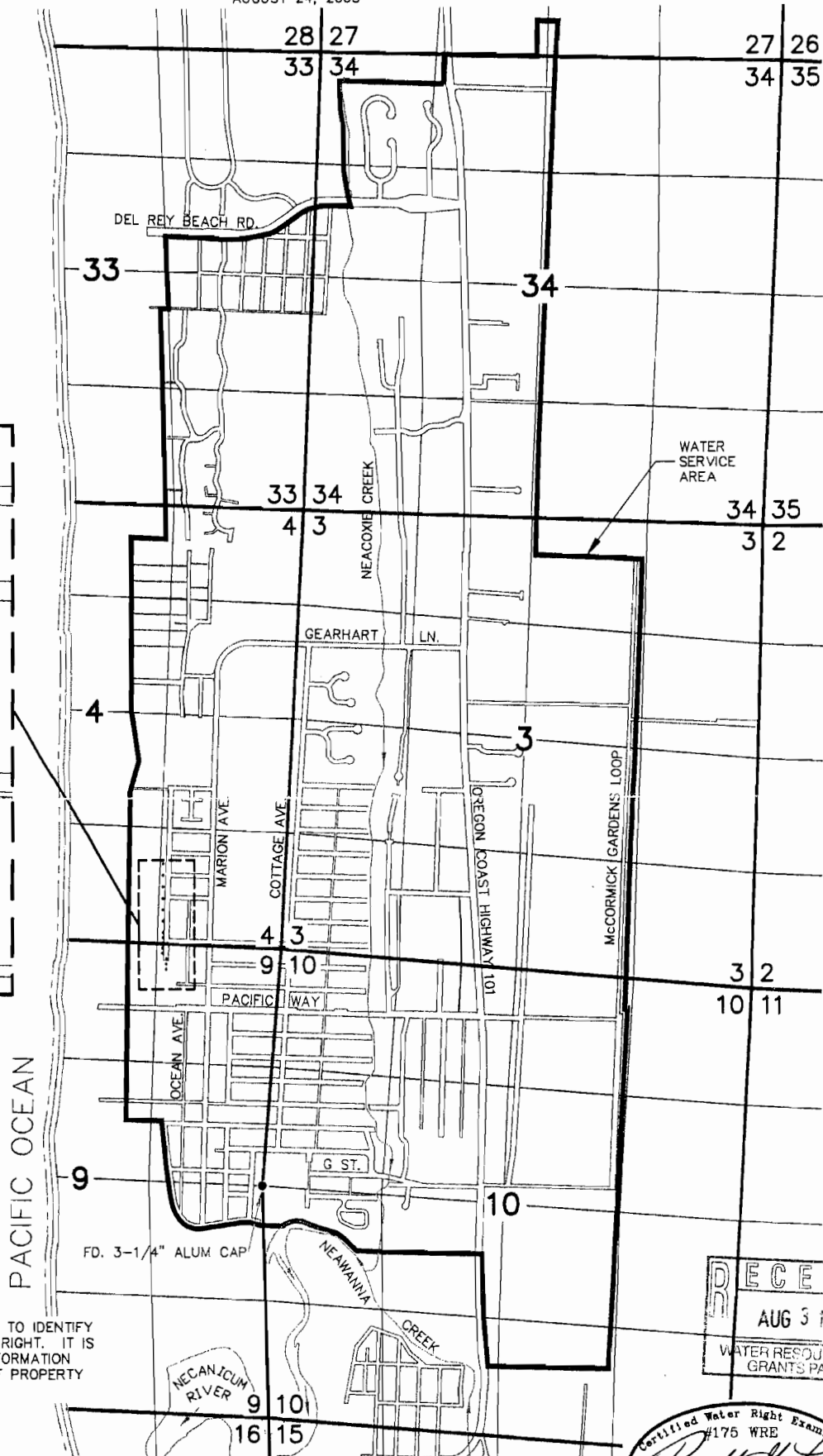

THE PURPOSE OF THIS MAP IS TO IDENTIFY THE LOCATION OF THE WATER RIGHT. IT IS NOT INTENDED TO PROVIDE INFORMATION RELATIVE TO THE LOCATION OF PROPERTY OWNERSHIP BOUNDARY LINES.

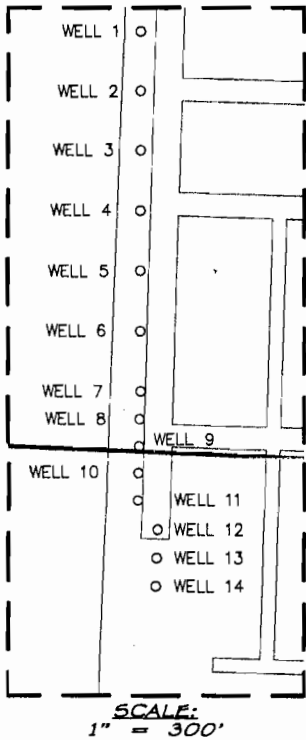
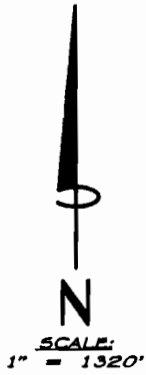
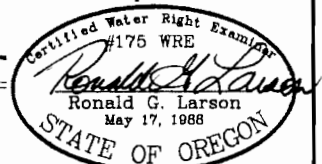
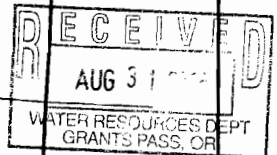

SOURCE	NORTH	WEST	¼ SECTION	SECTION
WELL 1	3658.4 FT.	1135.9 FT.	SE ¼ SE ¼	4
WELL 2	3528.4 FT.	1135.9 FT.	SE ¼ SE ¼	4
WELL 3	3398.4 FT.	1135.9 FT.	SE ¼ SE ¼	4
WELL 4	3268.4 FT.	1135.9 FT.	SE ¼ SE ¼	4
WELL 5	3138.4 FT.	1135.9 FT.	SE ¼ SE ¼	4
WELL 6	3008.4 FT.	1135.9 FT.	SE ¼ SE ¼	4
WELL 7	2878.4 FT.	1135.9 FT.	SE ¼ SE ¼	4
WELL 8	2818.5 FT.	1135.9 FT.	SE ¼ SE ¼	4
WELL 9	2758.5 FT.	1135.9 FT.	SE ¼ SE ¼	4
WELL 10	2698.5 FT.	1135.9 FT.	NE ¼ NE ¼	9
WELL 11	2638.5 FT.	1135.9 FT.	NE ¼ NE ¼	9
WELL 12	2577.3 FT.	1096.0 FT.	NE ¼ NE ¼	9
WELL 13	2517.2 FT.	1096.0 FT.	NE ¼ NE ¼	9
WELL 14	2457.3 FT.	1096.0 FT.	NE ¼ NE ¼	9

*COORDINATES FROM 1/4 CORNER COMMON TO SECTIONS 9 & 10

G04-0239-01-05.0WG

RENEWAL DATE: DECEMBER 31, 2006

HLB & Associates
INCORPORATED
Surveying • Civil Engineering • Planning • Water Rights • Wetlands Consulting

CLATSOP COUNTY 4253-A HWY 101 N. GEARHART, OR 97138 (503) 738-3425 FAX: (503) 738-7455	PACIFIC COUNTY 1715-B N. PACIFIC AVE. LONG BEACH, WA 98631 (360) 642-4454 FAX: (360) 642-4054	TILLAMOOK COUNTY 180 LANEDA AVE. MANZANITA, OR 97130 (503) 368-5394 FAX: (503) 368-5847
--	---	---

WWW.HLBINC.COM