

# T.3S. R.1W. Sec. 32 & 33, W.M.

RECEIVED

JUN 29 2007

WATER RESOURCES DEPT  
SALEM, OREGON

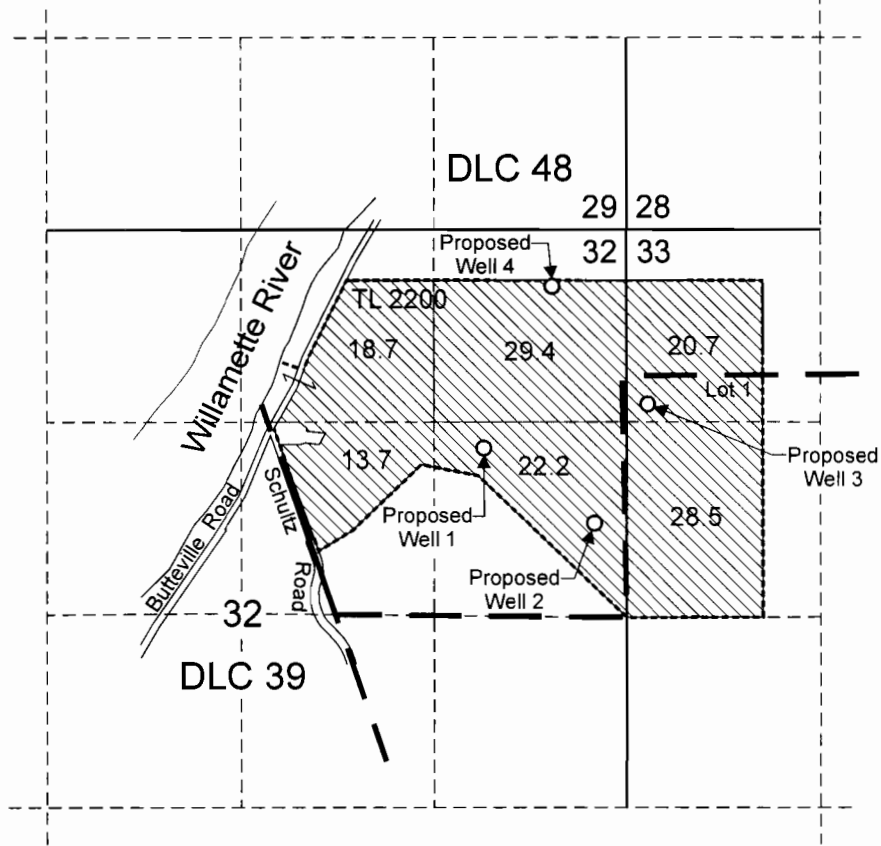

Proposed Well 1 is located 1,500 feet south and 970 feet west from the NE corner of Section 32.  
 Proposed Well 2 is located 2,020 feet south and 220 feet west from the NE corner of Section 32.  
 Proposed Well 3 is located 1,200 feet south and 150 feet east from the NW corner of Section 33.  
 Proposed Well 4 is located 390 feet south and 510 feet west from the NE corner of Section 32.

 Area (133.2 Acres) to be irrigated.

 Tax lot boundary

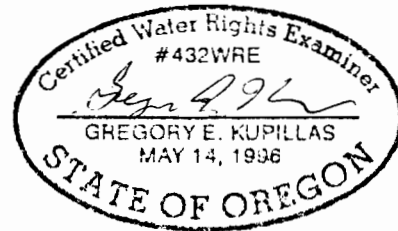

EXPIRATION DATE: 6/30/09

Scale: 1" = 1,320'



This map was prepared for the purpose of identifying the location of a water right only and is not intended to provide legal dimensions or location of property ownership lines.



## Water Right Application Map

Pacific Foods of Oregon, Inc.  
Tax Lot 3 1W 32A 2200

Pacific Hydro-Geology Inc.

6/2007

PacFoodsSistersGWAppMap1.cdr

App No G-16890