

SECTION PLAT

Map 1 of 2

25 ~ 36
Section 30-31-32

20-5
Township 20-5

35-E
Range 36-E

County of HARNEY State of OR

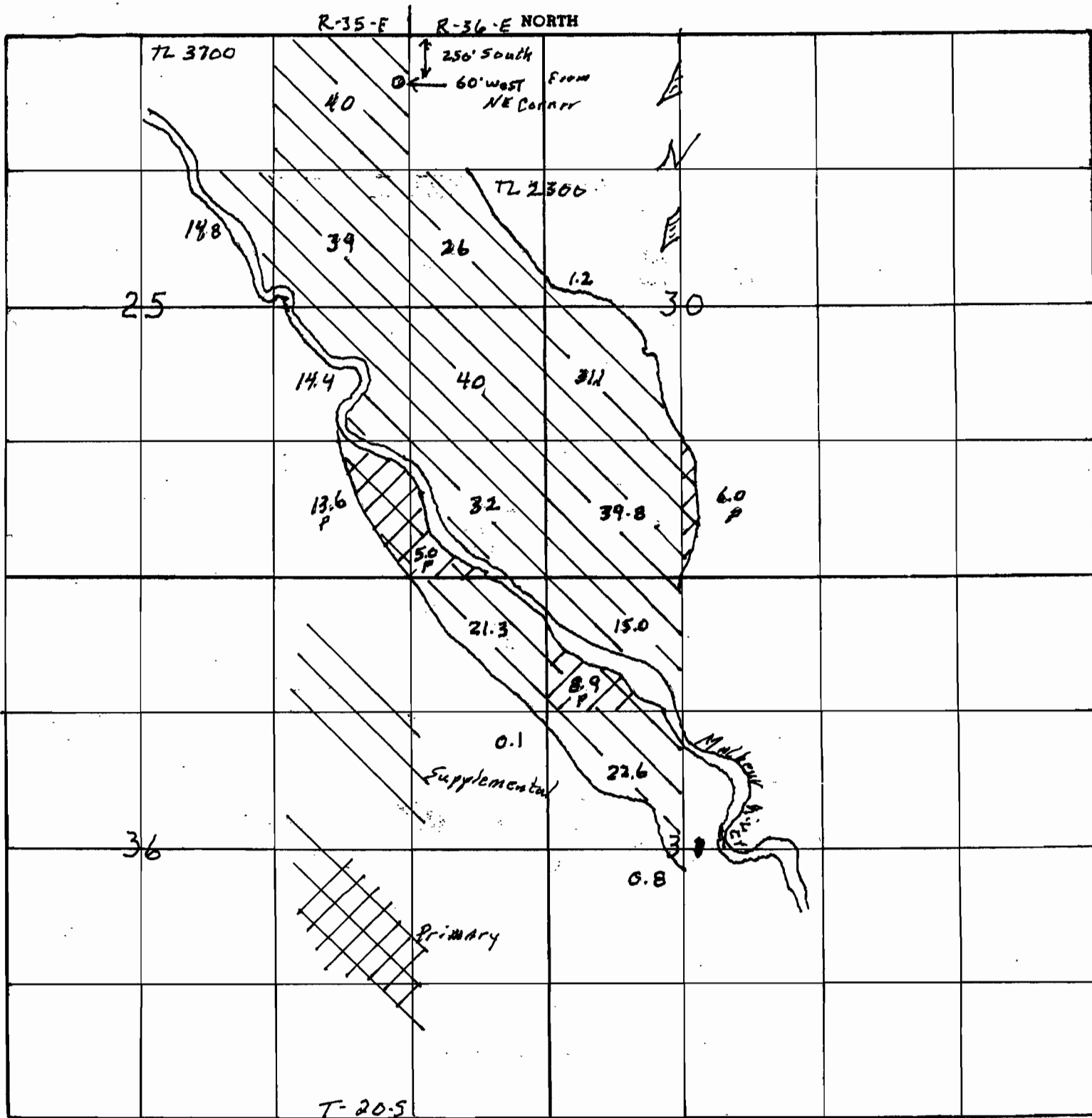

Remarks scale - 8" = 1 mile - 660' -

RECEIVED

MAY 01 2008

WATER RESOURCES DEPT
SALEM, OREGON

App No G-17048

SECTION PLAT

Section 31-32 Township 20-5 Range 36-E
Section 5-6 Township 21-5 Range 36-E

County of Harney State of OR

NORTH

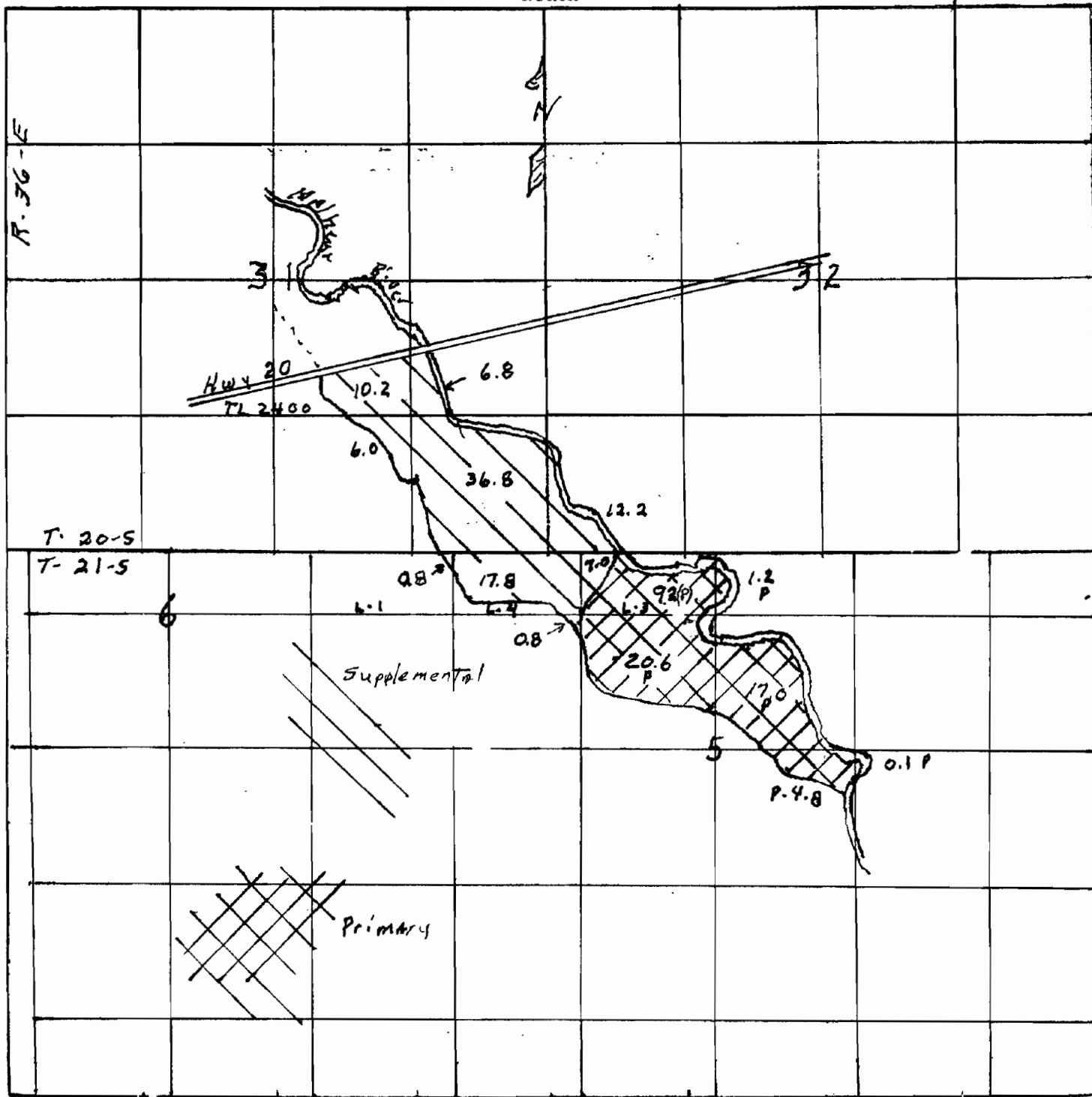

Remarks scale - 8" = 1 mile - 660' -

RECEIVED

MAY 01 2008

WATER RESOURCES DEPT
SALEM, OREGON

App No G-17048