

G:\1000\1043\101\Cad\Water\W1043101_F2_WRM 10:47 12/13/2006 SS

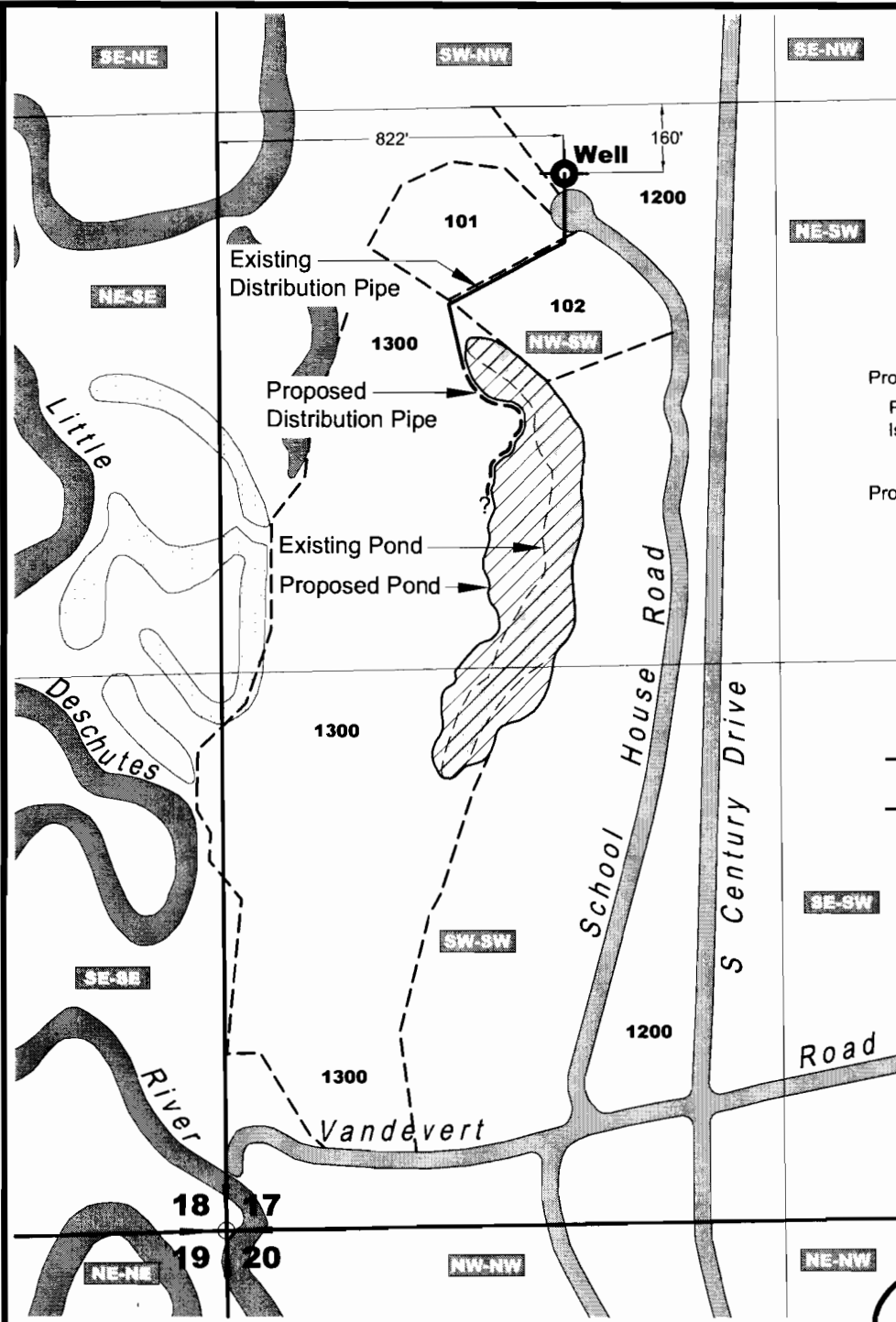

NOTE

THIS MAP WAS PREPARED FOR THE PURPOSE OF IDENTIFYING THE LOCATION OF WATER RIGHTS ONLY AND IS NOT INTENDED TO PROVIDE LEGAL DIMENSIONS OR LOCATIONS OF PROPERTY OWNERSHIP LINES.

Proposed Pond Surface area		
Pond	184,086 SQ.FT.	4.23 Ac
Island	1,730 SQ.FT.	0.04 Ac
	<u>182,356 SQ.FT.</u>	<u>4.19 Ac</u>
Proposed Pond Volume		
	24.6 Acre-Feet	

LEGEND

Place of Proposed Water Use

Location	Pond Surface Area
Section 17 NW-SW	3.18 Ac
Section 17 SW-SW	1.01 Ac
	<u>4.19 Ac</u>



WATER RIGHT MAP

Located in Township 20S, Range 11E, W.M.
Sections 17
Deschutes County, Oregon

RECEIVED

DEC 26 2006

WATER RESOURCES DEPT
SALEM, OREGON

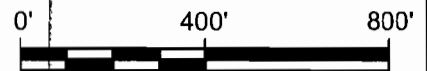

SCALE: 1" = 400'

NEWTON
CONSULTANTS INC.

Earth, Water and Rock Specialists
1-541-344-7000 Fax: 541-524-9511

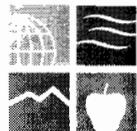

Water Rights Map
Rainbow Reservoir - Vandeventer Ranch
Deschutes County, Oregon

DESIGNED BY:
D. Newton

DRAWN BY:
S. Schenck

DATE:
Nov 2006

PROJECT NO.
1043-101

FIGURE 2

app no G-16769