

617158

# T.3S. R.1E. Sec. 23 & 26

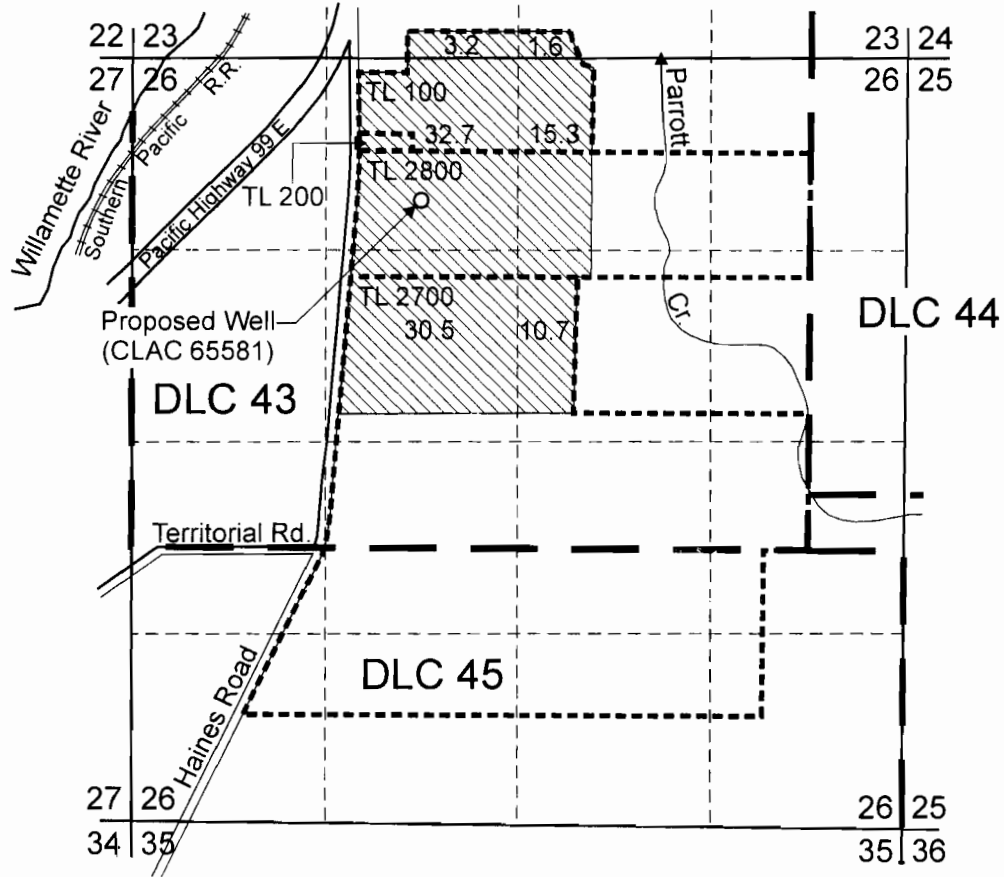

Proposed Well (CLAC 65581) is located 2,410 feet north and 2,650 feet west from the SE Corner of DLC 43.

Area (94.0 Acres) proposed for nursery operations.

Tax Lot Boundary

**RECEIVED**

DEC 31 2008

WATER RESOURCES DEPT  
SALE OF OREGON



EXPIRATION DATE: 6/30/09

Scale: 1" = 1,320'

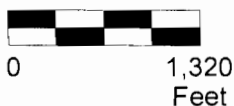

This map was prepared for the purpose of identifying the location of a water right only and is not intended to provide legal dimensions or location of property ownership lines.



## Water Right Application Map

Rich and Nancy Birkemeier  
T.3S. R.1W. Sec. 23 and 26

Pacific Hydro-Geology Inc.

12/2008