

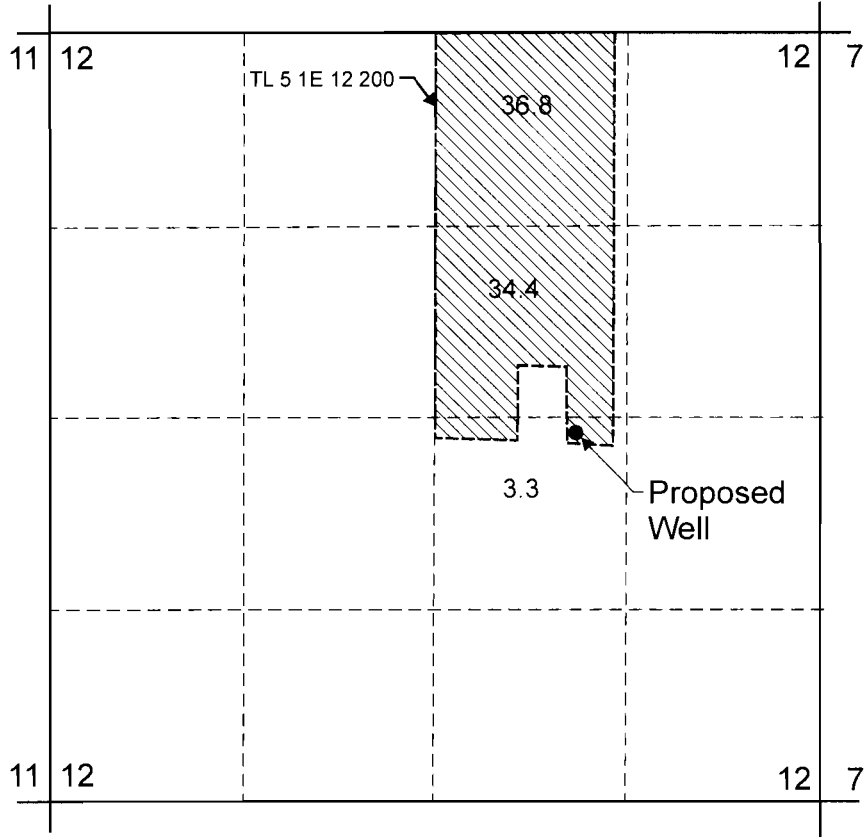

G17162

# T.5S. R.1E. Sec. 12, W.M.



Proposed Well is located 2,750 feet south and 1660 feet west from the NE corner of Section 12.

 Area (74.5 Acres) to be irrigated.

----- Tax lot boundary



**RECEIVED**  
 JAN 12 2009  
 WATER RESOURCES DEPT  
 SALEM, OREGON

EXPIRATION DATE 6/30/09

Scale: 1" = 1,320'



This map was prepared for the purpose of identifying the location of a water right only and is not intended to provide legal dimensions or location of property ownership lines.



## Water Right Application Map

Dickman Land, LLC  
T.5S. R.1E. Sec. 12, W.M.

Pacific Hydro-Geology Inc.

1/2008