

G-17178

MAP TO ACCOMPANY GROUND WATER APPLICATION

SITUATED IN THE W1/2 OF SECTION 13, T40S,
R9EWM, KLAMATH COUNTY, OREGON
FEBRUARY, 2009

MAP PREPARED FOR
--GREAT WESTERN, LLC--

RECEIVED

FEB 05 2009

WATER RESOURCES DEPT
SALEM, OREGON

MAP PREPARED FROM
--ASSESSORS MAP--

TAX LOTS
40 09 13 - 300

WELL LOCATION
200 FEET NORTH AND 1900 FEET EAST OF
THE SOUTHWEST CORNER OF SECTION 13

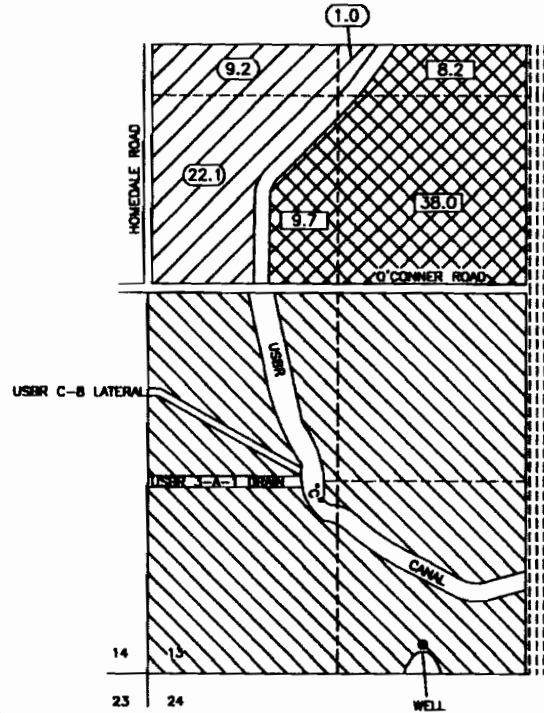

NEW LANDS SUPPLEMENTAL TO
KLAMATH IRRIGATION DISTRICT --55.9--



NEW LANDS SUPPLEMENTAL TO
KLAMATH BASIN IMPROVEMENT
DISTRICT --32.3--



LANDS SUPPLEMENTAL TO PERMIT #
G-15224 AND G-16209

TOTAL AREA THIS
APPLICATION
--88.2 AC--



SCALE
1" = 1320'

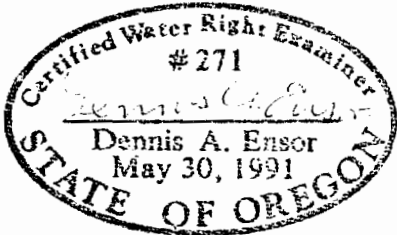

WATER RESOURCES DEPT
SALEM, OREGON

FEB 11 2009

RECEIVED

THE PURPOSE OF THIS MAP IS TO IDENTIFY THE
LOCATION OF THE WATER RIGHT APPLICATION. IT IS
NOT INTENDED TO PROVIDE INFORMATION RELATIVE
TO THE LOCATION OF PROPERTY OWNERSHIP
BOUNDARY LINES.

TRU SURVEYING INC. LINE
2333 SUMMERS LANE
KLAMATH FALLS, OREGON 97603