

12/24/09 Permit Map

T4S, R2W WM

MARION COUNTY

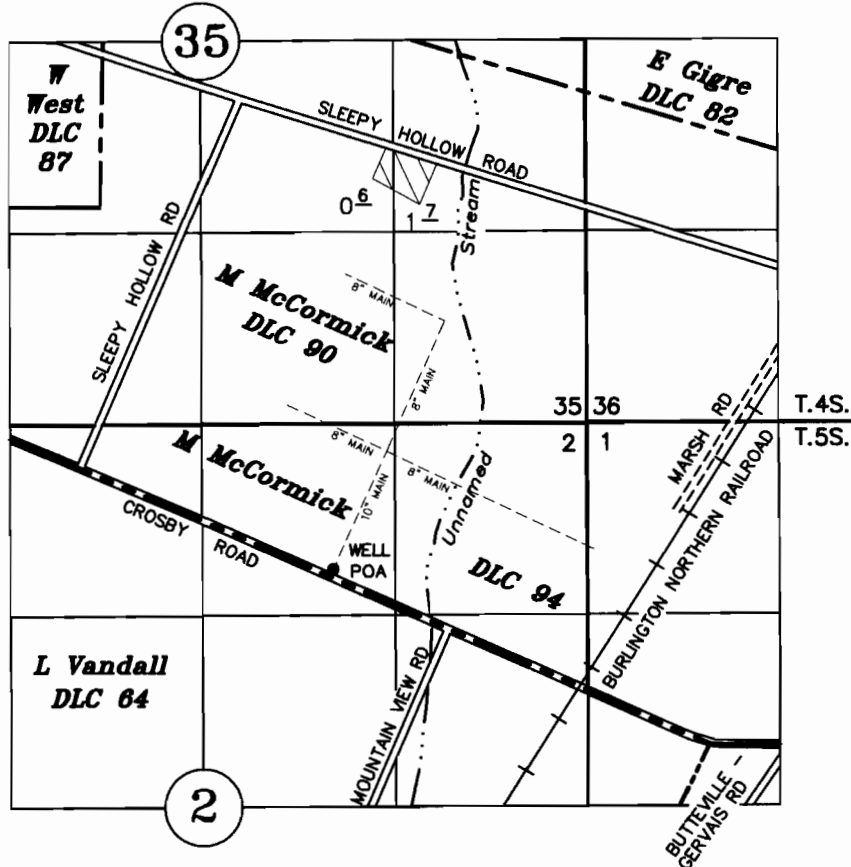

TAX LOT:
4 2W 35D 01100

POA: 1190' NORTH AND 2585' WEST OF NE COR. L. VANDALL DLC NO. 64

APPLICATION TO APPROPRIATE GROUND WATER

Application No. G - 15930 Permit No. _____

RECEIVED

NOV 17 2009

WATER RESOURCES DEPT
SALEM, OREGON

A & R SPADA FARMS

NOVEMBER 19, 2002
rev November 13, 2009

SCALE 1" = 1320'

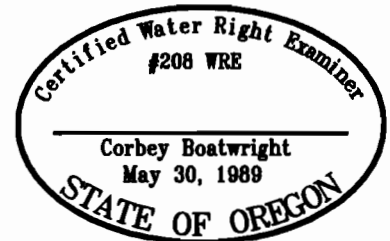

NOTE: This map is for the purpose of identifying the location of water rights and has no intent to dimension or locate property ownership lines.

EXPIRES 12-31-09