

SITE MAP

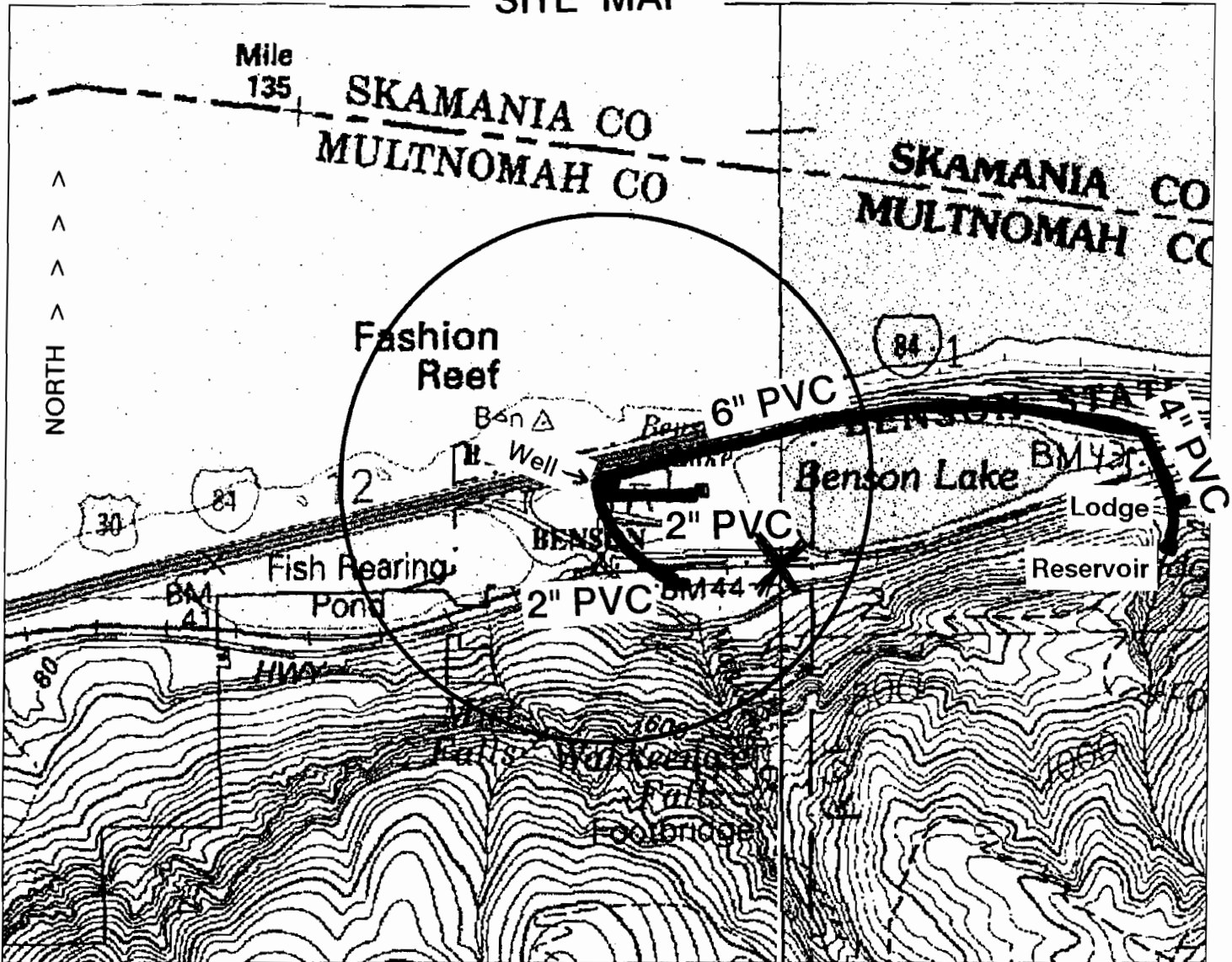

WELL T.1N, R.5E, Sec. 12 SE 1/4 SE 1/4

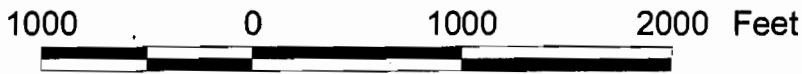

1:12,000

600' NORTH AND 1230' WEST FROM SE CORNER SEC 12

X = SE 1/4 corner

Prepared by: K. Kelley  
 Reviewed by: D. Nelson  
 Date: 6/21/2000  
 File #: 4192612  
 Radius: 1500'

USGS Bridal Veil, OR Quadrangle  
 USGS Multnomah Falls, OR Quadrangle  
 (Part Section) 7.5 Series Topographic

GPS Well Data:  
 45°34'40.6425  
 122°7'43.8257  
 GPS Elevation Data: 64.042'

RECEIVED  
 OVER THE COUNTER

MAY 02 2007

WATER RESOURCES DEPT  
 SALEM, OREGON