

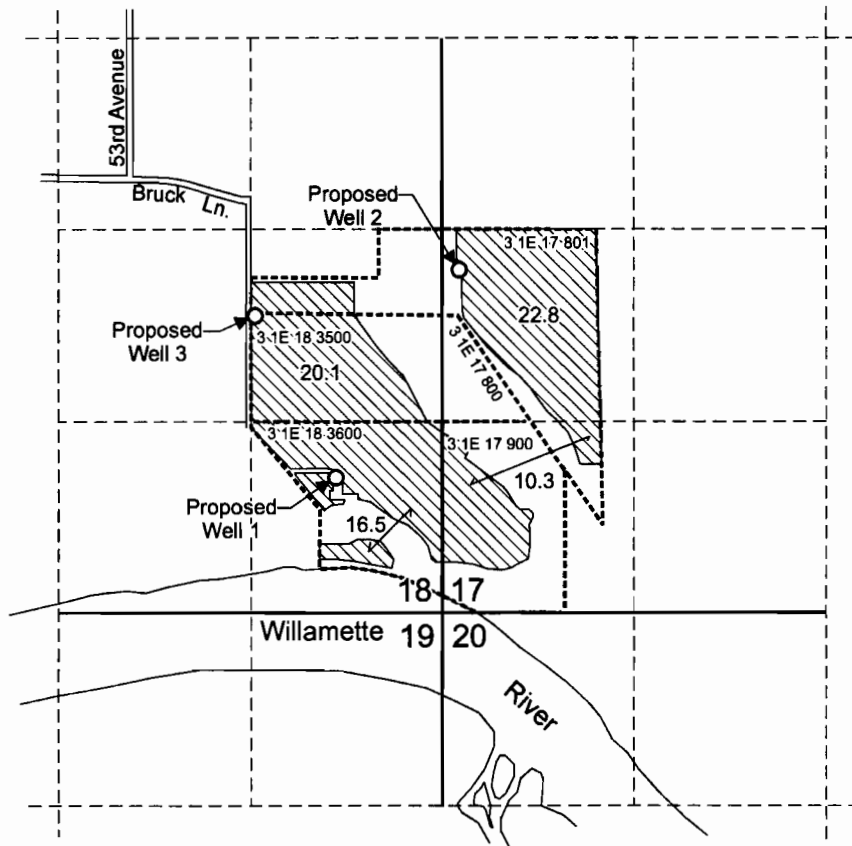

T.3S. R.1E. Sec. 17 & 18, W.M.



Proposed Well 1 is located 1,700 feet south and 730 feet west from the E1/4 corner of Section 18.
 Proposed Well 2 is located 280 feet south and 120 feet east from the W1/4 corner of Section 17.
 Proposed Well 3 is located 590 feet south and 1,290 feet west from the E1/4 corner of Section 18.

 Area (69.7 Acres) to be irrigated.
 ----- Tax lot boundary

RECEIVED

JUN 03 2009

WATER RESOURCES DEPT
SALEM, OREGON

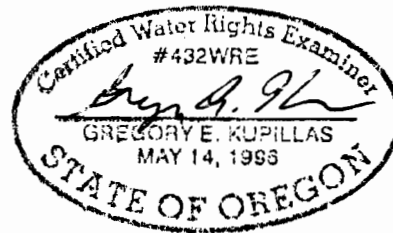

EXPIRATION DATE: 6/30/09

Scale: 1" = 1,320'



This map was prepared for the purpose of identifying the location of a water right only and is not intended to provide legal dimensions or location of property ownership lines.



Water Right Application Map

Vernon Bruck
T.3S. R.1E. Sec. 17 & 18

Pacific Hydro-Geology Inc.

5/2009