

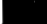

Irrigated field

SCALE @ APPROX
1" = 1320 FT.

-  Misc. Transportation
-  Railroads
-  Roads and Trails
-  Waterways

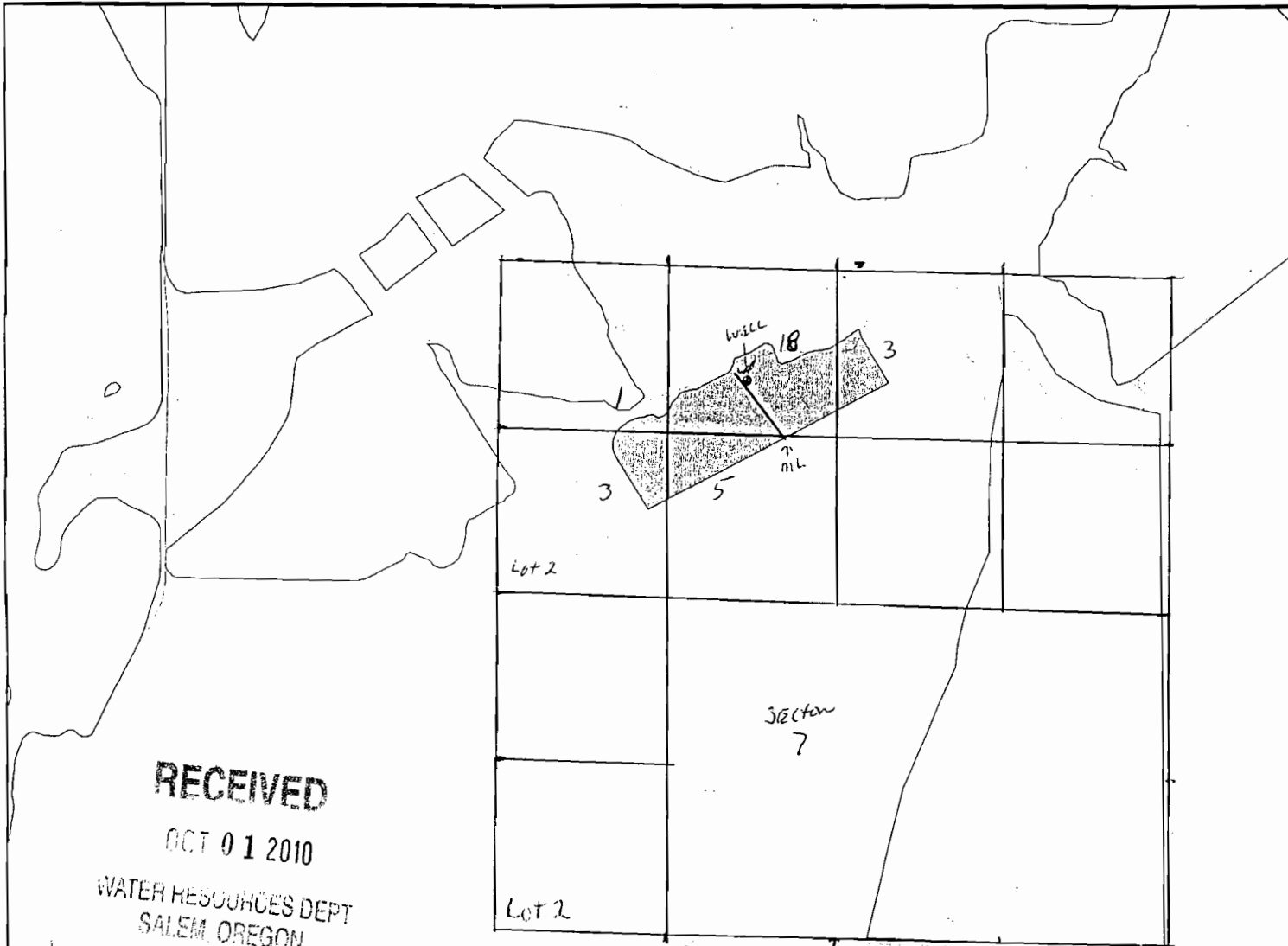

WELL LOCATION
 045° 29' 56.046 N
 118° 59' 23.423 W
 NO. L46663 ABANDON *g/bolo*
 LEGAL DESCRIPTION
 NW 1/4 SECTION 7
 NW 1/4 OF NW 1/4 SECTION 7

RECEIVED

DEC 31 2009

WATER RESOURCES DEPT
SALEM, OREGON

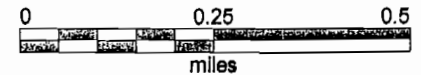

RECEIVED

OCT 01 2010

WATER RESOURCES DEPT
SALEM, OREGON

WELL LOCATED FROM
NW CORNER SECTION 7

1940 FT EAST

~~890 FT SOUTH~~

880 FT SOUTH NEW WELL L100149

15 31 E

TAX Lot 1000

G-17296

Alga

G-17296

