

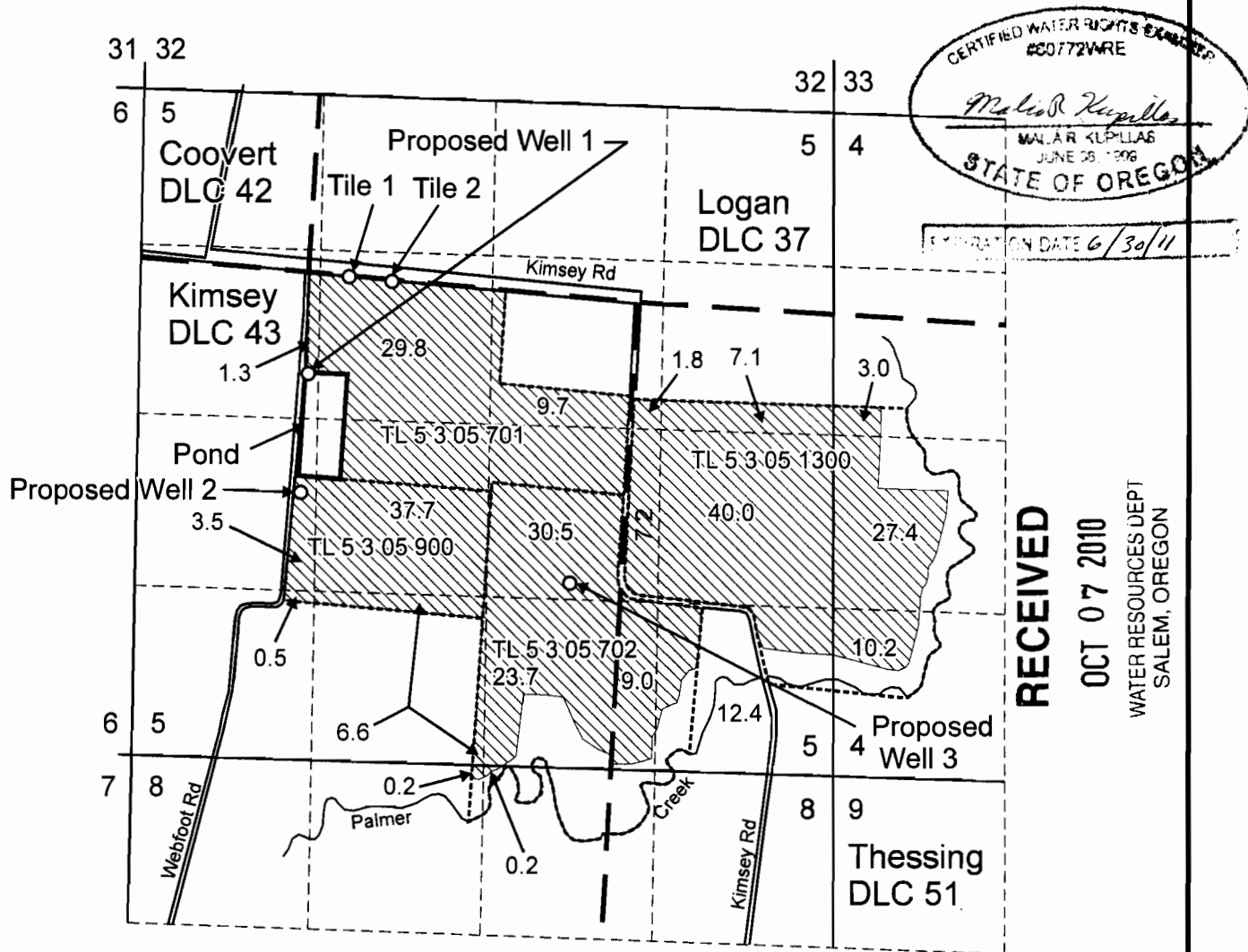



T.5S. R.3W. Sec. 4, 5, and 8, W.M.



Proposed Well 1 is located 780 feet south and 0 feet west from the SE corner of DLC 42.
 Proposed Well 2 is located 1,690 feet south and 60 feet west from the SE corner of DLC 42.
 Proposed Well 3 is located 2,380 feet south and 2,009 feet east from the SE corner of DLC 42.

Proposed Tile 1 is located 40 feet south and 310 feet east from the SE corner of DLC 42.
 Proposed Tile 2 is located 70 feet south and 640 feet east from the SE corner of DLC 42.

-  Area (261.8 Acres) to be irrigated.
-  DLC boundary
-  Tax lot boundary

Note: The quarter quarter lines have been projected using a tax map, government land survey maps, an aerial photograph, and best professional judgement.

Scale: 1" = 1,320'

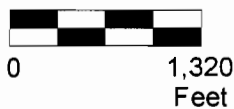

This map was prepared for the purpose of identifying the location of a water right only and is not intended to provide legal dimensions or location of property ownership lines.



Pacific Hydro-Geology Inc.

10/2010

Revised Water Right Application Map
 Ground Water Right
 Carlton Nursery Co., LLC.
 Gordon/Ediger/Webfoot
 T.5S. R.3W. Sec. 4, 5, and 8, W.M.