

SECTION PLAT

Section 9 Township 24-5 Range 30-E

County of Harney State of OR

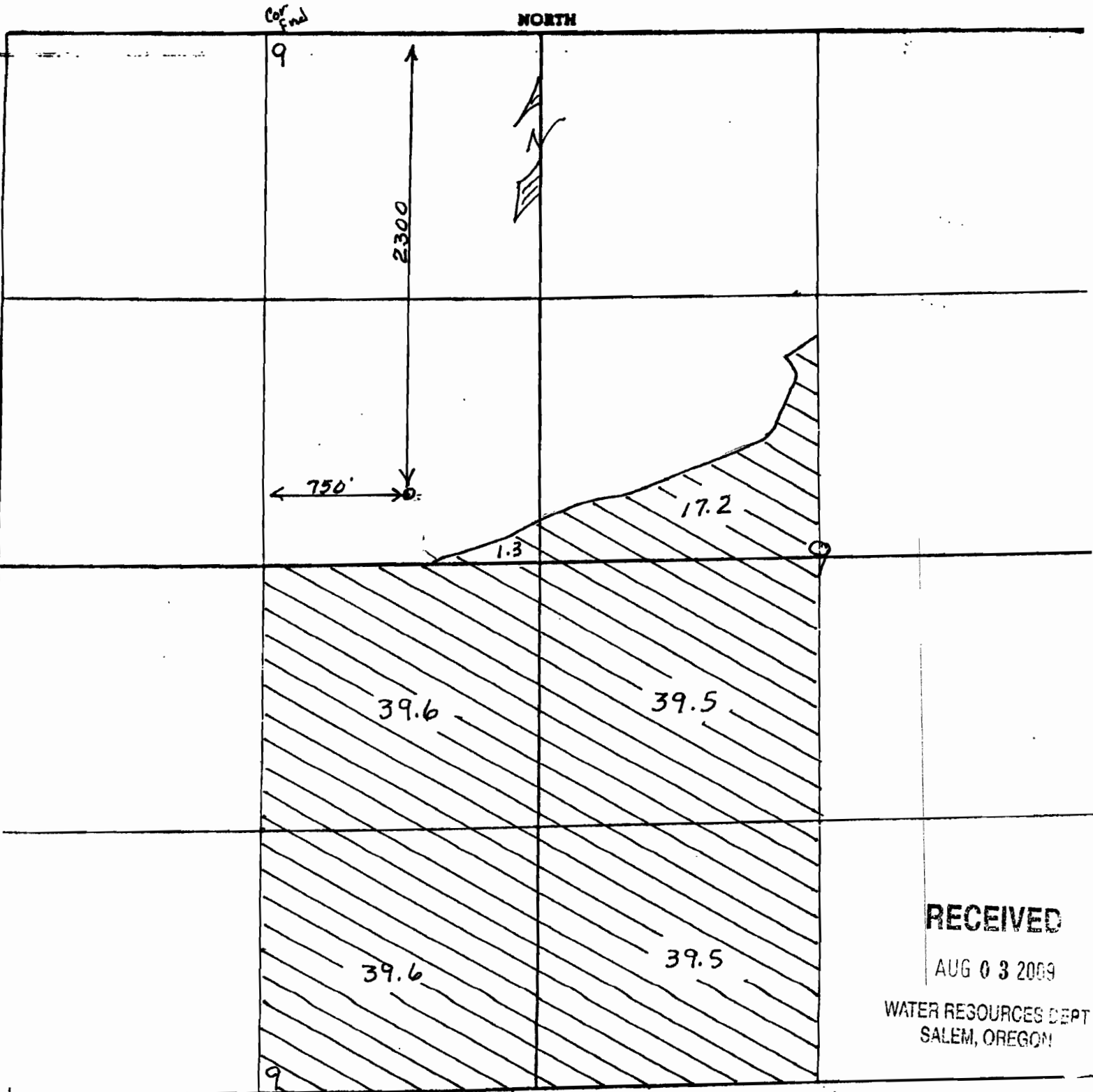

RECEIVED

AUG 03 2009

WATER RESOURCES DEPT
SALEM, OREGON

8" = 1 mile
1" = 660'

SECTION PLAT

Section 9 Township 24-S Range 30-E

County of Harney State of OR

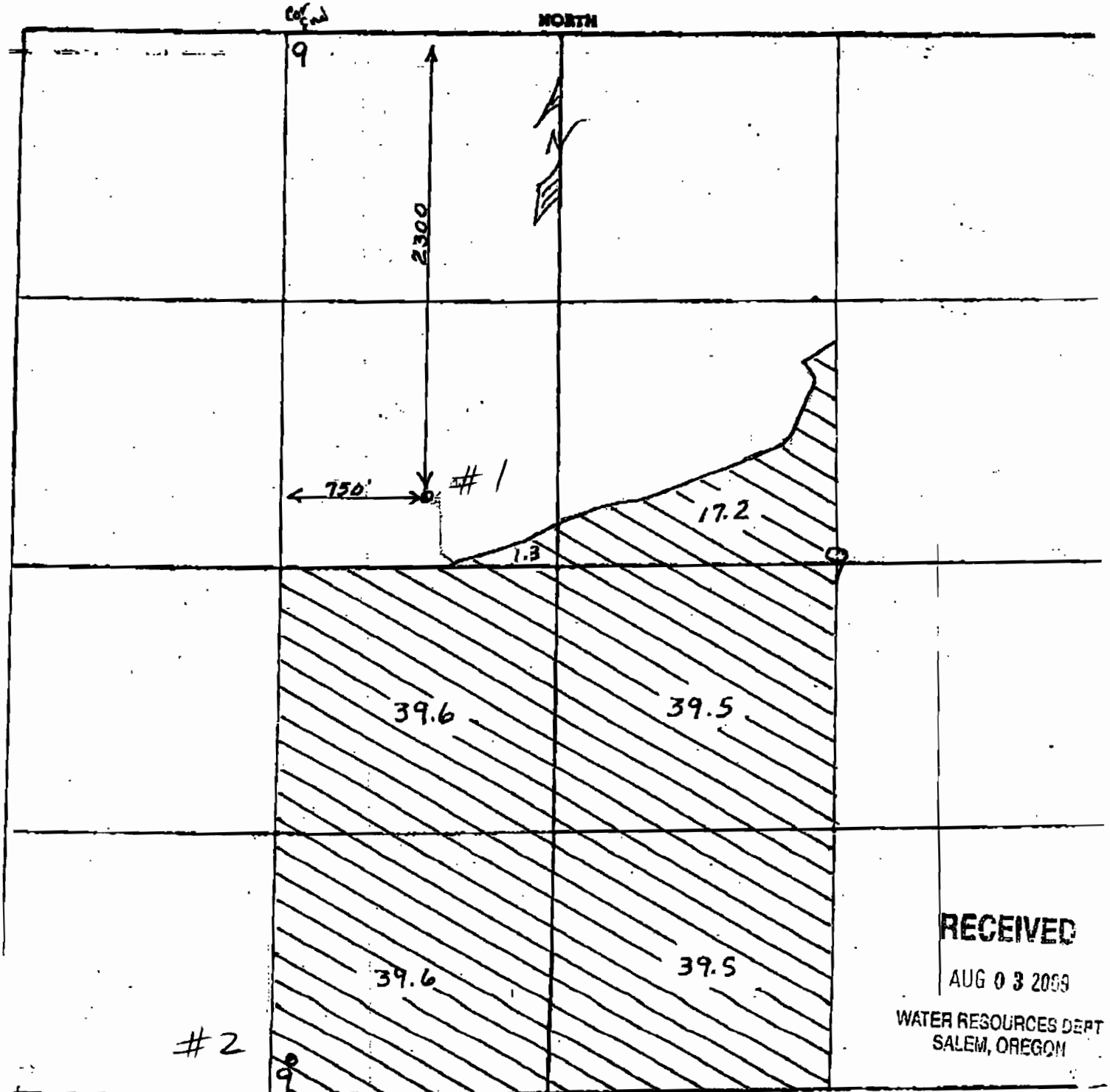

8" = 1 mile
1" = 660'

← well is 150^{ft} North and 55^{ft} East of survey stake @ S.W. corner of property
Blocha
ACM