



T4S, R1W, WM  
MARION COUNTY

TAX LOT:  
4 1W 19A 01100  
4 1W 19A 00800

-  Nursery Operation
-  Reservoir Maintenance

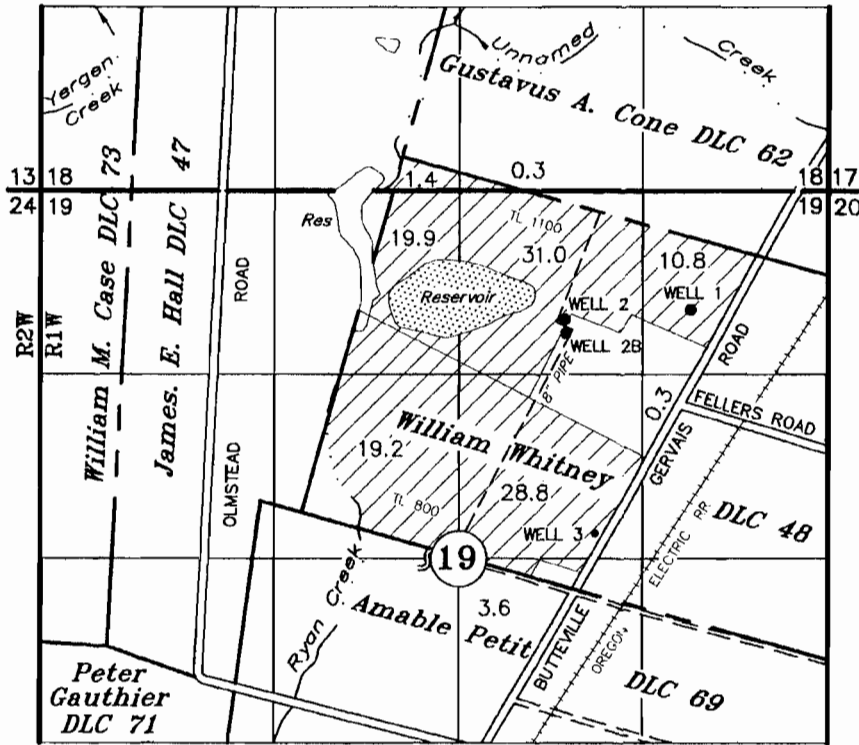

Authorized WELL 1: 1100' S & 2070' E OF THE NW COR OF WILLIAM WHITNEY DLC 48  
 Authorized WELL 2: 1170' S AND 1170' E OF THE NW COR OF WILLIAM WHITNEY DLC 48  
 Authorized WELL 3: 185' N AND 1660' W OF THE E 1/4 COR OF SECTION 19  
 Proposed WELL 2B: 1200' S & 1165' E OF NW COR WILLIAM WHITNEY DLC 48

**APPLICATION FOR A PERMIT AMENDMENT**  
Change in Point of Appropriation

UNDER

Application No. G-15826 Permit No. G-16044

**Arthur & Mary B. Spada**

**Feller Farm, LLC**

**Feller-Nyquist Farm, LLC**

**RECEIVED**

APR 20 2012

WATER RESOURCES DEPT  
SALEM, OREGON

JUNE 21, 2010  
SCALE: 1" = 1320'

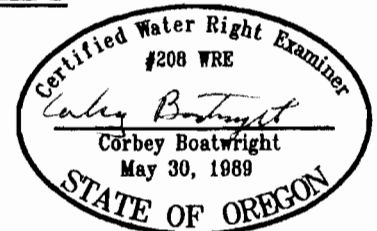

NOTE: This map is for the purpose of identifying the location of water rights and has no intent to dimension or locate property ownership lines.

Renewal Date: December 31, 2013