

T3S R2W WM

YAMHILL COUNTY

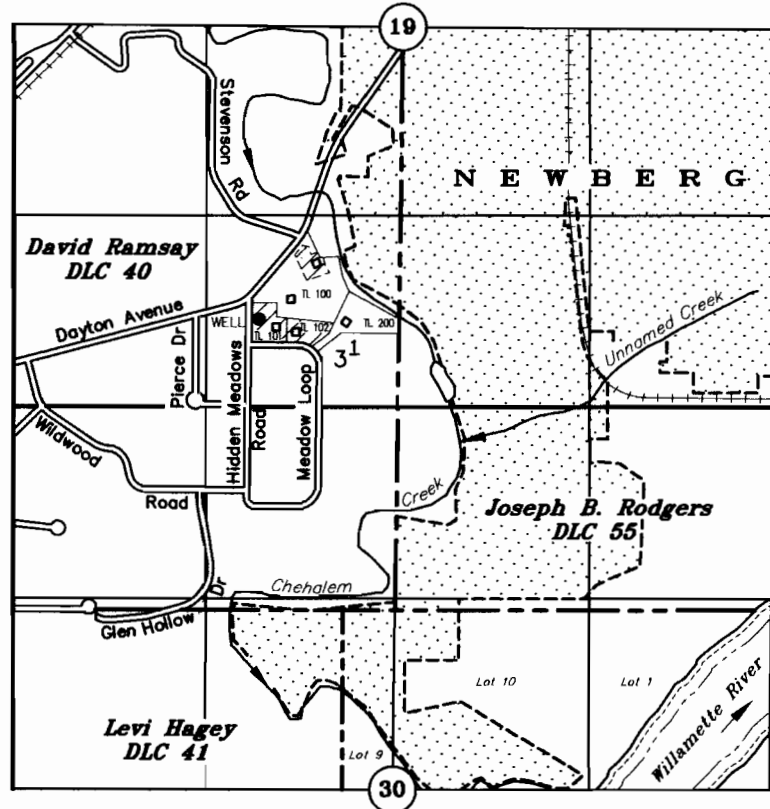

TAX LOTS:

3 2 30B 100
3 2 30B 101
3 2 30B 102
3 2 30B 200

▣ Residence (5)

▣ Irrigation

3" WATER MAIN SOUTH,
OUT OF WELL, AND WITHIN
STREET RIGHTS-OF-WAY.

WELL: 850' NORTH and 1700' EAST OF SW COR SECTION 19
(148' NORTH & 41' EAST OF SW COR LOT 1, HIDDEN MEADOWS SUBDIVISION)

APPLICATION FOR WATER RIGHT PERMIT

RECEIVED

UNDER

DEC 14 2011

Application No. _____ Permit No. _____

WATER RESOURCES DEPT.
SALEM, OREGON

IN THE NAME OF

HIDDEN MEADOWS WATER ASSOCIATION

SEPTEMBER 29, 2011

SCALE 1" = 1320'

NOTE: This map is for the purpose of
identifying the location of water rights
and has not intent to dimension or locate
property ownership lines.



EXPIRES 12-31-11

Gr17517