

**APPLICATION MAP  
MULTNOMAH COUNTY FACILITIES  
AND  
PROPERTY MANAGEMENT  
NW 1/4, NW 1/4  
SEC 5, T1S, R3E, W.M.**

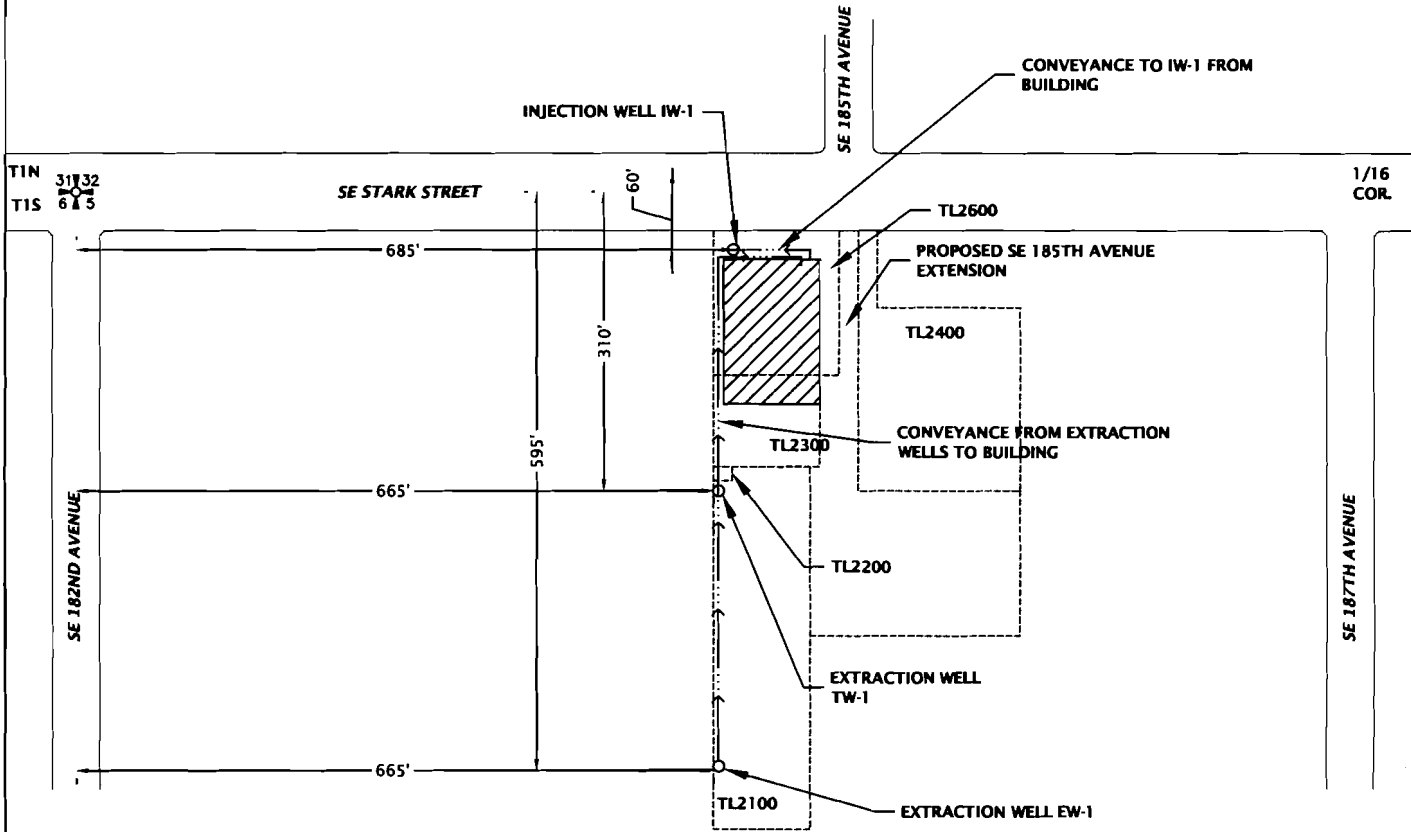

PLACE OF USE (BUILDING AIR CONDITIONING, ACREAGE NOT APPLICABLE)

APPLICATION NUMBER G-17467

PERMIT NUMBER \_\_\_\_\_

THE PURPOSE OF THIS MAP IS TO IDENTIFY THE LOCATION OF THE WATER RIGHT. IT IS NOT INTENDED TO PROVIDE INFORMATION RELATIVE TO THE LOCATION OF PROPERTY OWNERSHIP BOUNDARIES.

**RECEIVED**

JUN 3 2011

WATER RESOURCES DEPT  
SALEM, OREGON

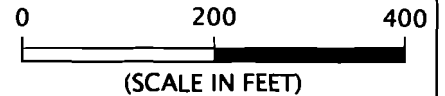
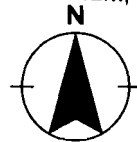

Printed By: aday | Print Date: 5/10/2011 3:15:25 PM  
File Name: J:\E-L\RS\RS-10\RS-10-02\Figures\CAD\RS-10-02-AM.dwg | Layout: FIGURE 1

**GEODESIGN** INC  
15575 SW Sequoia Parkway - Suite 100  
Portland OR 97224  
Off 503.968.8787 Fax 503.968.3068

RS-10-02

FEBRUARY 2011

**MULTNOMAH COUNTY FACILITIES AND PROPERTY  
MANAGEMENT APPLICATION MAP**

PROPOSED EAST MULTNOMAH COUNTY COURTHOUSE  
GRESHAM, OR

**FIGURE 1**