

SECTION PLAT

Section 16, 21, 22, 23

Township 23S

Range 33E

County of HARNEY

State of OREGON

● - Wells

NORTH

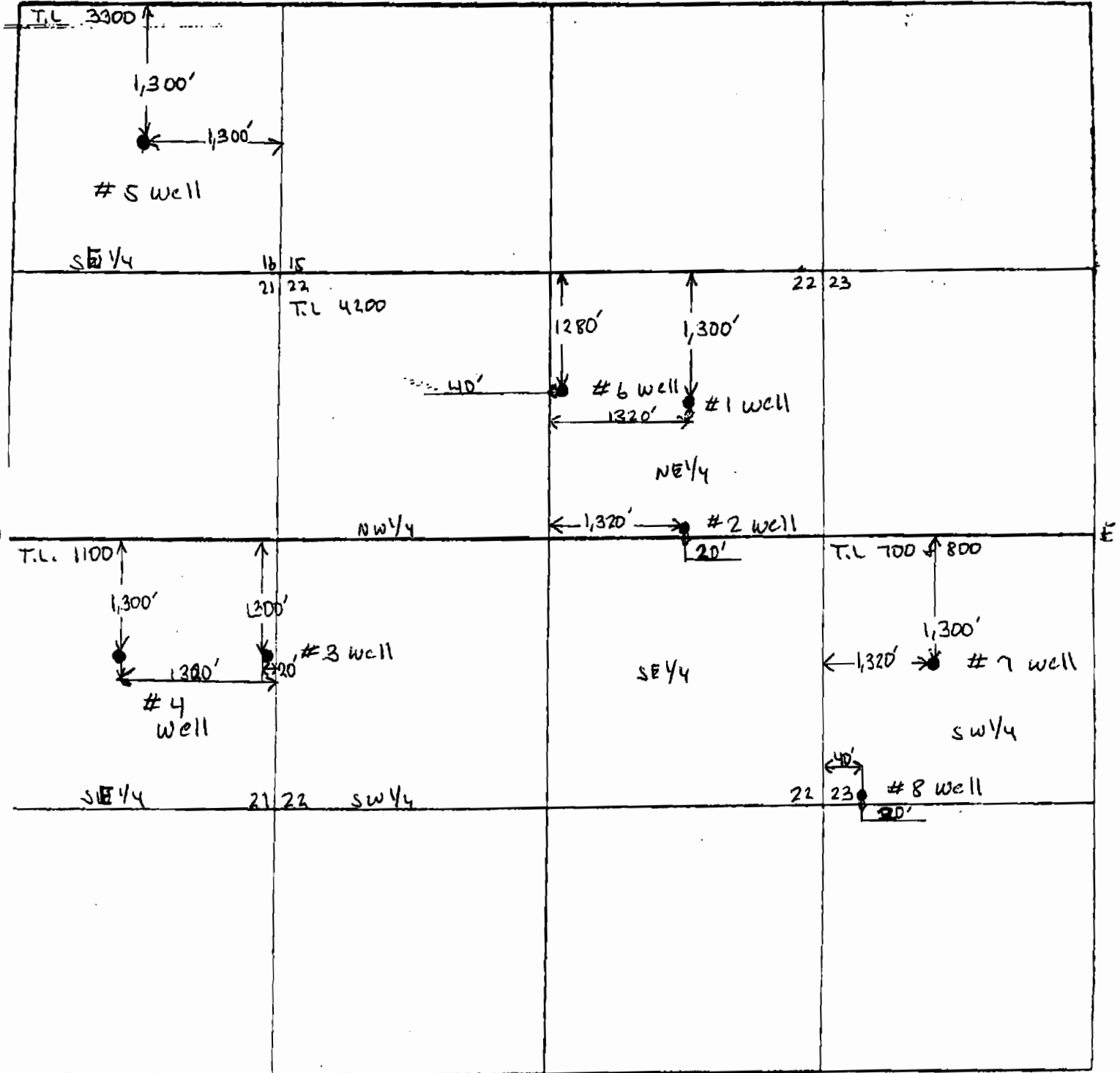

RECEIVED

AUG 06 2009

WATER RESOURCES DEPT
SALEM, OREGON

SECTION PLAT

9-17249

Section 16, 21, 22, 23

Township 23-S

Range 33-E

PAGE 1 OF 2

County of HARNEY

State of OR

Permit Amendment for Department of State Lands
NORTH

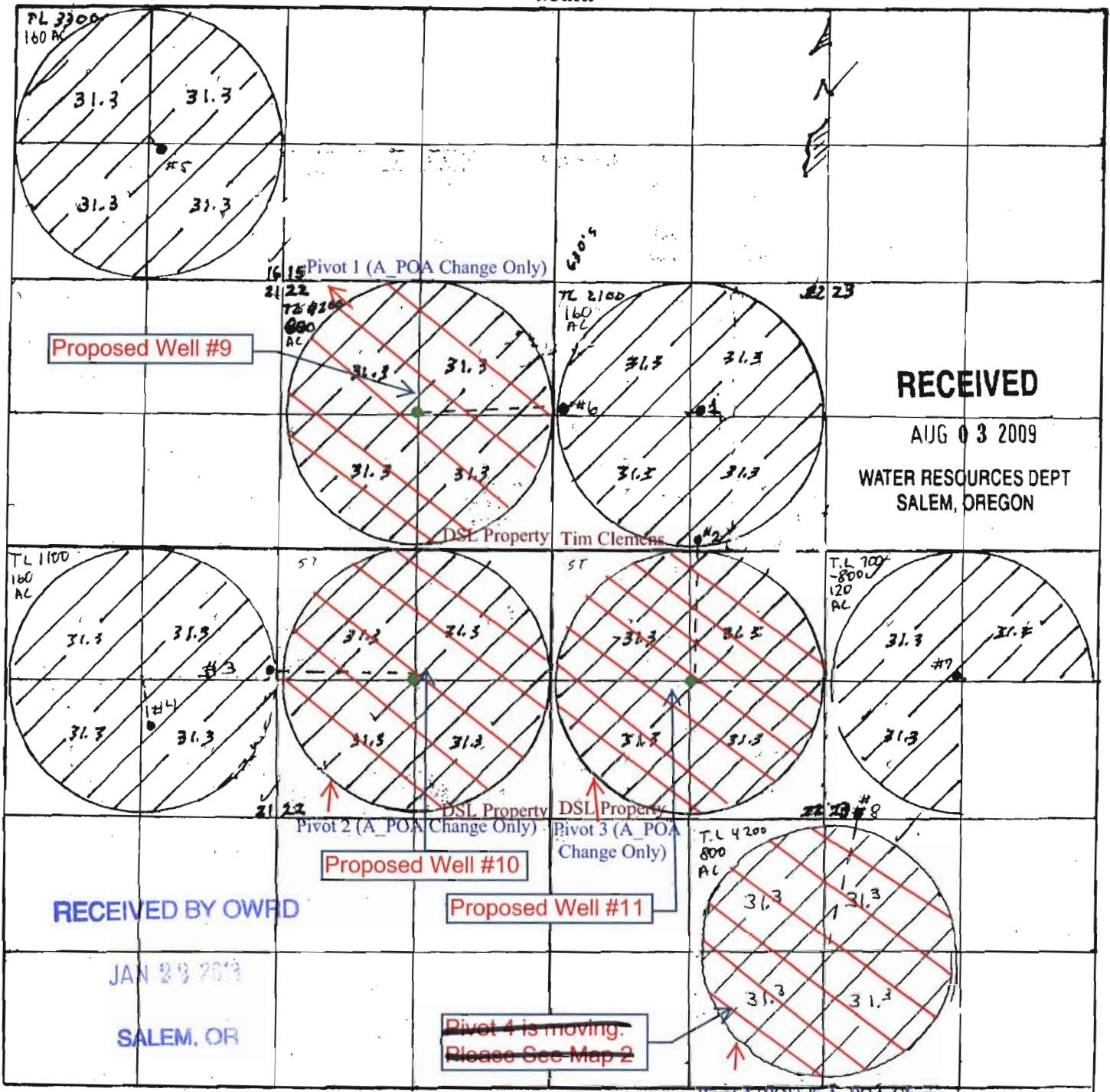

RECEIVED

AUG 03 2009

WATER RESOURCES DEPT
SALEM, OREGON

RECEIVED BY OWRD

JAN 23 2013

SALEM, OR

Proposed Well #10

Proposed Well #11

Pivot 4 is moving.
Please See Map 2

Pivot 4 (POU & A POA Change)

Remarks scale 4" = 1 mile - 660'

Lands owned by DSL are to be partially assigned to them the Remaining are to stay in Tim Clemens name.



Lands Remaining

Well Locations: Well #9: T23S R33E sec. 22 NW 1/4 center



Lands affected by Permit Amendment

Still good well #11 for APOA

Well #10: T23S R33E sec. 22 center of SW 1/4

Well #11: T23S R33E sec. 22 center of SE 1/4

Well #12: T23S R33E sec. 10 center of NW 1/4

Well #13: T23S R33E sec. 10 NW 1/4, NW 1/4

SECTION PLAT

Township 23 South Range 33 East Section 16, 21, 22, 23, 26, 27

County Harney State Oregon

north

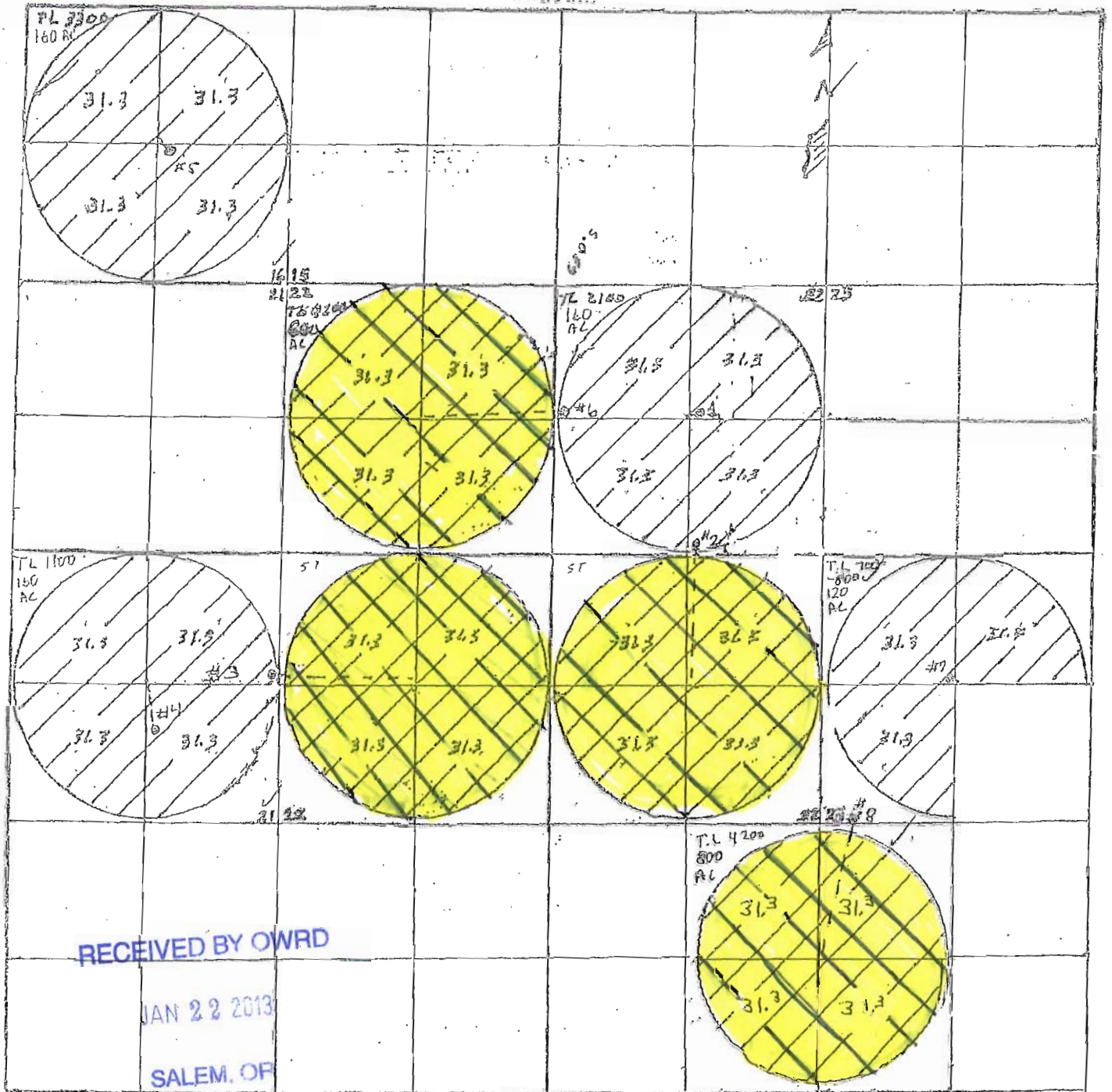

Remarks scale $\frac{1}{4}$ " = 1 mile - see) - TL 4200 (640 Acres) Leased State Lands



Permit # G-16667
portion left unchanged
Tim Clemens



portion of Permit changed
to Depart state Lands