

RECEIVED

SEP 18 2012

WATER RESOURCES DEPT  
SALEM, OREGON

# T.4S., R.2E., W.M.

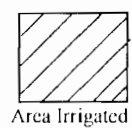
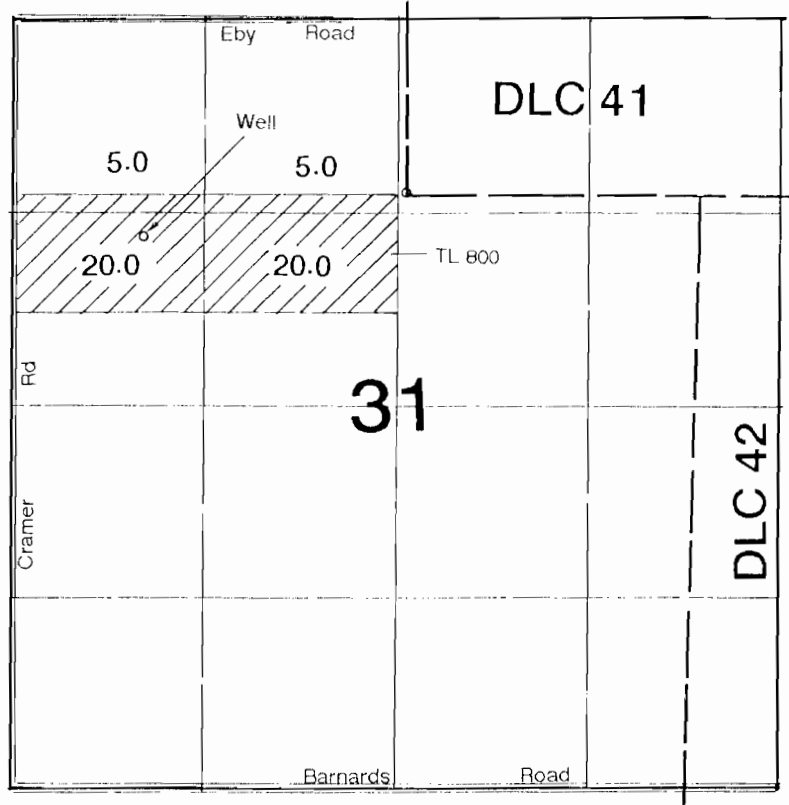

Well is located 280' S & 1770' W from the SW corner of DLC 41.

## Application Map

# Marlys Parr

Application #: G-17550

Permit #: G-

This Map was Prepared for the Purpose of Identifying the Location of a Water Right Only and is Not Intended to Provide Legal Dimensions or Location of Property Ownership Lines.

