

RECEIVED BY OWRD

NOV 14 2012

SALEM, OR



MOBILE HOME PARK

NW SHASTA AVE

Section 11
Section 12
Section 14
Section 13

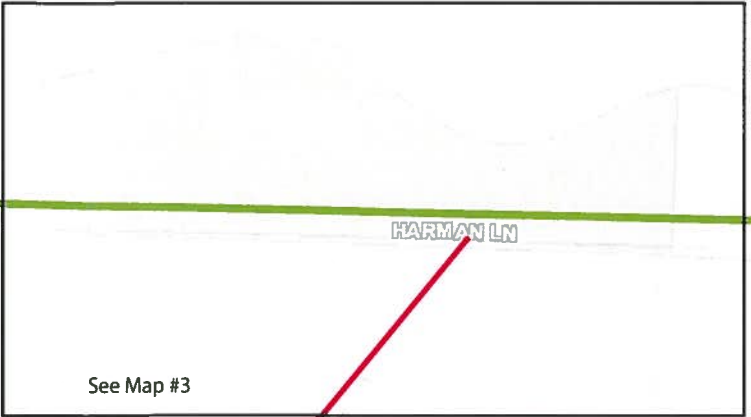

**Jackson Creek Water Association
Groundwater Permit Application Map #1**

Southeast 1/4 of Section 11 and Northeast 1/4 of Section 14,
Township 11S, Range 5W, Willamette Meridian

- Water Usage Area
- System Water Lines
- Section Line
- Quarter-quarter Line
- Survey Corner

Scale: 1" = 400'



Well # BENT3498 in tax lot 11514AC01900
located approximately 387' East and 813' South
of the Northwest corner of the Northeast quarter
of Section 14, Township 11S, range 5W,
Willamette Meridian

RECEIVED BY OWRI

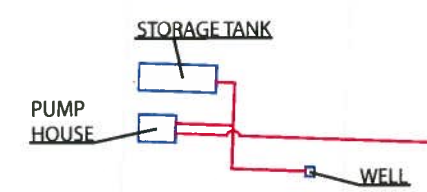

NOV 14 2012

SALEM, OR



**Jackson Creek Water Association
Groundwater Permit Application Map #2**

Northeast 1/4 of Section 14, Township 11S, Range 5W,
Willamette Meridian

-  - Water Usage Area
-  - Quarter-quarter Line
-  - System Water Lines

Scale: 1" = 100'

11514A001800

11514A001700

11514AC00100
.25 ACRE

11514AC00200
.25 ACRE

11514AC01800
1 ACRE

11514AC00300
.3 ACRE

11514AC00400
.25 ACRE

11514AC00500
.26 ACRE

11514AC00600
.26 ACRE

11514AC00700
.25 ACRE

11514AC01500
.25 ACRE

11514AC01400
.25 ACRE

11514AC01300
.25 ACRE

11514AC00800
.25 ACRE

11514AC01200
.25 ACRE

11514AC00900
.5 ACRE

11514AC01100
.28 ACRE

11514AC01000
.5 ACRE

NW HIGHLAND DR

NW JAMES AVE

NW BARBARA ST

NW BARBARA ST

NW BARBARA ST

JAMES PL

NW HIGHLAND DR

G-17596

NCV 14 2012

SALEM, OR



11514A000500
11.8 ACRES

Section 11

Section 14

HARMAN LN

**Jackson Creek Water Association
Groundwater Permit Application Map #3**

Southeast 1/4 of Section 11 and Northeast 1/4 of Section 14,
Township 11S, Range 5W, Willamette Meridian

 - Water Usage Area

 - System Water Lines

 - Section Line

Scale: 1" = 100'

Total Usage Acreage for Section 11: 9.36 ACRES

Total Usage Acreage for Section 14: 7.79 ACRES

11514A001800

11514A001700