

T.1N. R.3W. Section 15, W.M.

TL 1N315 300

Cornelius Sr.
DLC 45

10 11
15 14

0.9

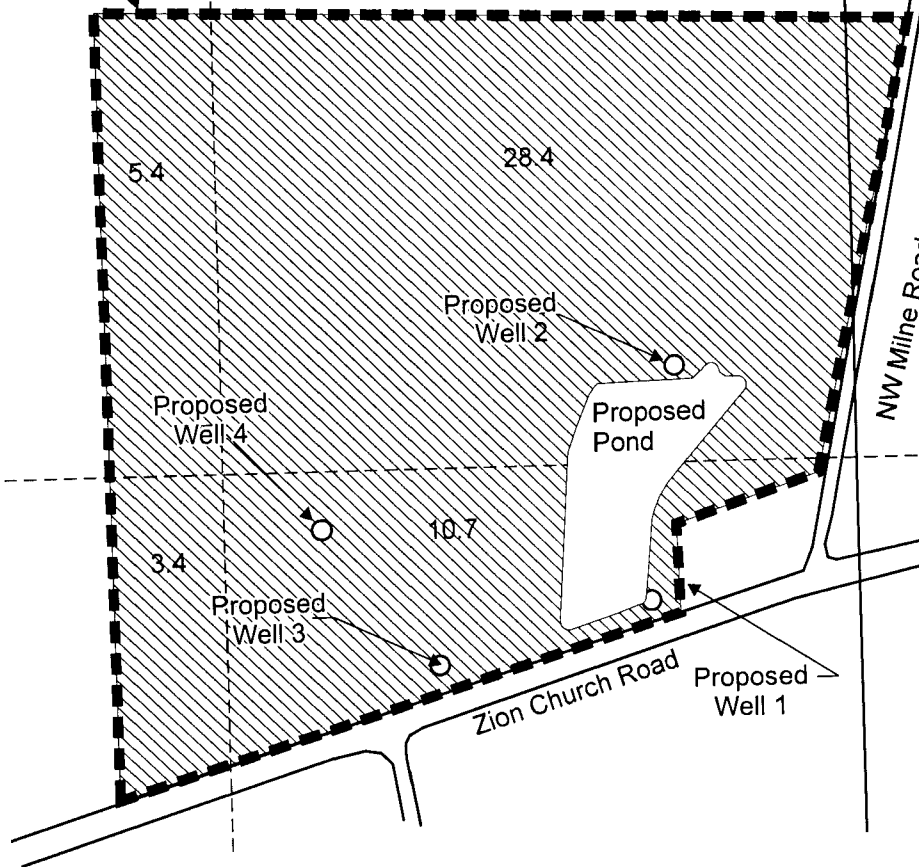

Melis & Kuyeller
STATE OF OREGON
EXPIRES DATE 6/30/13



Proposed Well 1 is located 1,610 feet south and 435 feet west from NE corner of Section 15.
 Proposed Well 2 is located 1,120 feet south and 375 feet west from NE corner of Section 15.
 Proposed Well 3 is located 1,730 feet south and 875 feet west from the NE corner of Section 15.
 Proposed Well 4 is located 1,440 feet south and 1,120 feet west from NE corner of Section 15.
 Proposed center of berm is located feet 1,635 south and 510 feet west from NE corner of Section 15.

RECEIVED

MAR 06 2013

WATER RESOURCES DEPT
SALEM, OREGON

This map was prepared for the purpose of identifying the location of a water right only and is not intended to provide legal dimensions or location of property ownership lines.

 Area (47.9 Acres) to be irrigated.
 Tax lot boundary

Scale: 1" = 400'

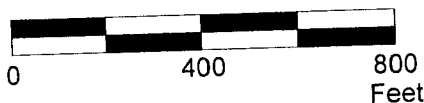

BloomingAppMap.cdr

Pacific Hydro-Geology Inc.

Water Right Application Map

Blooming Nursery
T.1N. R.3W. Section 15, Tax Lot 300

03/2013 MRK

G-17633