

0 660 1,320 2,640 3,960 5,280 Feet

1" = 1320'

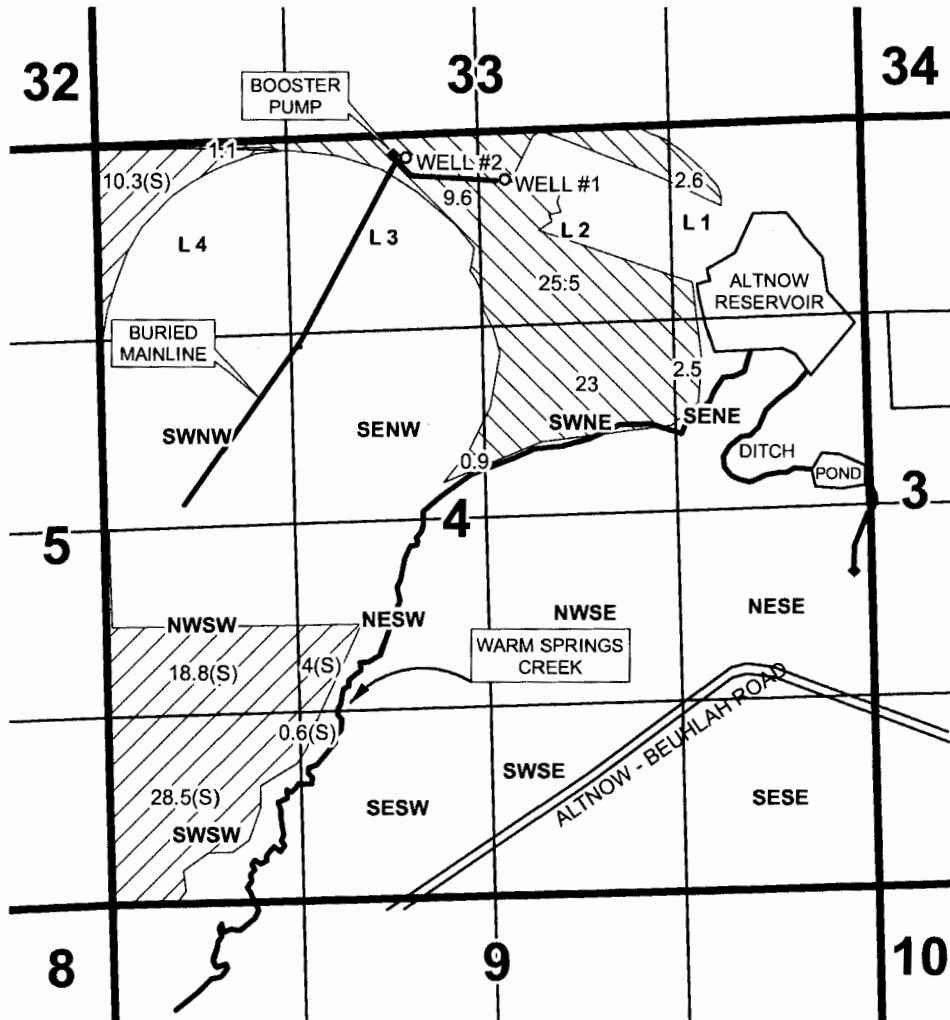

T 20 S, R 36 E, WM SECTION 4, TL 500 HARNEY COUNTY, OREGON



WELL #1 - 375' S, 200' E FROM SECTION 4 N 1/4 CORNER
 WELL #2 - 180' S, 500' W FROM SECTION 4 N 1/4 CORNER
 TL 500 EXCEEDS 3,000 ACRES INCLUDING ALL OF SEC. 4

RECEIVED

DEC 03 2013

OWRD

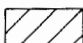
-  PROPOSED GROUND WATER PRIMARY
-  PROPOSED GROUND WATER SUPPLEMENTAL (S)

GROUND WATER APPLICATION MAP for COTTONWOOD CREEK RANCH

PROJECT # 13061

AUG 27, 2013

This map is not intended to provide legal dimensions or locations of property ownership lines.

WATER RIGHT SERVICES, LLC

PO BOX 1830, BEND, OR 97709

WWW.OREGONWATER.US 541-389-2837

johnshort@usa.com