

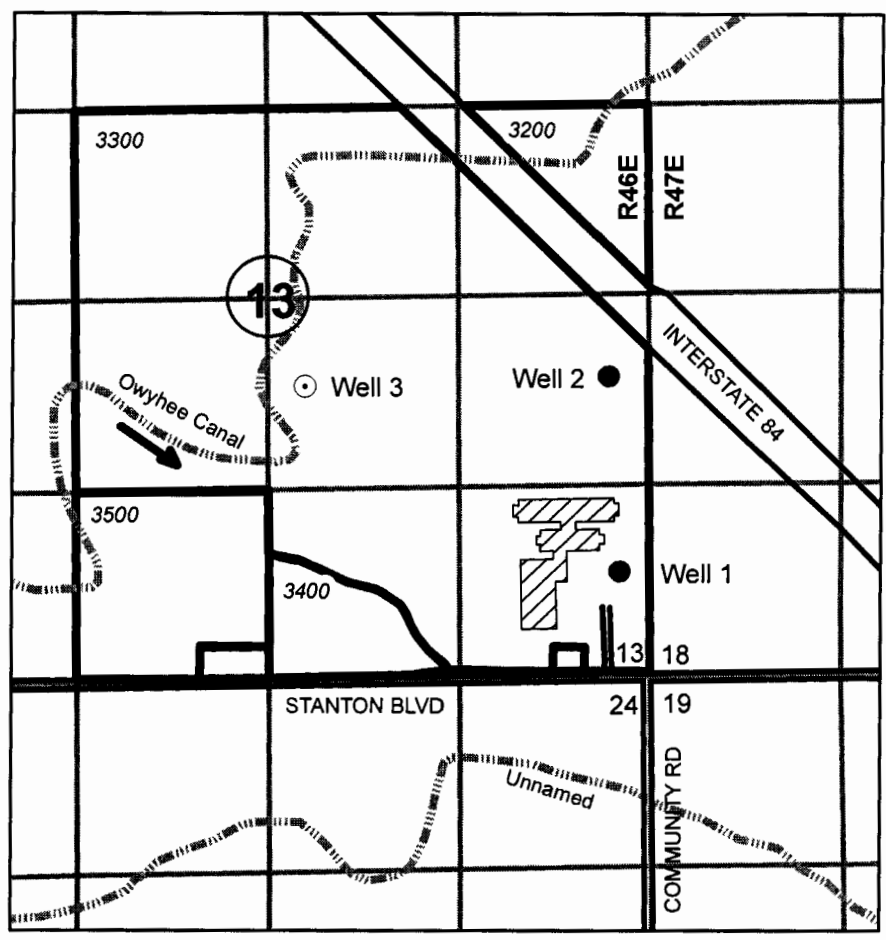

**SECTION 13  
T17S, R46E, WM  
MALHEUR COUNTY**



1 inch = 1320 feet



⊙ **Proposed POA**  
Proposed groundwater well located 600 feet S and 245 feet E from Center of Section 13. Well will withdraw water from alluvial aquifer.

 **Proposed POU**  
Proposed place of use is industrial facility located in the SE/4 of SE/4 of Section 13, T17S, R46E, WM.

● **Existing Wells**  
Two wells exist on the property. Well 1 constructed in 2000 (Well Log MALH 51564). Well 2 constructed in 2006 (Well Log MALH 53047). Neither well will be used under proposed water right.

- - - - **Conveyance**  
Water conveyance system has not yet been designed. A buried 6-inch PVC mainline is expected to convey water from the new well to the industrial facility.

**RECEIVED**

MAR 22 2013

WATER RESOURCES DEPT  
SALEM, OREGON

The purpose of this map is to identify the location of a water right. It is not intended to provide information regarding the location of property ownership boundary lines.

6-17639

CASCADE EARTH SCIENCES  
3511 Pacific Blvd SW  
Albany, OR 97321  
(541) 926-7737

**APPLICATION MAP**  
**Permit to Use Groundwater**  
**for Industrial Use**  
in the name of  
CONAGRA FOODS  
Revised 28 FEB 2013