

T.6S. R.2W. Section 32, W.M.

Morgan
DLC 72

32

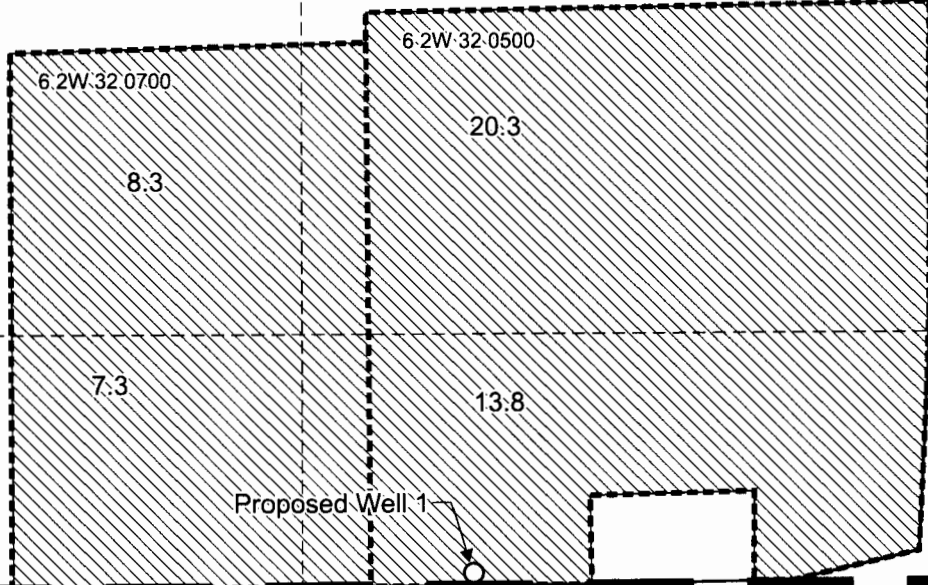

Hazel Green Rd. NE

Stephens
DLC 48



RENEWS June 30 2015

Proposed Well 1 is located 495 feet south and 1,670 feet east from the center of Section 32.

- Area (49.7 Acres) to be irrigated.
- Tax lot boundary
- Donation Land Claim

RECEIVED

APR 14 2014

WATER RIGHTS DEPT
SARAH OLSON

Scale: 1" = 400'

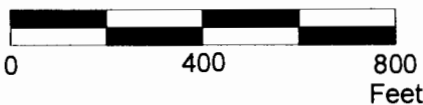

This map was prepared for the purpose of identifying the location of a water right only and is not intended to provide legal dimensions or location of property ownership lines.

Water Right Application Map

C. Keith Olson Trustee
T.6S. R.2W. Section 32, W.M.

Pacific Hydro-Geology Inc.

04/2014 G-17835

OlsonWRApp.cdr