

Application for a Permit to Use Groundwater

Application in the Name of Hillsboro School District 1J

Township 1 North, Range 2 West (W.M.)

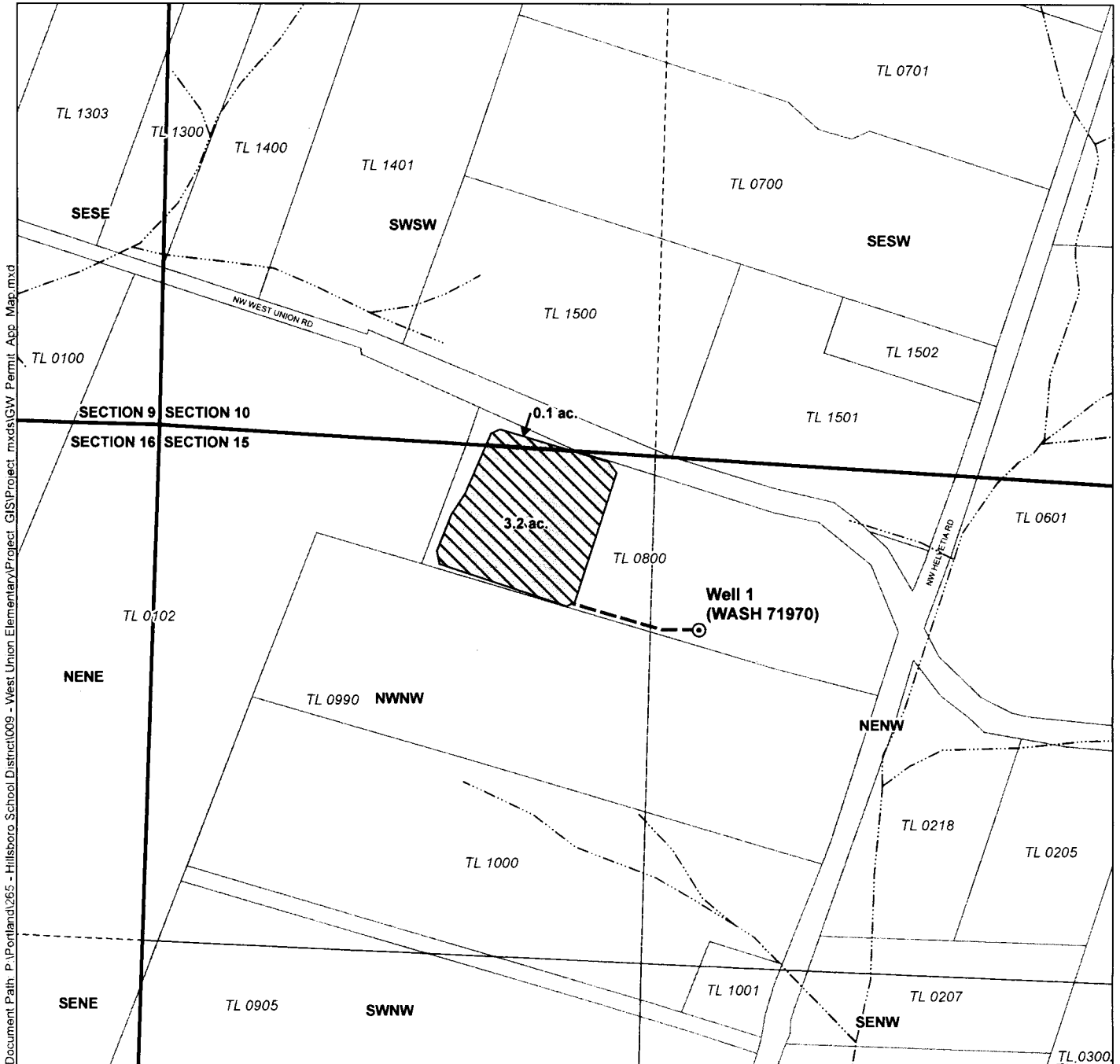

Document Path: P:\Portland\265 - Hillsboro School District\009 - West Union Elementary\Project_GIS\Project_mxd\GIS\Permit_App_Map.mxd

LEGEND

- Proposed Point of Appropriation (POA)
- Proposed Place of Use (POU)
- Proposed Water Conveyance Mainline
- Tax Lots
- Watercourses

Disclaimer

This map was prepared for the purpose of identifying the location of a water right only and it is not intended to provide legal dimensions or location of property ownership lines.

RECEIVED BY OWRD

JUL 03 2014

SALEM, OR

G-17887

POA Location Description

Well 1 (WASH 71970)
 Located 455 feet South and 1,440 feet East from the NW corner of Section 15, Township 1 North, Range 2 West (W.M.)

Map Notes

Date: May 27, 2014
 Data Sources: METRO RLIS, US BLM
 Prepared By: GSI Water Solutions, Inc.

