

T.3S. R.4E. Sec. 18 & 19, W.M.

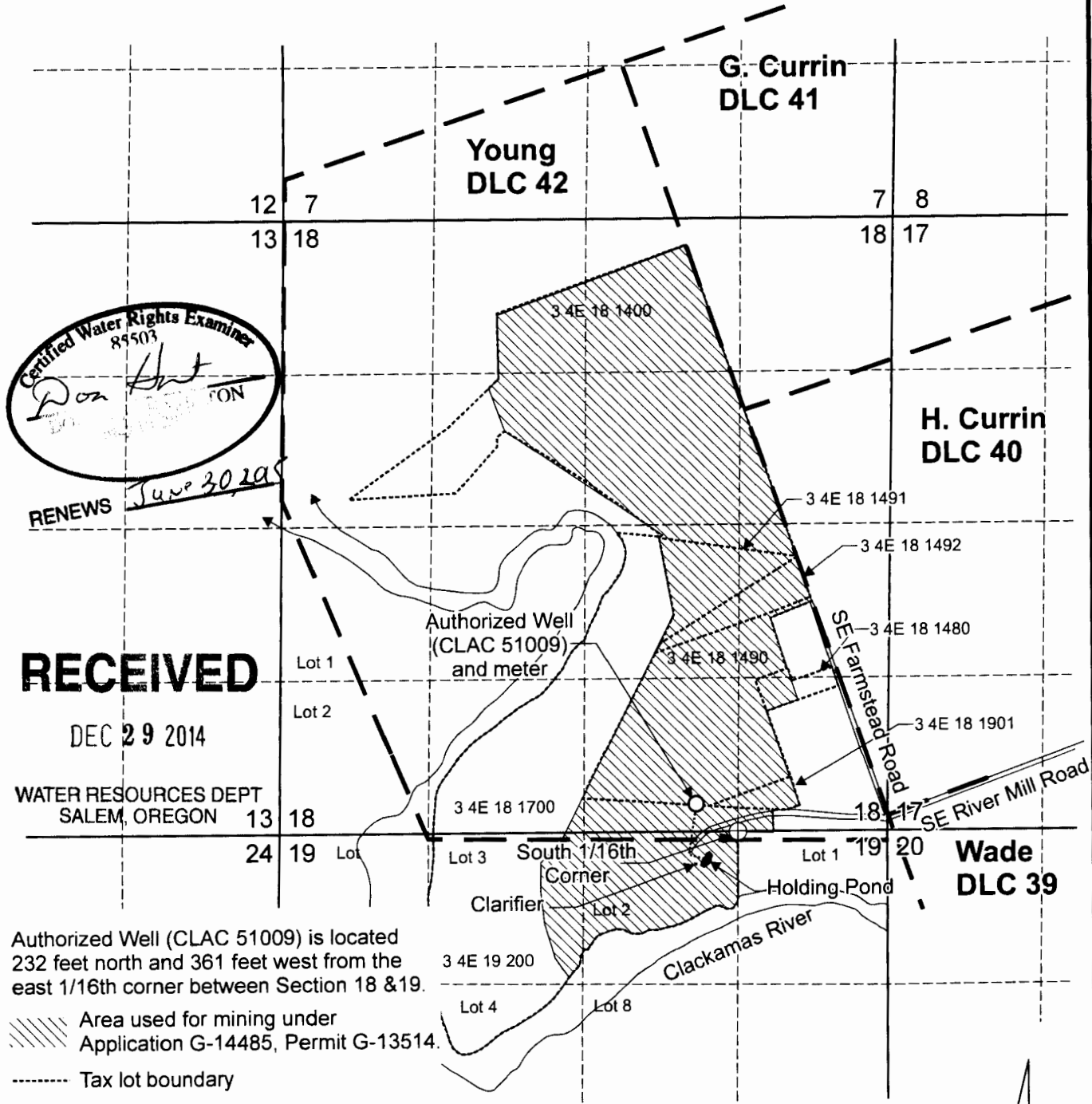

Certified Water Rights Examiner
89503
Don Holt
DON
RENEWS June 30, 2015

RECEIVED
DEC 29 2014

WATER RESOURCES DEPT
SALEM, OREGON 13 18
24 19 Lot

Authorized Well (CLAC 51009) is located 232 feet north and 361 feet west from the east 1/16th corner between Section 18 & 19.

- Area used for mining under Application G-14485, Permit G-13514.
- Tax lot boundary
- Donation Land Claim boundary
- Mainlines

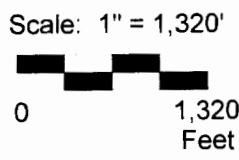

This map was prepared for the purpose of identifying the location of a water right only and is not intended to provide legal dimensions or location of property ownership lines.



Permit Amendment Application Map
Application G-14485, Permit G-13514

Estacada Rock Products, Inc.
T.3S. R.4E. Sec. 18 & 19, W.M.

Page 2 of 2

Pacific Hydro-Geology Inc.

12/2014

EstacadaPAMap.cdr