

# T.5S. R.4W. Section 7, W.M.

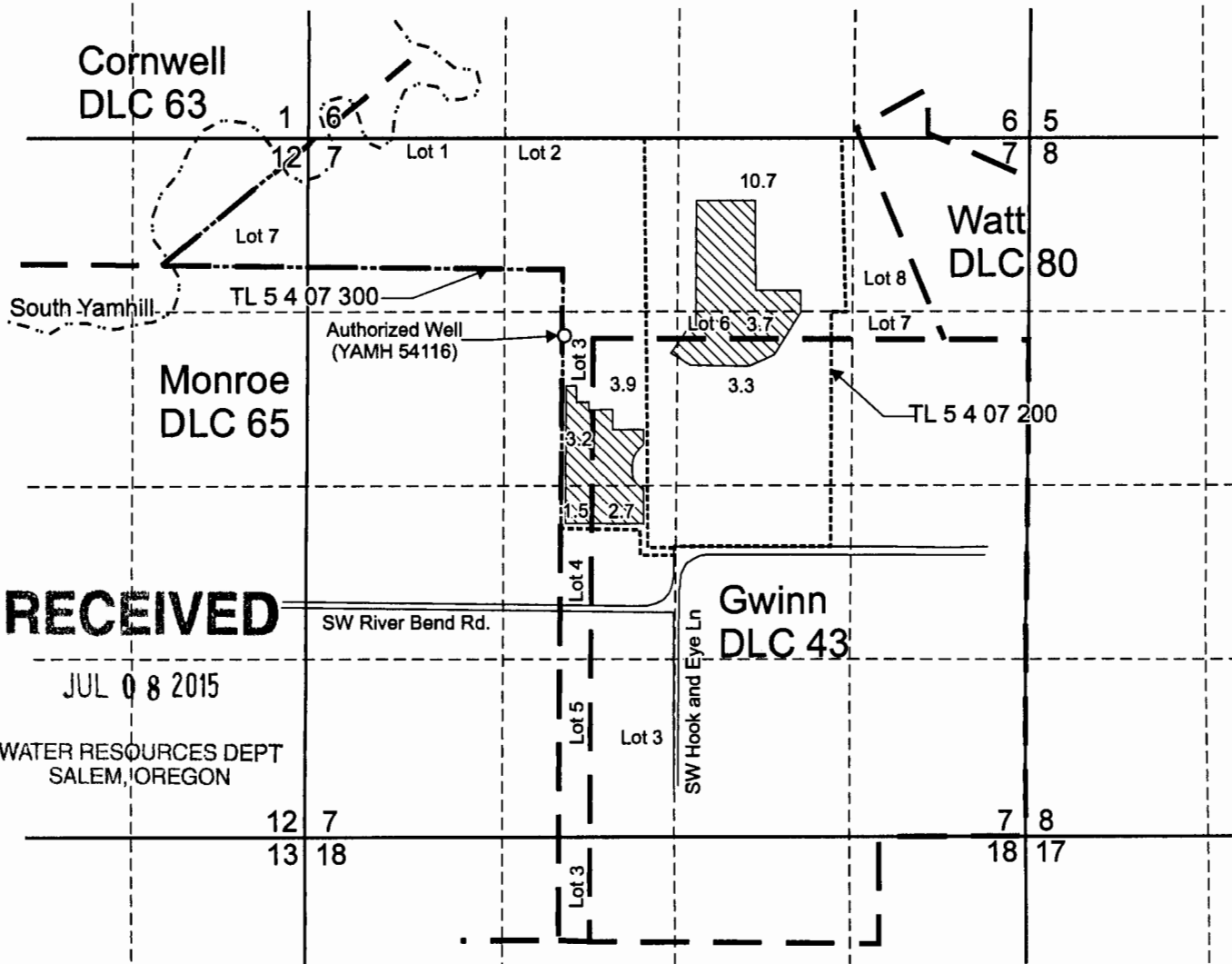



**RECEIVED**

JUL 08 2015

WATER RESOURCES DEPT  
SALEM, OREGON

Authorized Well (YAMH 54116) is located 1,500 feet south and 1,925 feet east from the NW corner, Section 7.

 Amended "To" Area (29.0 acres) to be irrigated under Application G-15846, Permit G-17338, priority 10-2-2002.

 Tax lot boundary

 Donation Land Claim boundary

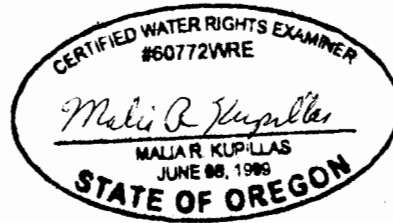

EXPIRATION DATE: 7/7/2015

Scale: 1" = 1,320'



This map was prepared for the purpose of identifying the location of a water right only and is not intended to provide legal dimensions or location of property ownership lines.



Permit Amendment "To" Map  
Application G-17338, Permit G-15846

Willamette Valley Land LLC  
T.5S. R.4W. Section 7, W.M.

Pacific Hydro-Geology Inc.

06/2015

Page 2 of 2

HandgenPAMap.cdr

T 12099

# T.5S. R.4W. Section 7, W.M.

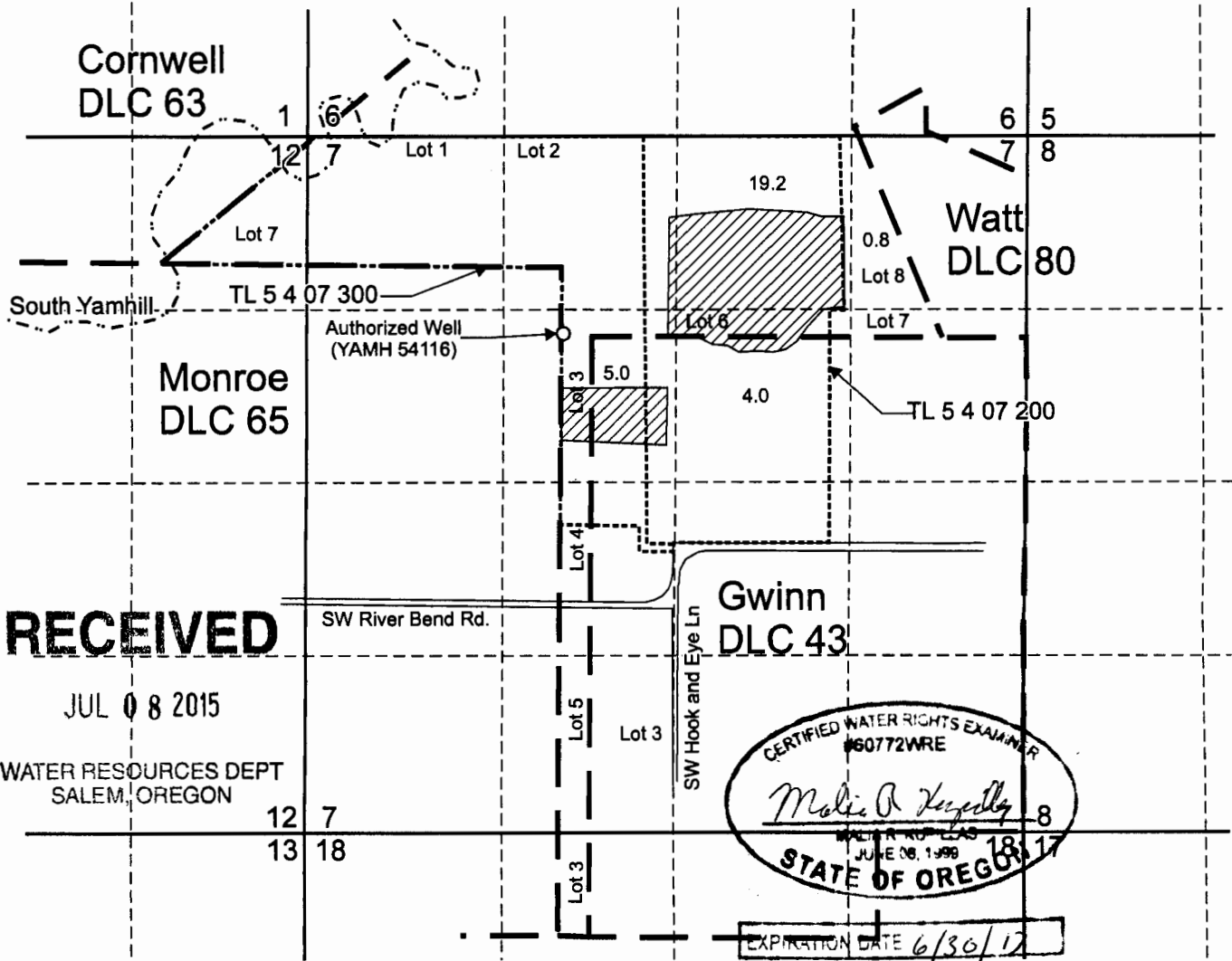

**RECEIVED**  
 JUL 08 2015  
 WATER RESOURCES DEPT  
 SALEM, OREGON

CERTIFIED WATER RIGHTS EXAMINER  
 #60772WRE  
*Melissa R. Kerpel*  
 STATE OF OREGON  
 EXPIRATION DATE 6/30/12

Authorized Well (YAMH 54116) is located 1,500 feet south and 1,925 feet east from the NW corner, Section 7.

"From" Area (29.0 acres) to be amended, Application G-15846, Permit G-17338, priority 10-3-2002.

Tax lot boundary

Donation Land Claim boundary

NOTE: The distribution of acres by quarter-quarter on the "From" map was generated using the most current and accurate data and corrects erroneously distributed acres on the permit and permit map. The description of acres by quarter-quarter on the "From" map reflects the same description as the permit map but the distribution has been corrected. The footprint of the permit map conforms to the general shapes of the subject tax lot, being 5S 4W TL 200. Additionally, neither Permit G-17338 nor the "From" map describe acres by DLC.

Scale: 1" = 1,320'



This map was prepared for the purpose of identifying the location of a water right only and is not intended to provide legal dimensions or location of property ownership lines.



**Permit Amendment "From" Map  
 Application G-15846, Permit G-17338**

Willamette Valley Land LLC  
 T.5S. R.4W. Section 7, W.M.

Pacific Hydro-Geology Inc.

06/2015

Page 1 of 2

HandgenPAMap.cdr

T 12099