

Diamond west LLC
GROUND WATER APPLICATION MAP

T. 8 S. R. 40 E. W. 1/4

This map is for the purpose of identifying the water right location only and is not intended to provide legal dimensions or location of property ownership lines

LEGEND

- Well
- Pivot Center
- Scale 1 in = 1 mile
- Primary

RECEIVED

MAR 12 2015

WATER RESOURCES DEPT
SALEM, OREGON

NEW WELL LOCATED
1320' East & 875' North
OF THE SW CORNER OF
SECTION 2 OF
T8S, R40E

WORKING MAP

G-18006

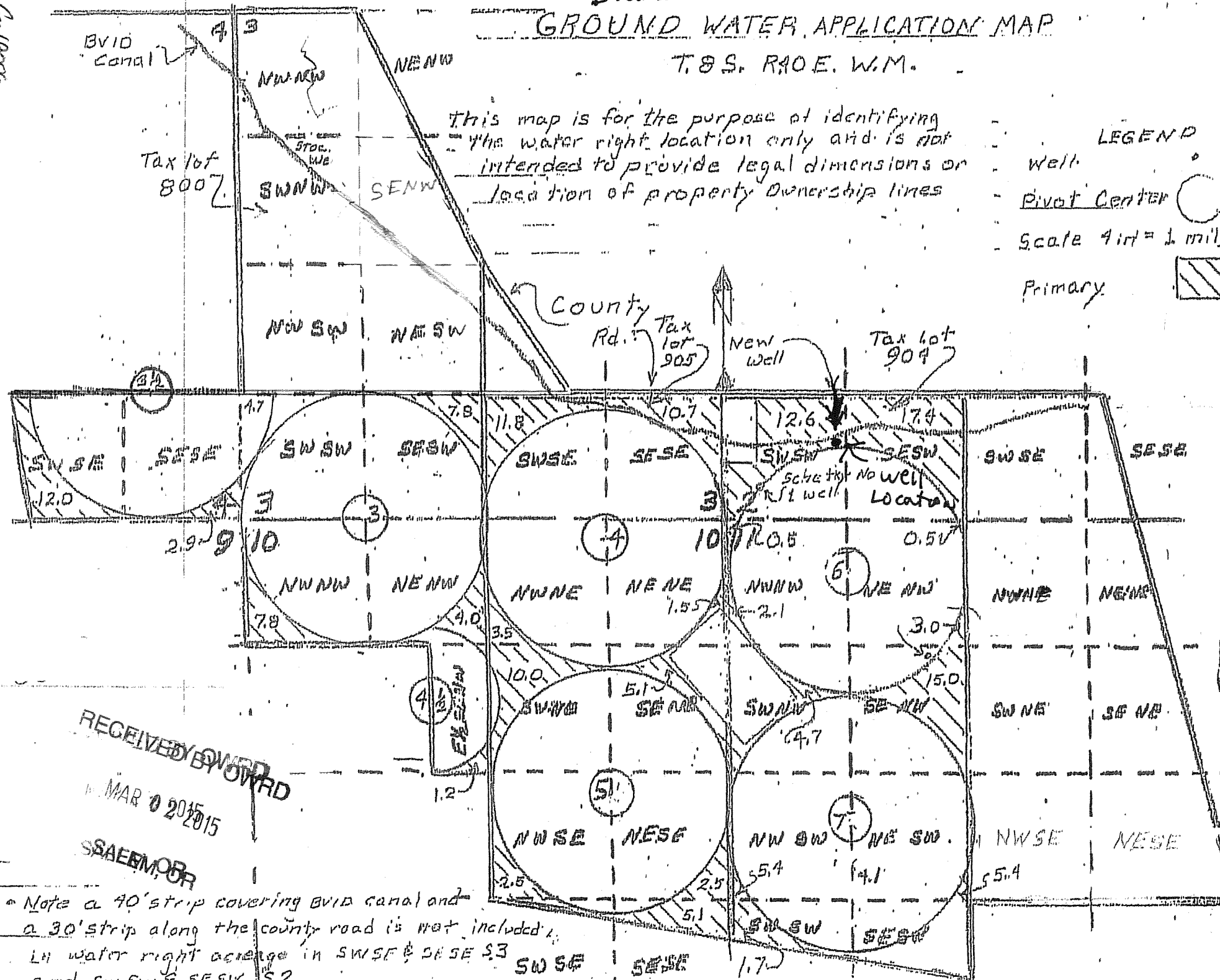

RECEIVED BY OWRD

MAR 10 2015

SSALEM, OR

Note a 40' strip covering BVID Canal and a 30' strip along the County Road is not included.
LH water right acreage in SWSE & SESE S3
and SW SW & SE SW S2