

# T.10S. R.3W. Sec. 8, 17, & 18 , W.M.

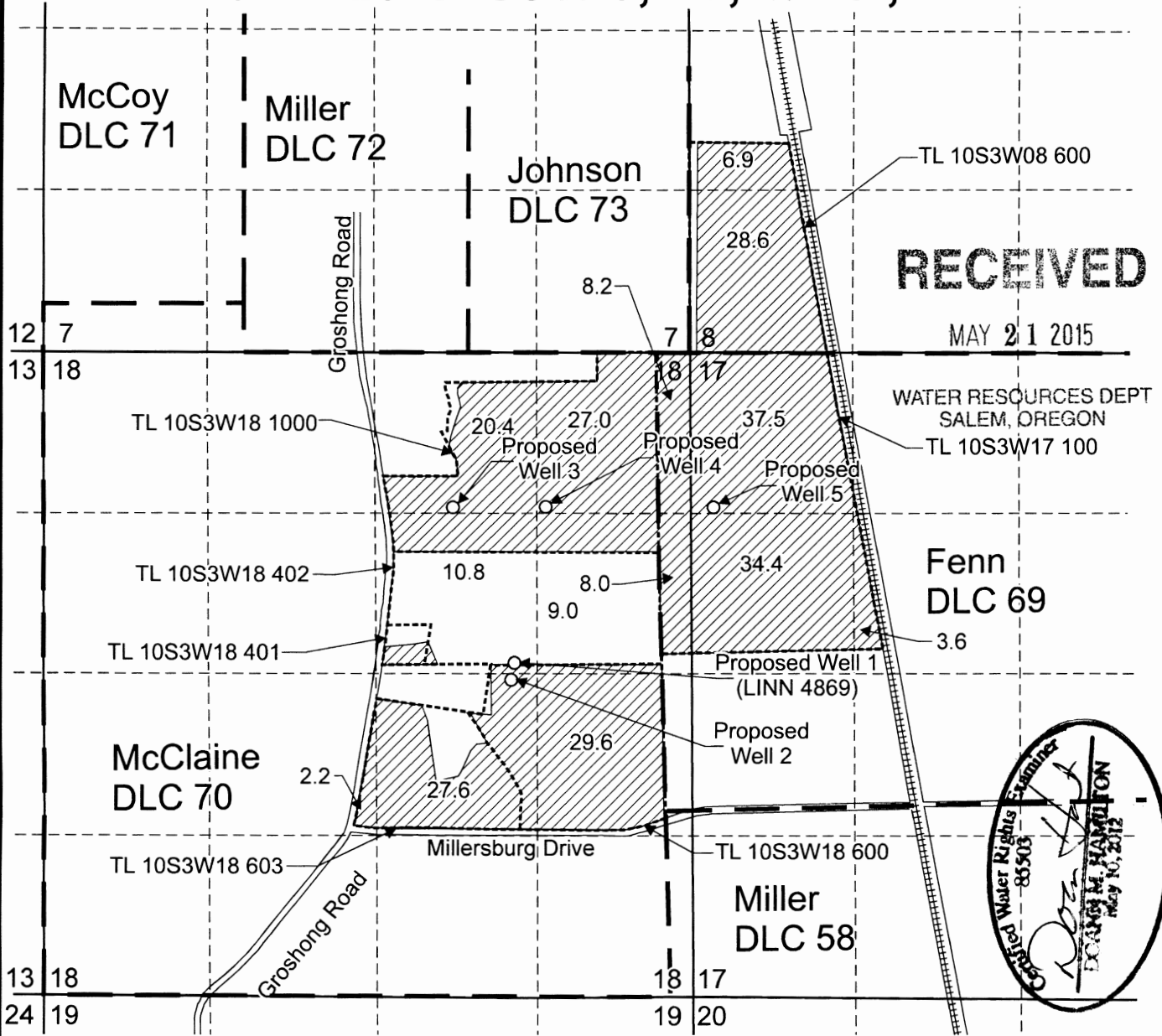

Proposed Well 1 (LINN 4869) is located 2,550 feet south and 1,440 feet west from the NE corner, Section 18 in DLC 70.

Proposed Well 2 is located 2,690 feet south and 1,450 feet west from the NE corner, Section 18 in DLC 70.

Proposed Well 3 is located 1,270 feet south and 1,930 feet west from the NE corner, Section 18 in DLC 70.

Proposed Well 4 is located 1,270 feet south and 1,180 feet west from the NE corner, Section 18 in DLC 70.

Proposed Well 5 is located 1,270 feet south and 20 feet east from the NW corner, Section 17 in DLC 69.

 Area (253.8 acres) to be irrigated.

 Donation Land Claim

 Tax lot boundary

Scale: 1" = 1,320'



This map was prepared for the purpose of identifying the location of a water right only and is not intended to provide legal dimensions or location of property ownership lines.

## Water Right Application Map

Pacific Hydro-Geology Inc.

08/2014

Valley Falls LLC  
T.10S. R.3W. Section 8, 17 & 18, W.M.

Pacific Foods/Valley Falls Application Map.cdr

G-10090

RENEWS 5/20/2015