

**T25S, R31E,
SECTIONS 29 AND 32, WM**

HARNEY COUNTY, OREGON

RECEIVED BY OWRD

SEP 08 2015

SALEM, OR

WELL:

#6: 40' S AND 1,055' W
OF NE COR SEC 32

#7: 40' S AND 1,200' W
OF NE COR SEC 32





#9: 960' N AND 1,270' W
OF NE COR SEC 32

#13: 2,630' S AND 1,340' W
OF NE COR SEC 32

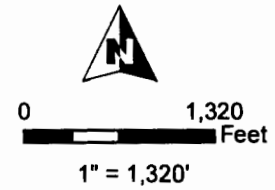
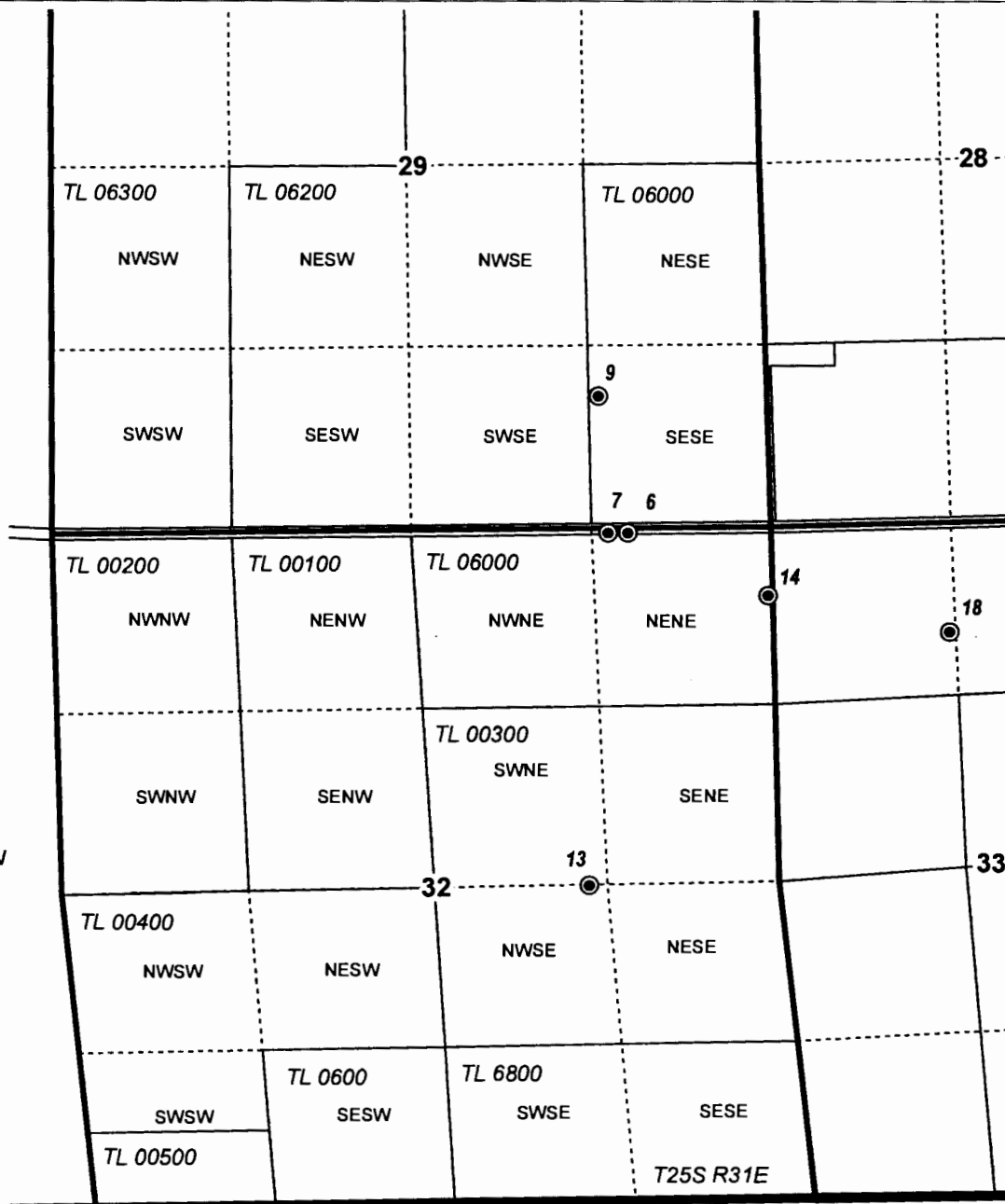
#14: 500' S AND 20' W
OF NE COR SEC 32

#18: 770' S AND 1,320' E
OF NW COR SEC 33



-  Township
-  Section
-  Quarter Quarter
-  Taxlot
-  Well

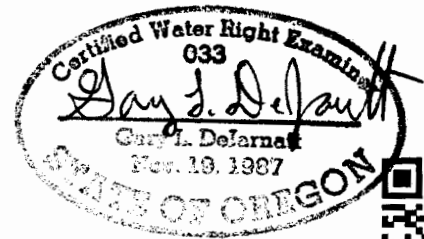

Maximum Rate = 4.19 cfs for Irrigation

T26S R31E

RENEWAL DATE 12/31/2015

SPLIT A PERMIT MAP 2
Golden Rule Farms, Inc.

1 12174

PERMIT G-13767

NOTE: THIS MAP IS NOT INTENDED TO
PROVIDE LEGAL DIMENSIONS OR LOCATIONS
OF PROPERTY OWNERSHIP LINES.

PROJECT #15040

AUGUST 7, 2015

WATER RIGHT SERVICES, LLC

PO BOX 1830, BEND, OR 97709

CCB# 197121 www.oregonwater.us

541-389-2837 JOHNSHORT@USA.COM

T25S, R31E, SECTIONS 27, 28, AND 34 WM

HARNEY COUNTY, OREGON

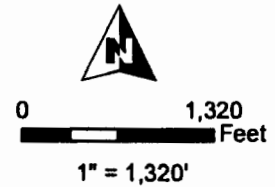
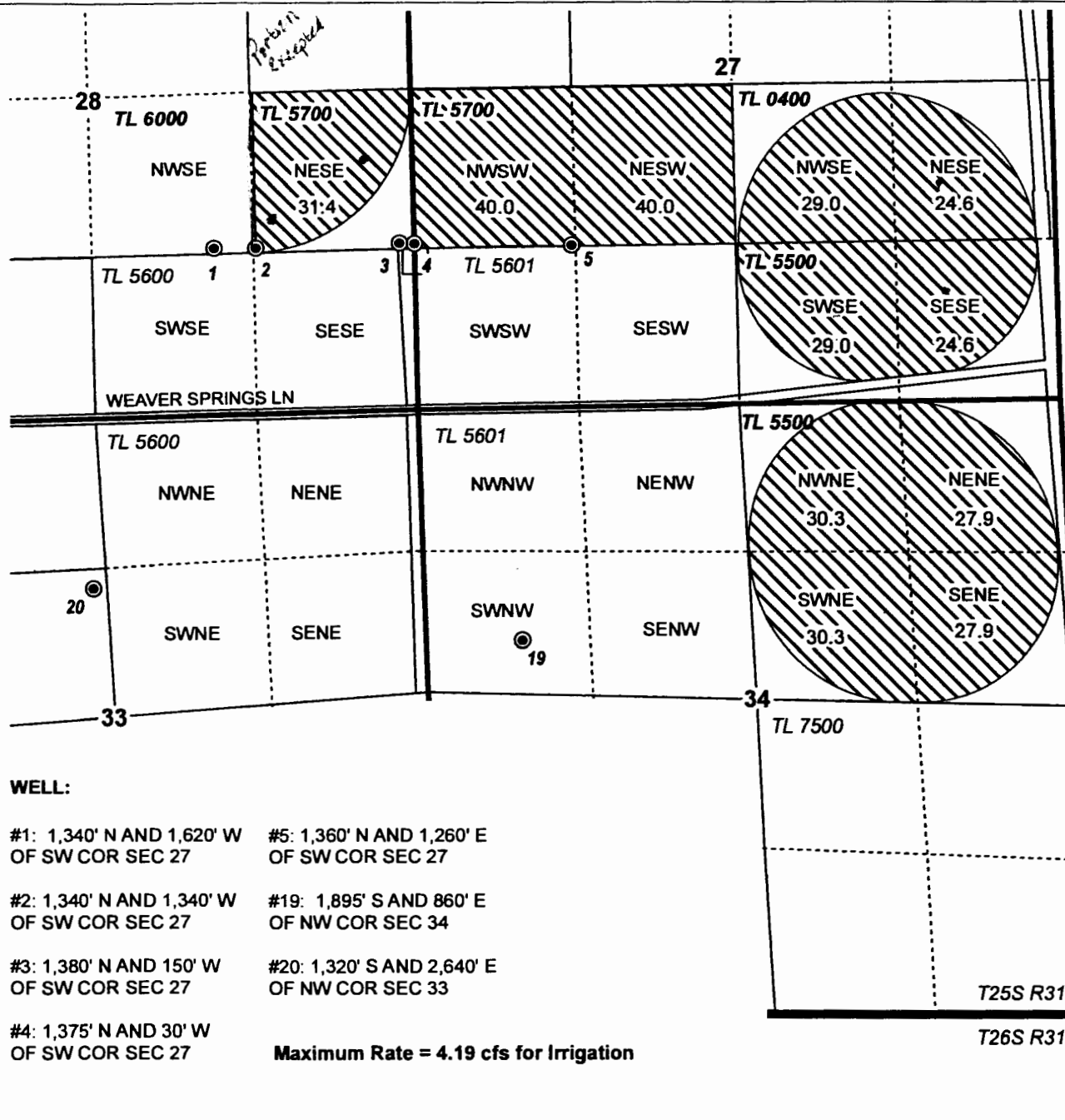

- POU Irrigation
- Township
- Section
- Quarter Quarter
- Taxlot
- Well

WELL:

- #1: 1,340' N AND 1,620' W OF SW COR SEC 27
 - #2: 1,340' N AND 1,340' W OF SW COR SEC 27
 - #3: 1,380' N AND 150' W OF SW COR SEC 27
 - #4: 1,375' N AND 30' W OF SW COR SEC 27
 - #5: 1,360' N AND 1,260' E OF SW COR SEC 27
 - #19: 1,895' S AND 860' E OF NW COR SEC 34
 - #20: 1,320' S AND 2,640' E OF NW COR SEC 33
- Maximum Rate = 4.19 cfs for Irrigation**

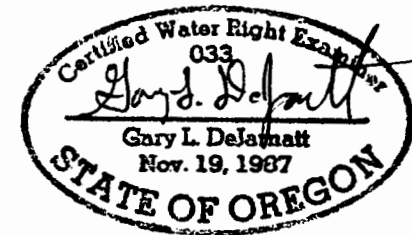

RENEWAL DATE 12/31/2015

SPLIT A PERMIT MAP 1
Golden Rule Farms, Inc.

PERMIT G-13767

NOTE: THIS MAP IS NOT INTENDED TO PROVIDE LEGAL DIMENSIONS OR LOCATIONS OF PROPERTY OWNERSHIP LINES.

PROJECT #15040

AUGUST 7, 2015

WATER RIGHT SERVICES, LLC
PO BOX 1830, BEND, OR 97709
CCB# 197121 www.oregonwater.us
541-389-2837 JOHNSHORT@USA.COM

RECEIVED BY OWRD

SEP 08 2015

SALEM, OR

471211