

Well Location: 45.24175, -122.86681
1125 Feet South and 340 Feet East from the NW corner of Section 7

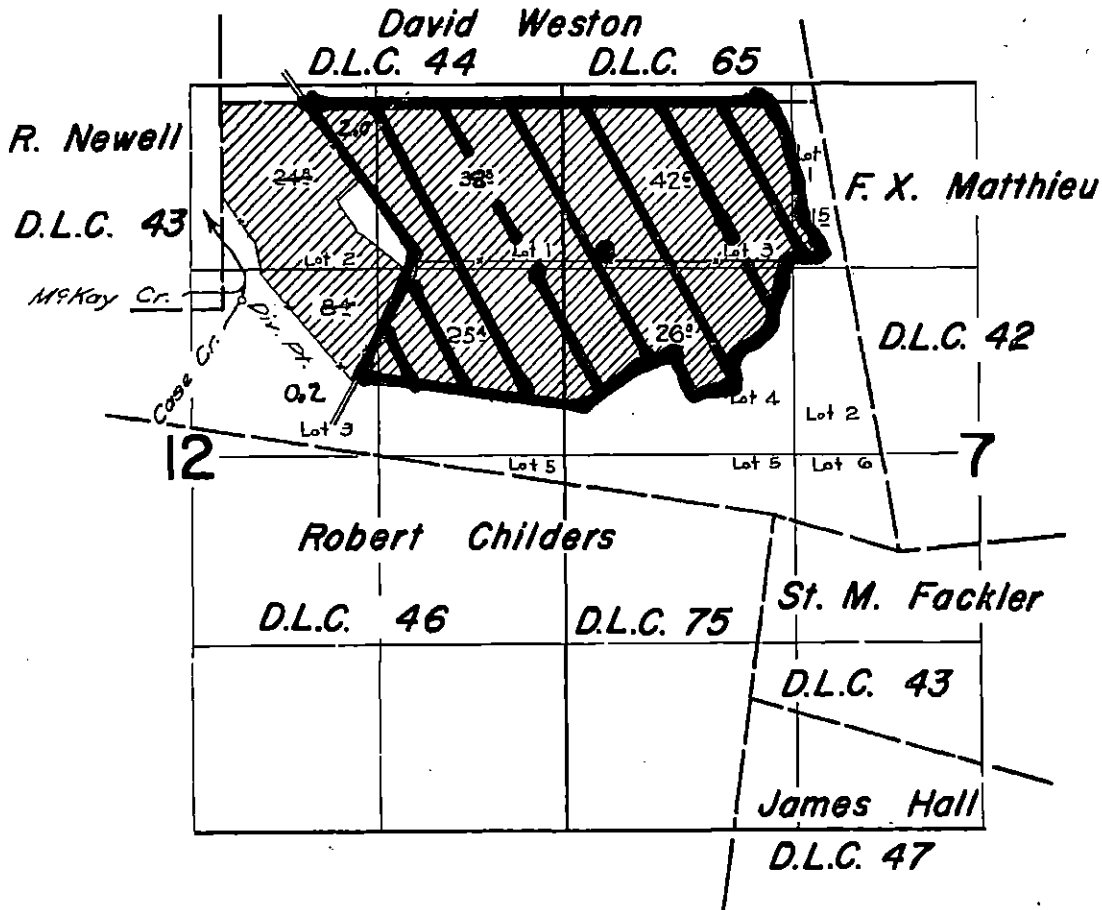

135.9 acre

T.4S.R.18&2W.W.M.



RECEIVED

SEP 03 2014

WATER RESOURCES DEPT
SALEM, OREGON

FINAL PROOF SURVEY
UNDER

Application No. 322.64.. Permit No. 254.50..
IN NAME OF

FRANCIS ITEL

Surveyed March 28 1962, by *R. Peterson*

G-17917

1" = 1320

Tax Lot 100 + 400

David Weston 9-3-2014 1962-J