

**T23S, R32.5 E,
SECTION 13, WM**

HARNEY COUNTY, OREGON



0 1,320 Feet
1" = 1,320'

-  POU IR
-  Township
-  Section
-  Quarter Quarter
-  Taxlot
-  Well

RECEIVED BY OWRD

MAR 21 2016

SALEM, OR



RENEWAL DATE 12/31/2017

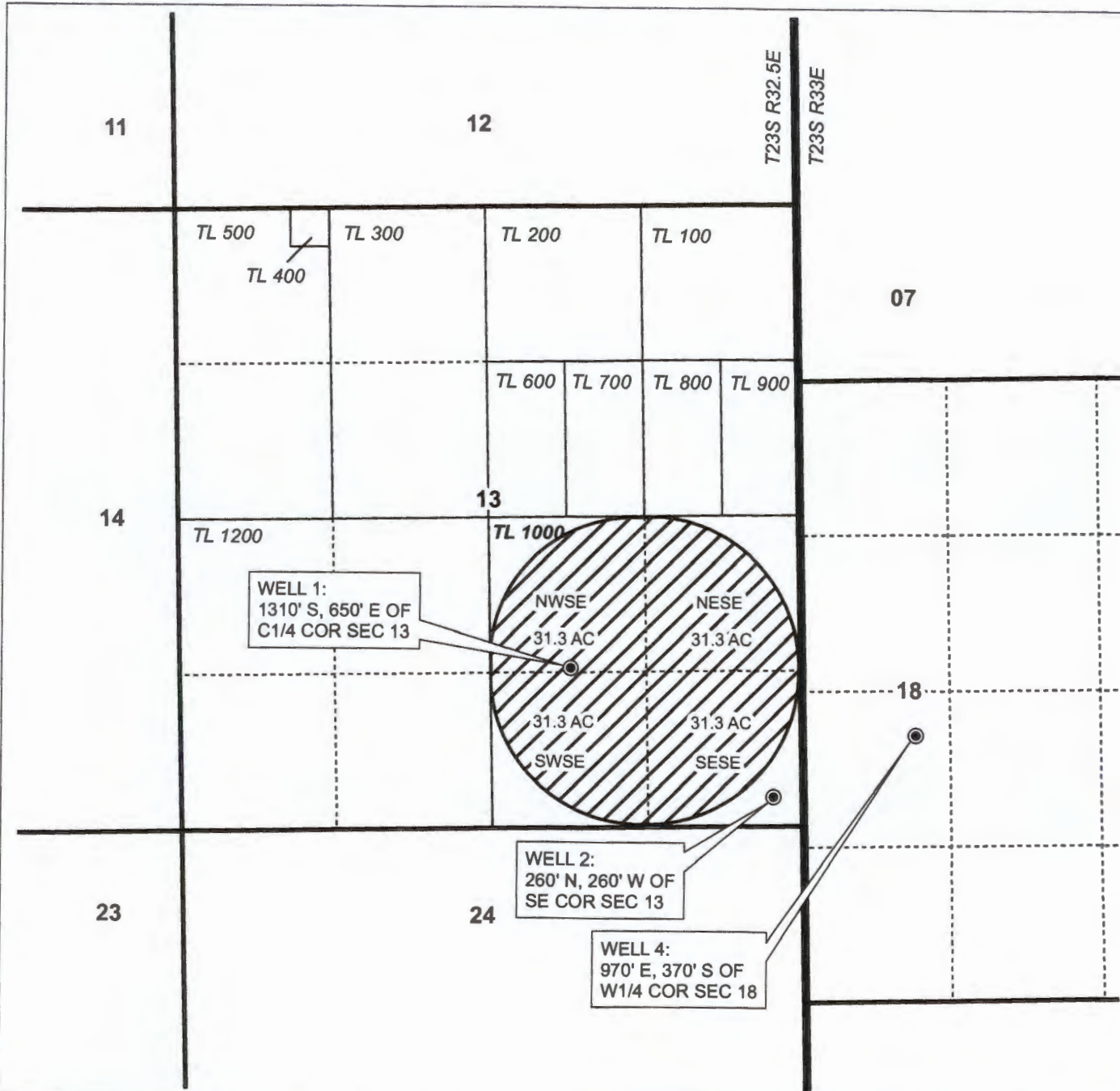

**PERMIT AMENDMENT MAP
John Ensz Farms, LLC**

NOTE: THIS MAP IS NOT INTENDED TO
PROVIDE LEGAL DIMENSIONS OR LOCATIONS
OF PROPERTY OWNERSHIP LINES.

WATER RIGHT SERVICES, LLC
PO BOX 1830, BEND, OR 97709
CCB# 197121 www.oregonwater.us
541-389-2837 JOHNSHORT@USA.COM

AP G-17071

PERMIT G-16497 T

12317

FEBRUARY 12, 2016