

Ground Water Application Map for Wesley Mathis

23.06 Acres of Nursery Use

Map ID: 36S-1W-5-SE/NE-tax lot 204

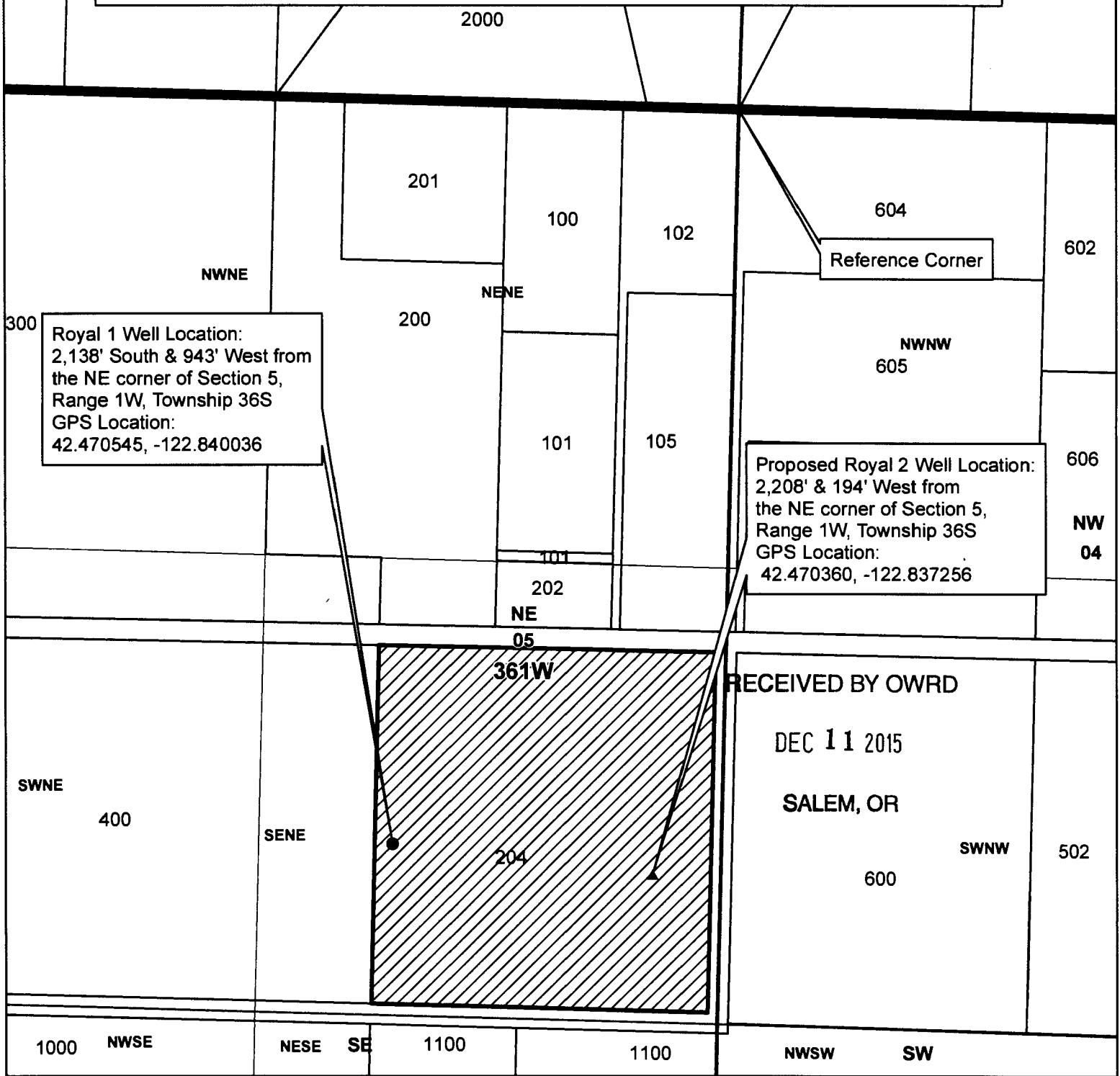

Royal 1 Well Location:
 2,138' South & 943' West from
 the NE corner of Section 5,
 Range 1W, Township 36S
 GPS Location:
 42.470545, -122.840036

Proposed Royal 2 Well Location:
 2,208' & 194' West from
 the NE corner of Section 5,
 Range 1W, Township 36S
 GPS Location:
 42.470360, -122.837256

RECEIVED BY OWRD
 DEC 11 2015
 SALEM, OR

<p>Legend</p> <ul style="list-style-type: none"> ● Royal 1 Well ▲ Royal 2 Proposed Well Nursery Use 23.06 acres Taxlot 204 Taxlots <i>6-18-76</i> Townships Sections Quarter Sections Quarter Quarter Sections 	<p>1 inch = 400 feet</p>	<p style="text-align: center;">JACKSON COUNTY WATERMASTER</p> <p>Prepared by Travis Kelly</p> <p><small>This map is based on a digital database compiled by Jackson County from a variety of sources. Jackson County cannot accept responsibility for errors, omissions, or positional accuracy. There are no warranties, expressed or implied.</small></p>
---	--------------------------	--