

Walport Groundwater Application

Proposed Place of use:

- 37S-4W-31-SW/SE: 16 acres
- 37S-4W-31-SE/SE: 10.5 acres
- 38S-4W-6-NW/NE: 8.6 acres
- 38S-4W-6-NE/NE: 1 acre

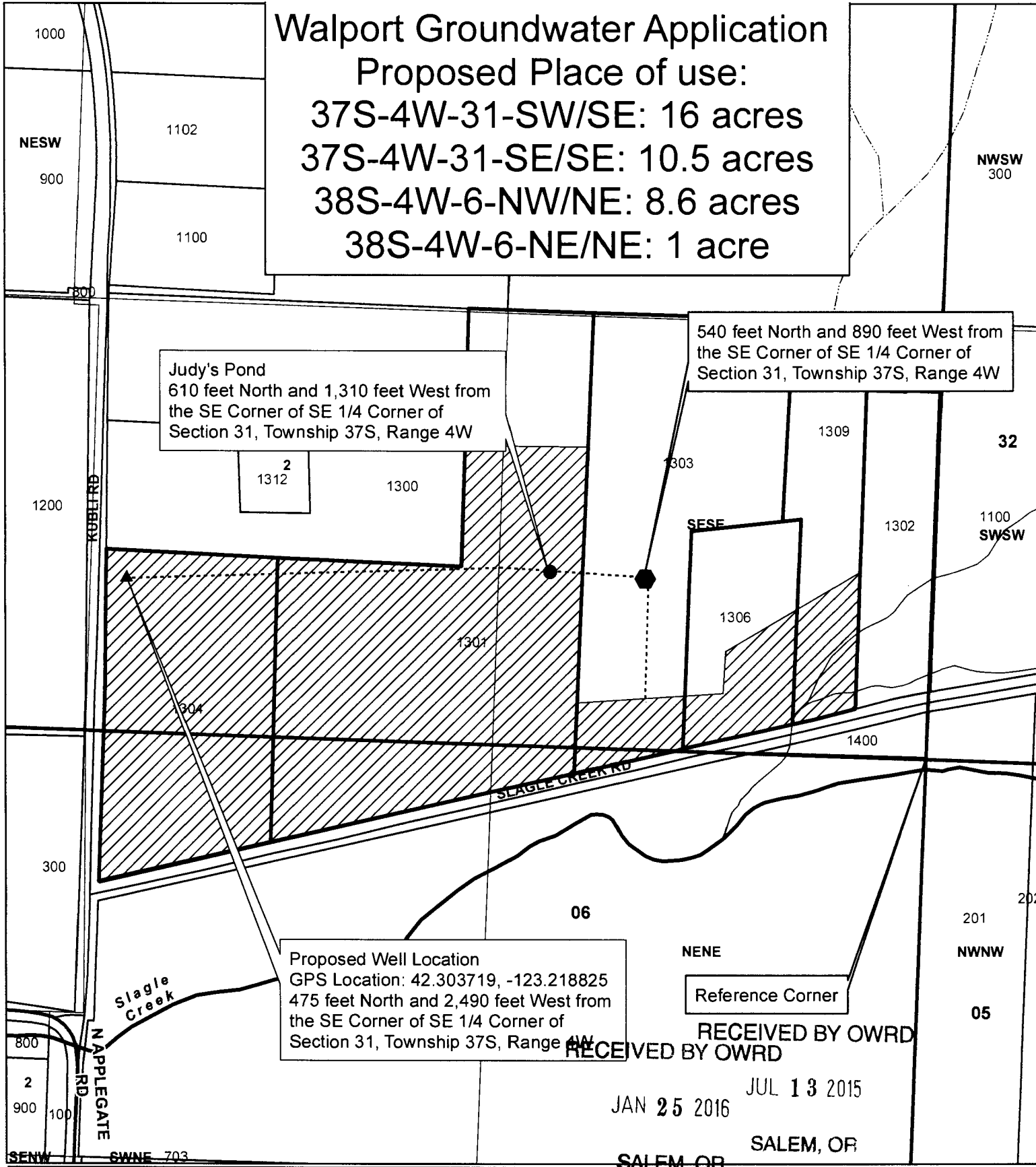

Judy's Pond
610 feet North and 1,310 feet West from
the SE Corner of SE 1/4 Corner of
Section 31, Township 37S, Range 4W

540 feet North and 890 feet West from
the SE Corner of SE 1/4 Corner of
Section 31, Township 37S, Range 4W

Proposed Well Location
GPS Location: 42.303719, -123.218825
475 feet North and 2,490 feet West from
the SE Corner of SE 1/4 Corner of
Section 31, Township 37S, Range 4W

Reference Corner

RECEIVED BY OWRD
RECEIVED BY OWRD

JAN 25 2016 JUL 13 2015

SALEM, OR

Legend

- Pipeline
- Place of Use
- Amy's Pond
- Proposed Well Location
- Taxlots: 1301, 1303, 1304, 1306, 1309
- Townships
- Sections
- Quarter Quarter Section

1 inch = 400 feet

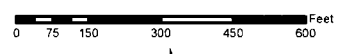

JACKSON COUNTY
WATERMASTER

Prepared by Travis Kelly

This map is based on a digital database compiled by Jackson County from a variety of sources. Jackson County cannot accept responsibility for errors, omissions, or positional accuracy. There are no warranties, expressed or implied.

G-10238