



RECEIVED

DEC 12 2001

WATER RESOURCES DEPT.
SALEM, OREGON

LEGEND

- ⊙ Wells
- ~ Streams
- Place of Use
- City Limits

SCALE ADJUSTED
TO BE APPROX.

1" = 1320'

12/17/01

SALEM, OR

SEP 06 2016

RECEIVED BY OWRD

Figure 1
Well location map
Saint Paul, OR

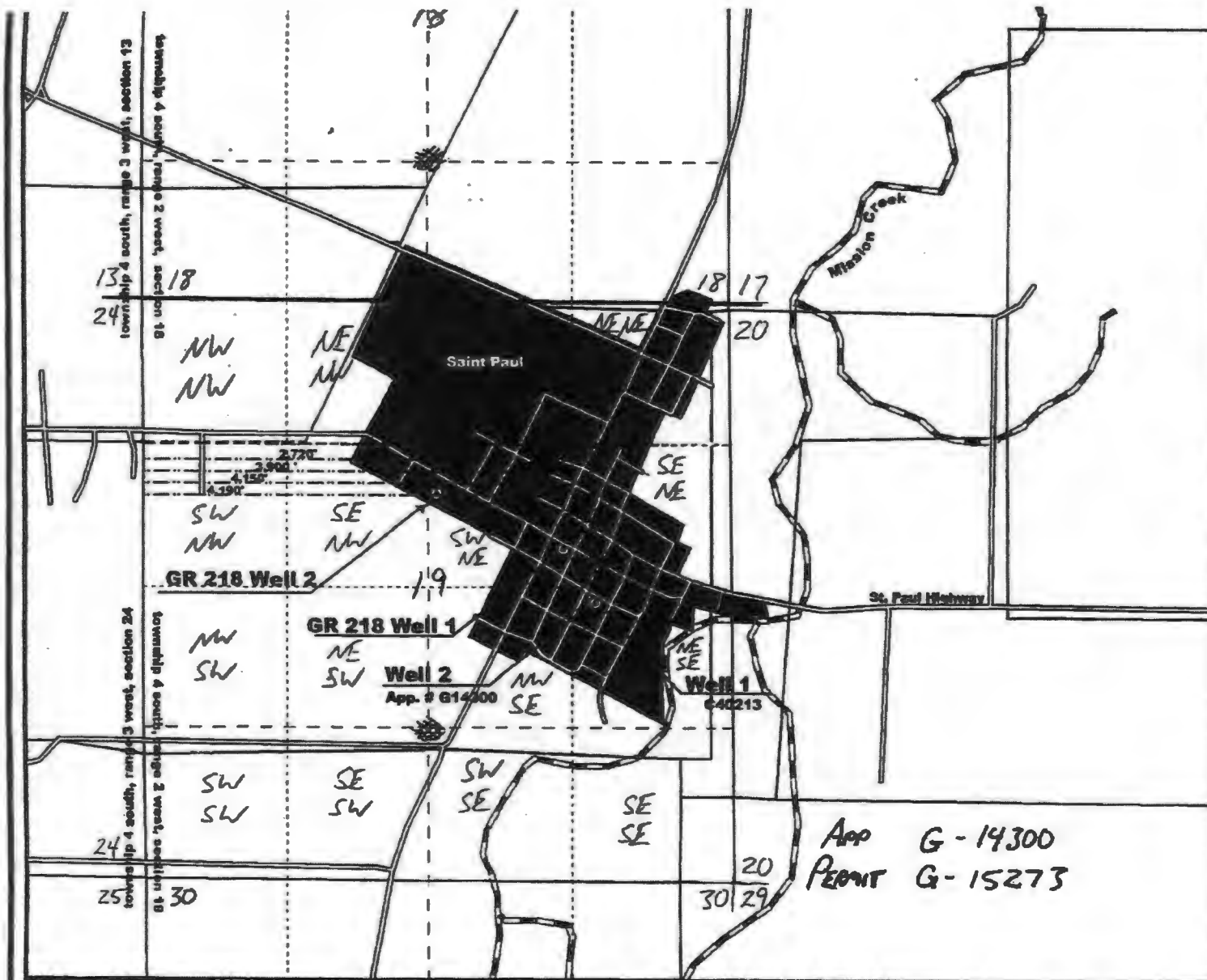

SCALE

1" = 1320'



Well 2 (App. # G14300) Location:
4,150 feet East and 1,400 feet South
from the NW corner of Section 19,
Township 4 South, Range 2 West

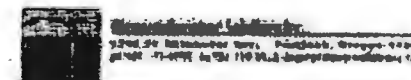

T 12471

Permit Amendment Application Additional Point of Appropriation

Application G-14300, Permit G-15273
City of St. Paul, Oregon

Township 4 South, Range 2 West (W.M.)

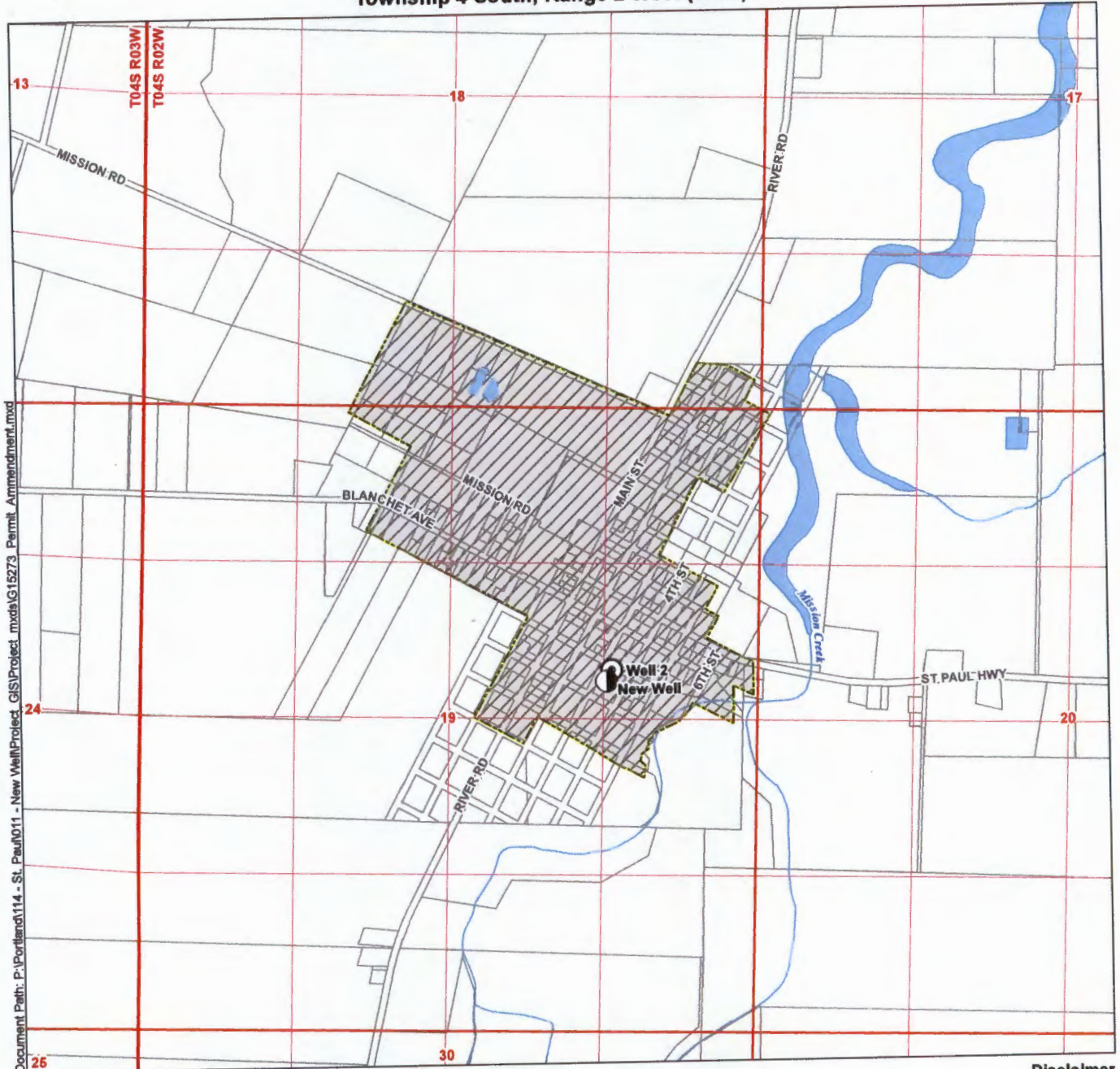

Document Path: P:\Portland\114 - St. Paul\011 - New Well\Protect_GIS\Project_mxd\G15273 Permitt_Amendment.mxd

LEGEND

- Additional Point of Appropriation (APOA)
- Point of Appropriation (POA)
- Place of Use (POU)
- City Boundary
- Tax Lot
- Watercourse
- Waterbody

POA Location Description

New Well

Located 2,415 feet South and 4,085 feet East from the NW corner of Section 19, Township 4 South, Range 2 West (W.M.)

Well 2

Located 2,314 Feet South and 4,150 Feet East from the NW Corner Section 19, Township 4 South, Range 2 West (W.M.)

Disclaimer

This map was prepared for the purpose of identifying the location of a water right only and it is not intended to provide legal dimensions or location of property ownership lines.

Map Notes

Date: August 23, 2016
Date Sources: BLM, ESRI, USGS
Prepared By: GSI Water Solutions, Inc.

RECEIVED BY OWRD

SEP 06 2016

SALEM, OR



T 12471