

T.18S., R.47E., W.M.

IDAHO AVENUE INTERCHANGE
OLD OREGON TRAIL HIGHWAY
MALHEUR COUNTY

SCALE: 1" = 200'

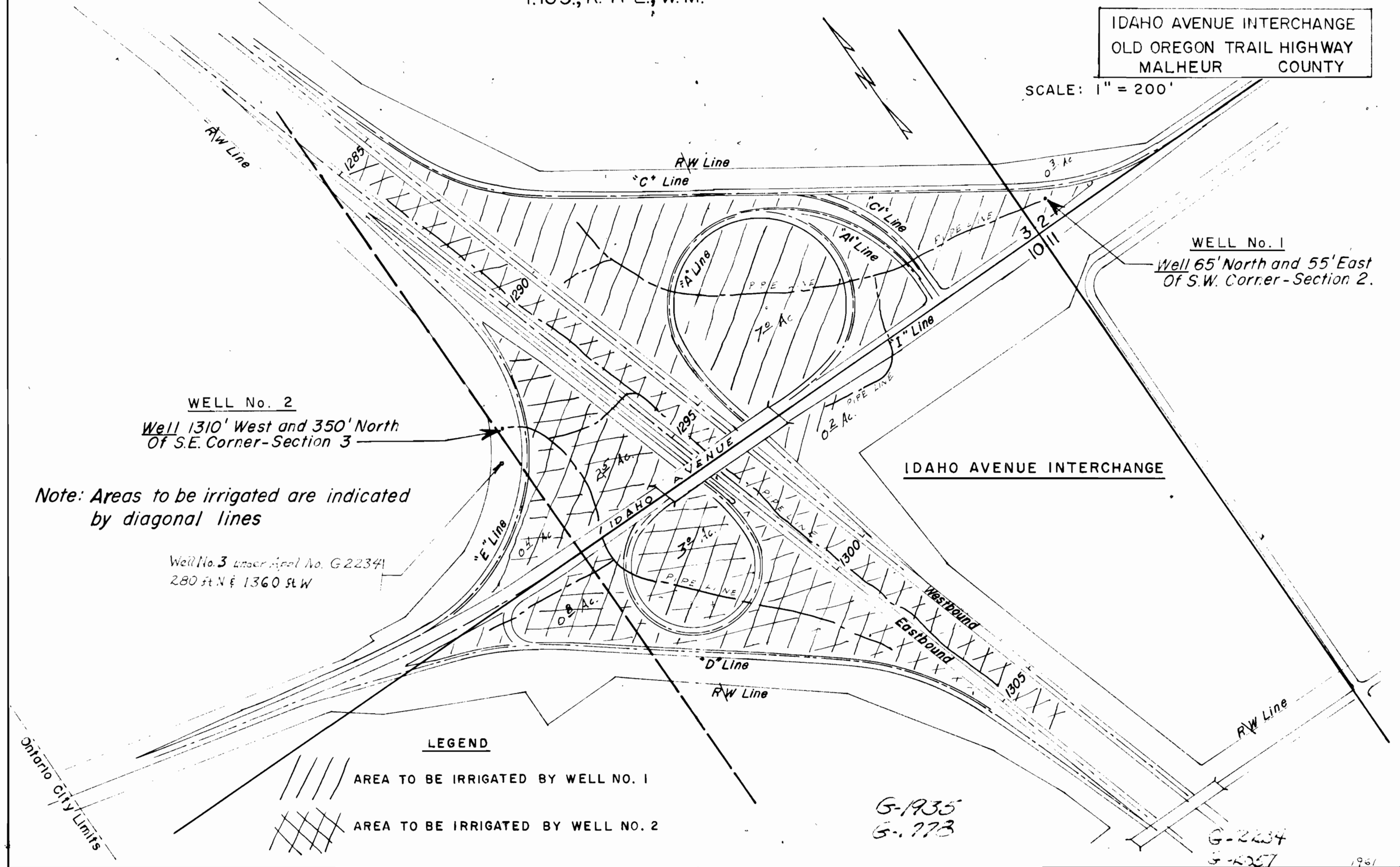



WELL No. 2
Well 1310' West and 350' North
Of S.E. Corner-Section 3

WELL No. 1
Well 65' North and 55' East
Of S.W. Corner-Section 2.

Note: Areas to be irrigated are indicated
by diagonal lines

Well No. 3 under Appl. No. G 22341
280 ft N & 1360 ft W

LEGEND

-  AREA TO BE IRRIGATED BY WELL NO. 1
-  AREA TO BE IRRIGATED BY WELL NO. 2

G-1935
G-773

G-2234
G-2257