

RECEIVED BY OWRD

JUN 20 2016

SALEM, OR

Permitted well #8 - 20' N & 40' E from the SW corner SEC 23, T 23S, R 33E w.m. SW 1/4 SW 1/4.

Proposed well #8 - 1310' N & 1310' W from the SE corner SEC 23, T 23S, R 33E. w.m. SE 1/4 SE 1/4

Scale 1" = 1320'

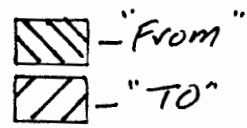

SECTION PLAT

9-17249

Section 16, 21, 22, 23

Township 23-S

Range 33-E

PAGE 1 OF 2

County of HARNEY

State of OR

Permit Amendment for Department of State Lands
NORTH

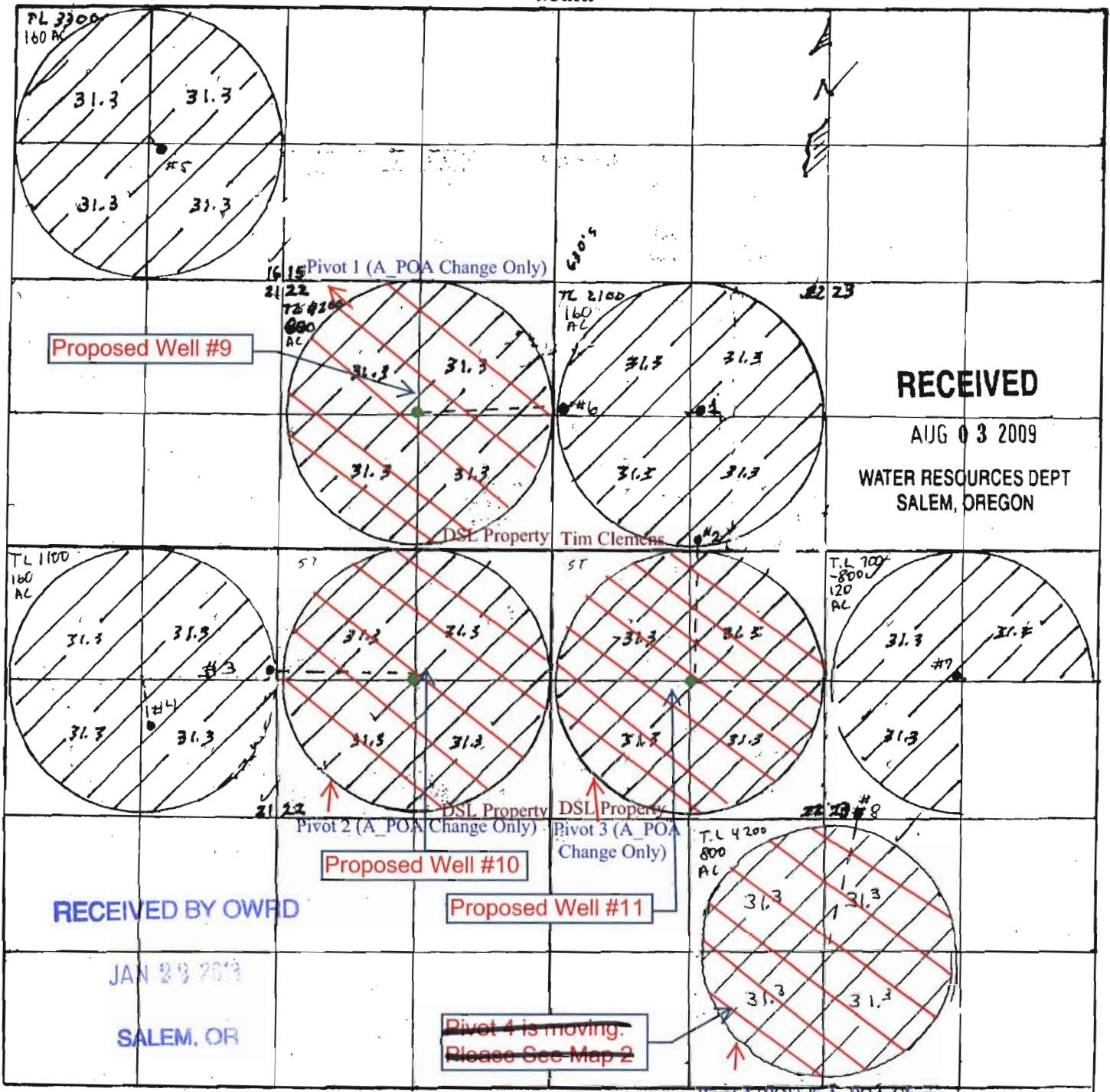

RECEIVED

AUG 03 2009

WATER RESOURCES DEPT
SALEM, OREGON

RECEIVED BY OWRD

JAN 23 2013

SALEM, OR

Pivot 4 is moving.
Please See Map 2

Remarks scale 4" = 1 mile - 660'

Lands owned by DSL are to be partially assigned to them the Remaining are to stay in Tim Clemens name.



Lands Remaining



Lands affected by Permit Amendment

Well Locations: Well #9: T23S R33E sec. 22 NW 1/4 center
Well #10: T23S R33E sec. 22 center of SW 1/4
Well #11: T23S R33E sec. 22 center of SE 1/4
Well #12: T23S R33E sec. 10 center of NW 1/4
Well #13: T23S R33E sec. 10 NW 1/4, NW 1/4

Still good well #11 for APOA

1

SECTION PLAT

Township 23 South Range 33 East Section 16, 21, 22, 23, 26, 27

County Harney State Oregon

north

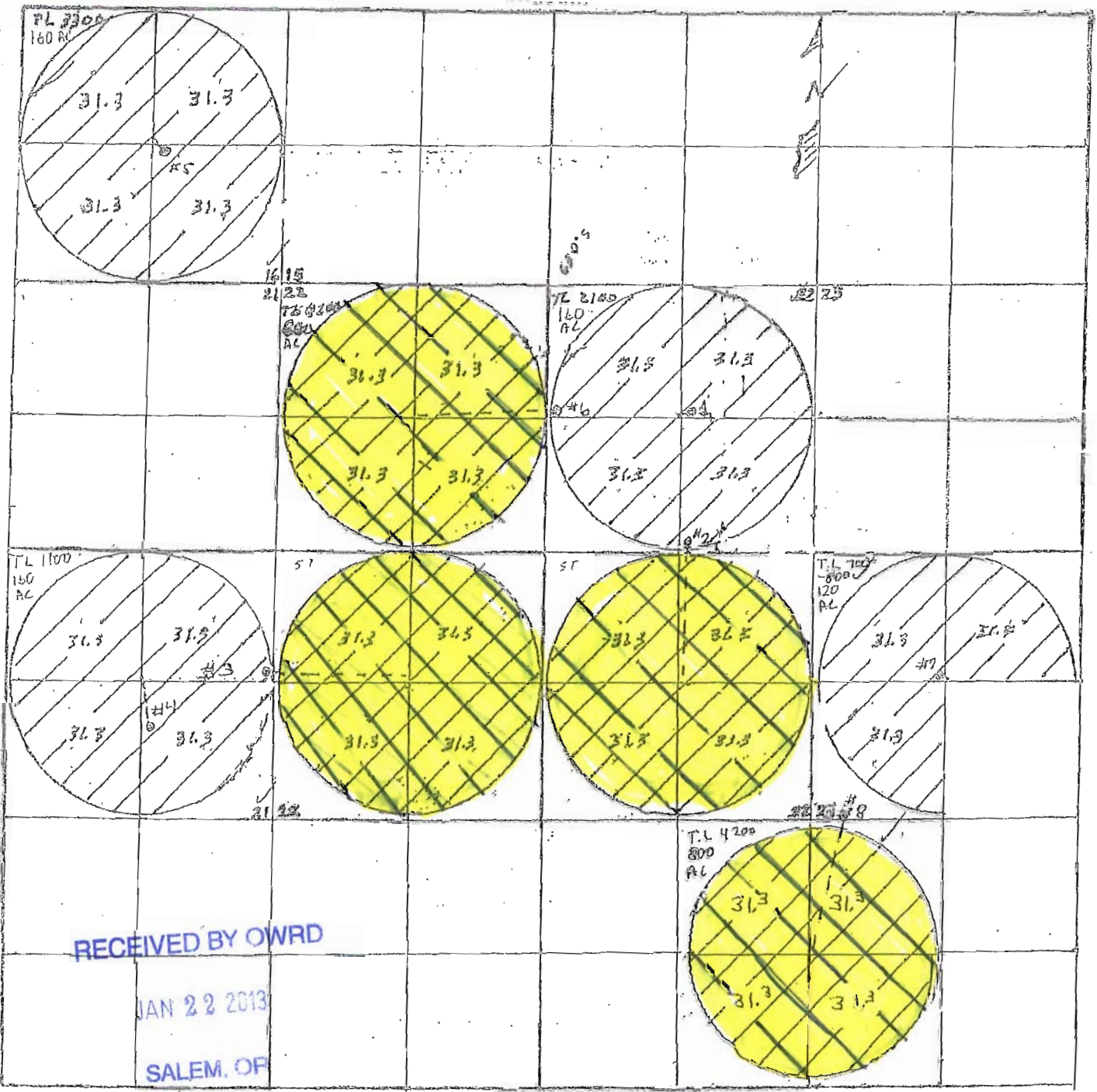

Remarks scale $\frac{1}{4}$ " = 1 mile - see) T.L. 4200 (640 Acres) Leased State Lands



Permit # G-16667
portion left unchanged
Tim Clemens

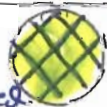

portion of Permit changed
to Depart state Lands

SECTION PLAT

Section 16, 21, 22, 23

Township 23 S.

Range 33 E

County of HARNEY

State of ORE.

● - wells

NORTH

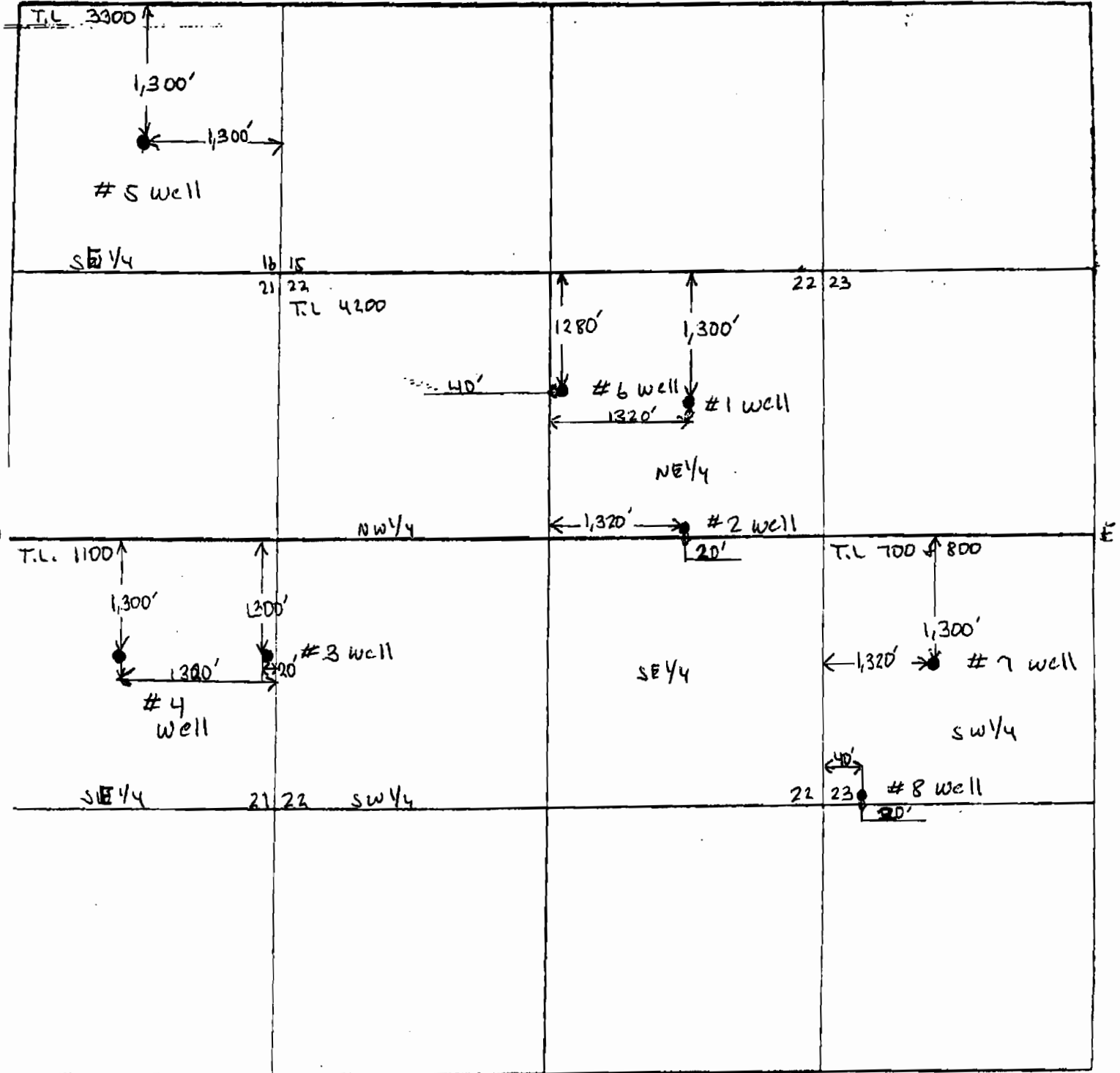

RECEIVED

AUG 06 2009

WATER RESOURCES DEPT
SALEM, OREGON