

Permit Amendment Application Additional Point of Appropriation

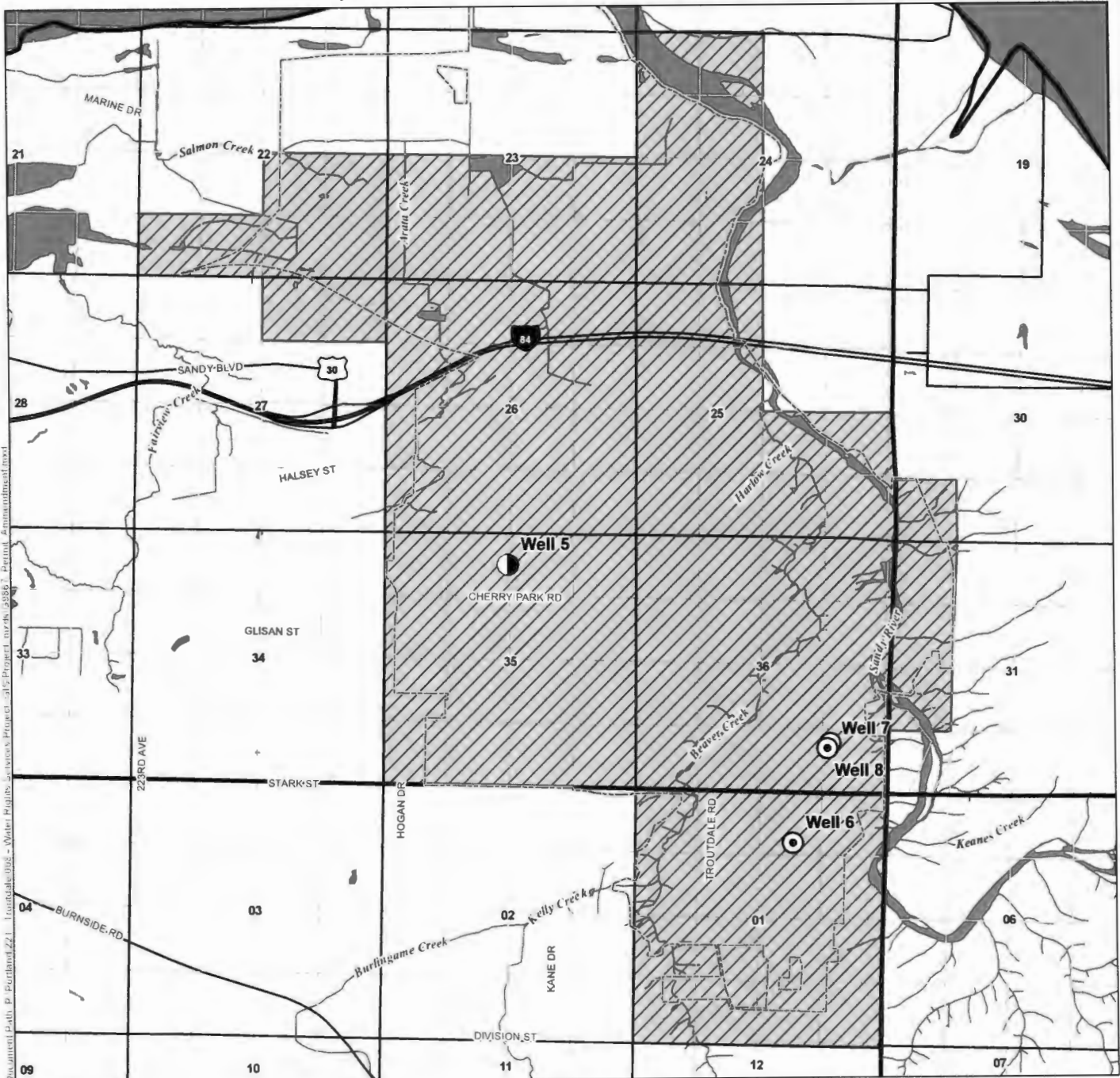





Application G-9714, Permit G-9867
City of Troutdale, Oregon

Townships 1 North and 1 South, Ranges 3 and 4 East (W.M.)



Document Path: P:\Portland\21 - Water Rights Services\Project\036 - Permit Amendment.mxd

LEGEND

-  Authorized Point of Appropriation
-  Authorized and Proposed Additional Point of Appropriation
-  Authorized Place of Use (POU)
-  City of Troutdale
-  Highway
-  Watercourse
-  Waterbody

DISCLAIMER

This map was prepared for the purpose of identifying the location of a water right only and it is not intended to provide legal dimensions or location of property ownership lines.

RECEIVED BY OWRD

FEB 03 2017

MAP NOTES

Date: January 17, 2017
Data Sources: BLM, METRO, USGS

POA LOCATION DESCRIPTION

- Well 5:** Located 650 feet South and 2,550 feet East from the NW corner of Section 35, Township 1 North, Range 3 East (W.M.)
- Well 6:** Located 1,050 feet South and 1,950 feet West from the NE corner of Section 1, Township 1 South, Range 3 East (W.M.)
- Well 7:** Located 1,050 feet North and 1,220 feet West from the SE corner of Section 36, Township 1 North, Range 3 East (W.M.)
- Well 8:** Located 936 feet North and 1,284 feet West from the SE corner of Section 36, Township 1 North, Range 3 East (W.M.)

SALEM, OR

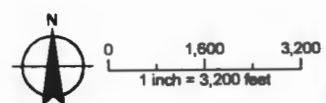

T 12585

FUTURE WATER SERVICE AREA

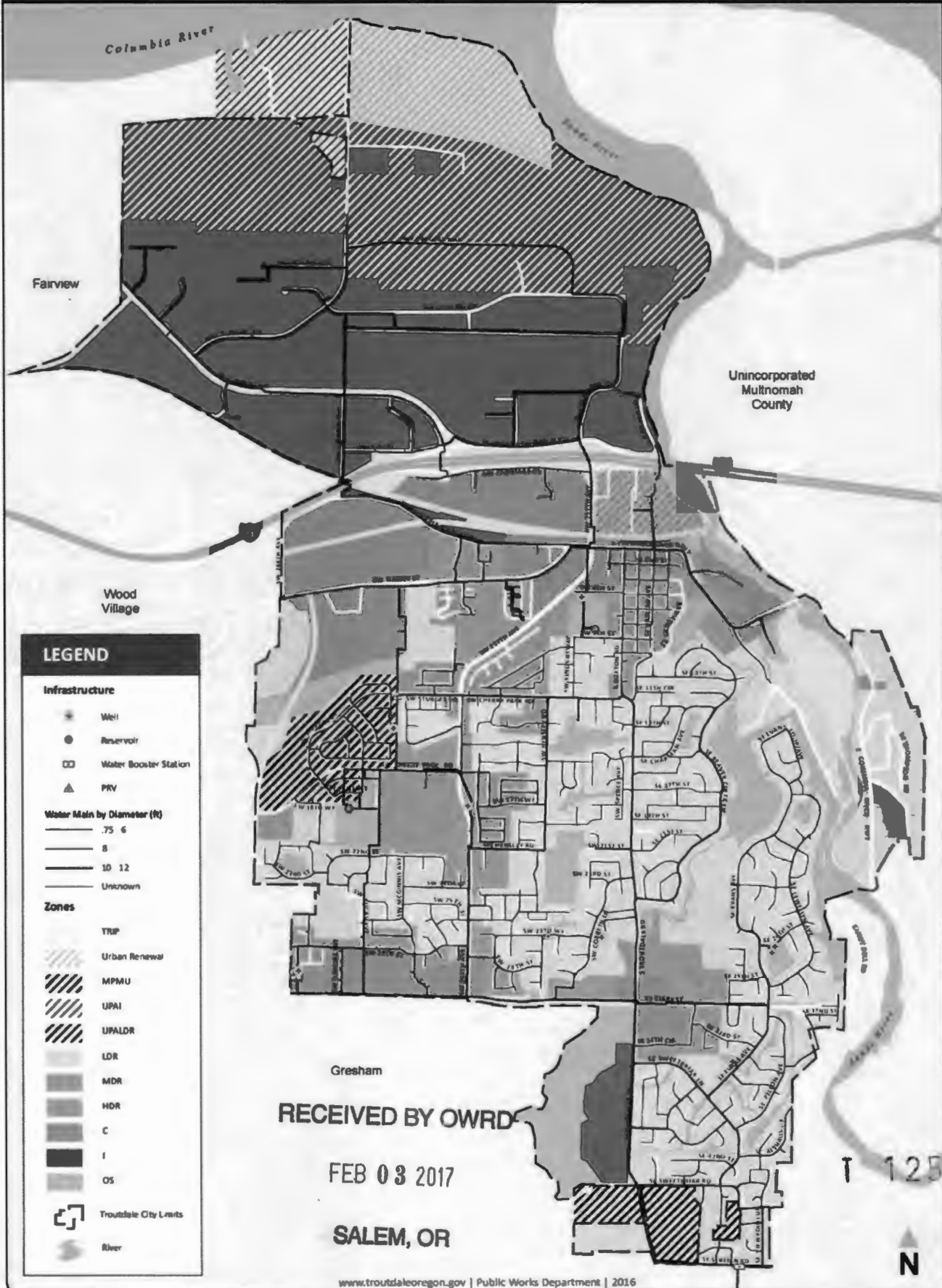

RECEIVED BY OWRD

FEB 03 2017

SALEM, OR

T 12585