

# T14S, R45E, Sections 17 and 18, Willamette Meridian

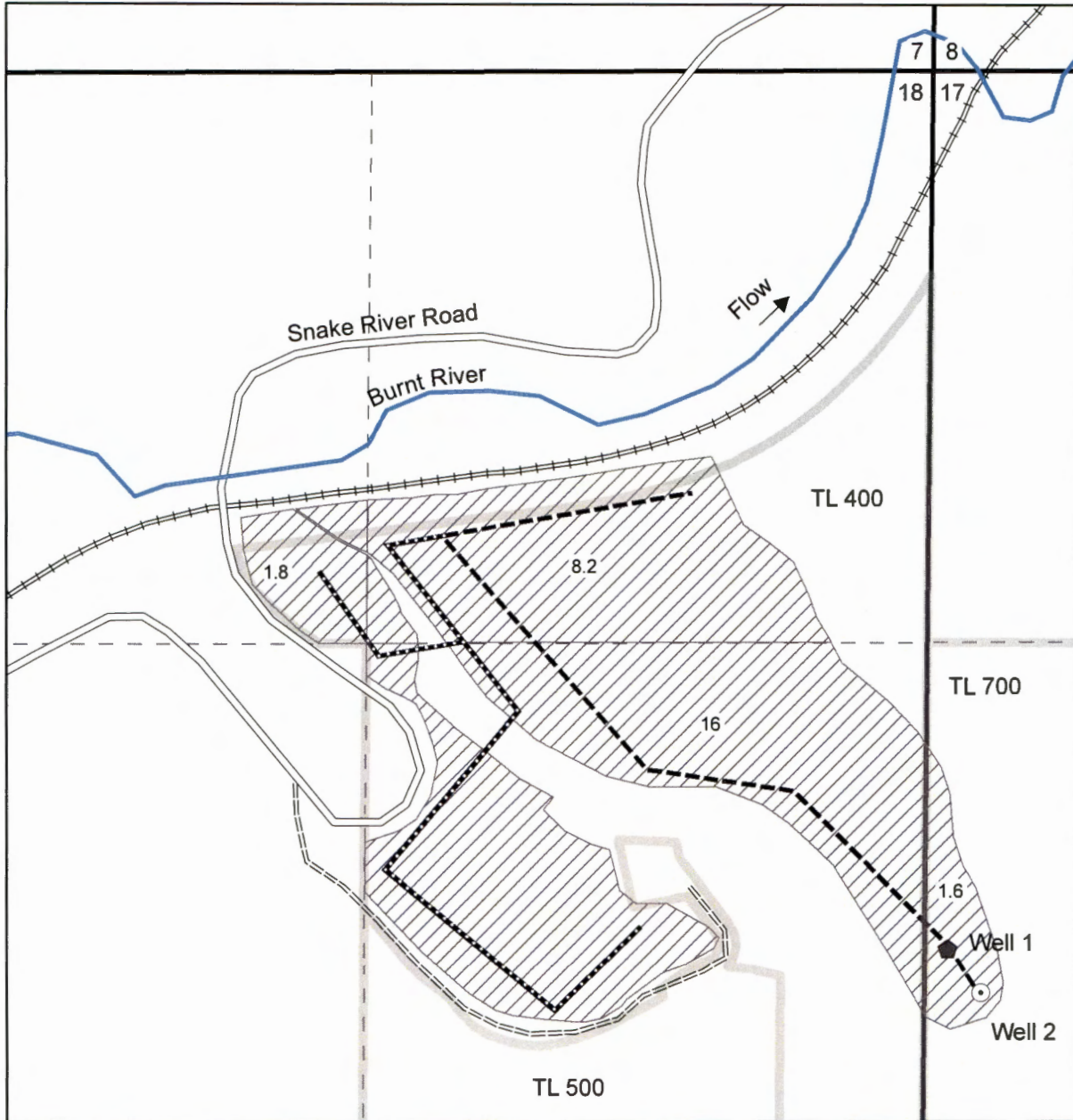

Proposed well 1 is located in the SW NW, T14S, R45E, Section 17, 55 feet east and 2040 feet south of the northwest corner of Section 17.

Proposed well 2 is located in the SW NW, T14S, R45E, Section 17, 130 feet east and 2145 feet south of the northwest corner of Section 17.

This map is not intended to provide legal dimensions or locations of property ownership lines.

- ◆ Proposed drilled well
- Proposed dug well
- ▨ Proposed supplemental water right
- Dirt road
- ≡≡≡ Railroad
- River
- Paved road
- Tax lot line
- Above ground pipe
- Buried pipe line
- - - Government lot line
- - - Quarter quarter line
- Section line

Groundwater Permit Application  
Tax lots 400 and 700  
prepared for  
Barber Ranch, LLC

map prepared by  
Nancy Rorick Consulting

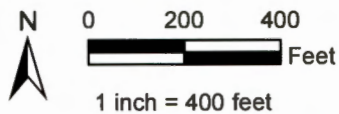

Rev'd 1/18/2017

GT-10424

Map revised 1/18/2017