

T.4S. R.1E. Section 24, W.M.

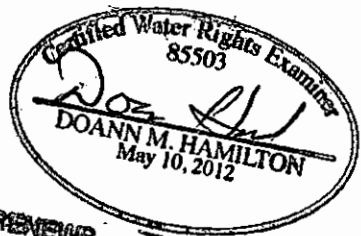
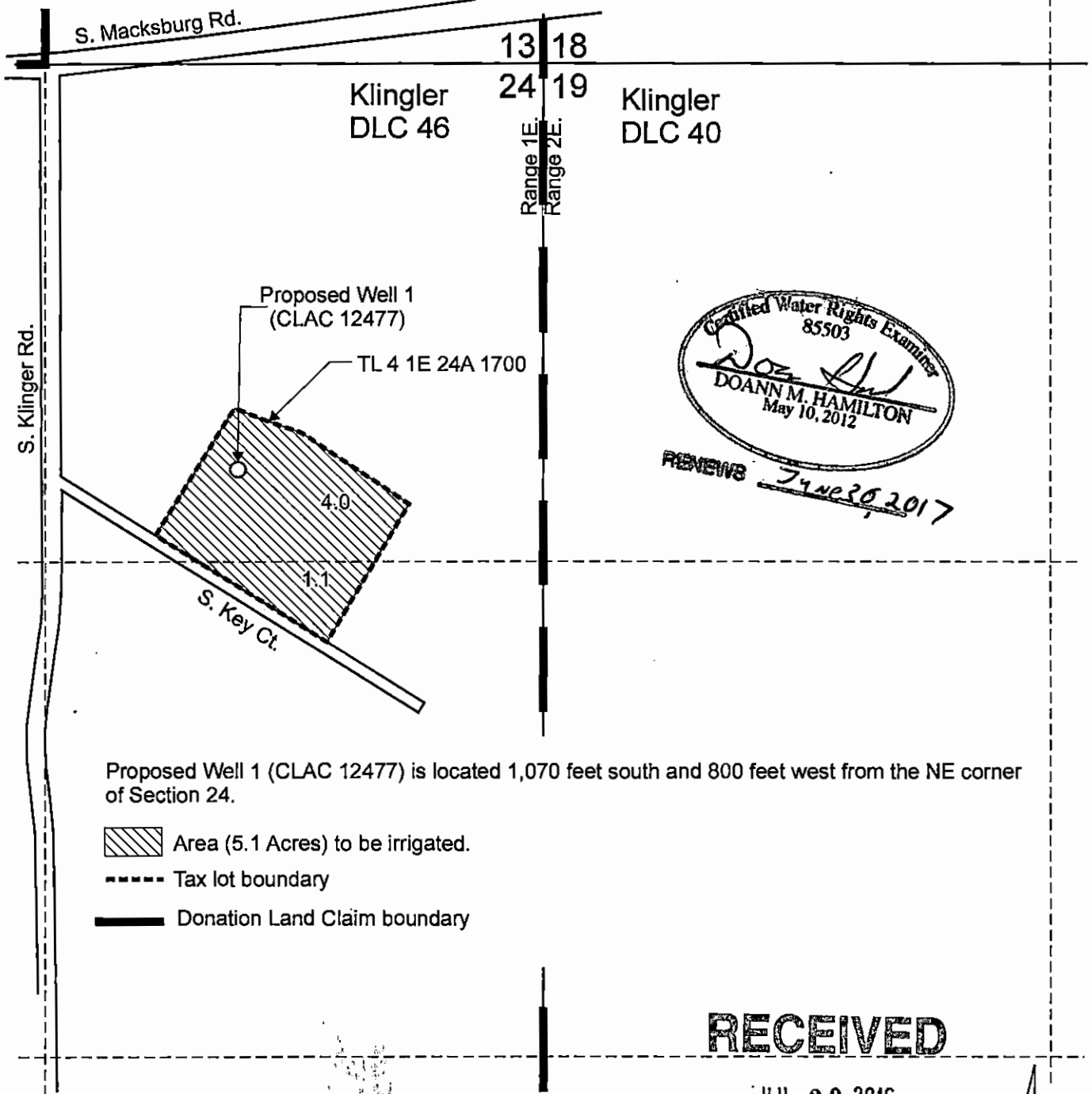

RENEWS JUNE 20 2017

Proposed Well 1 (CLAC 12477) is located 1,070 feet south and 800 feet west from the NE corner of Section 24.

- Area (5.1 Acres) to be irrigated.
- Tax lot boundary
- Donation Land Claim boundary

RECEIVED

JUL 29 2016

WATER RESOURCES DEPT
SALEM, OREGON

This map was prepared for the purpose of identifying the location of a water right only and is not intended to provide legal dimensions or location of property ownership lines.



Scale: 1" = 400'



Ground Water Application Map

Peter Munro
T.4S. R.1E. Section 24, W.M.

Pacific Hydro-Geology Inc.

06/2016

MunroGWappMap.cdr

6-8152