

T17S, R43E, Sections 1 and 2, Willamette Meridian

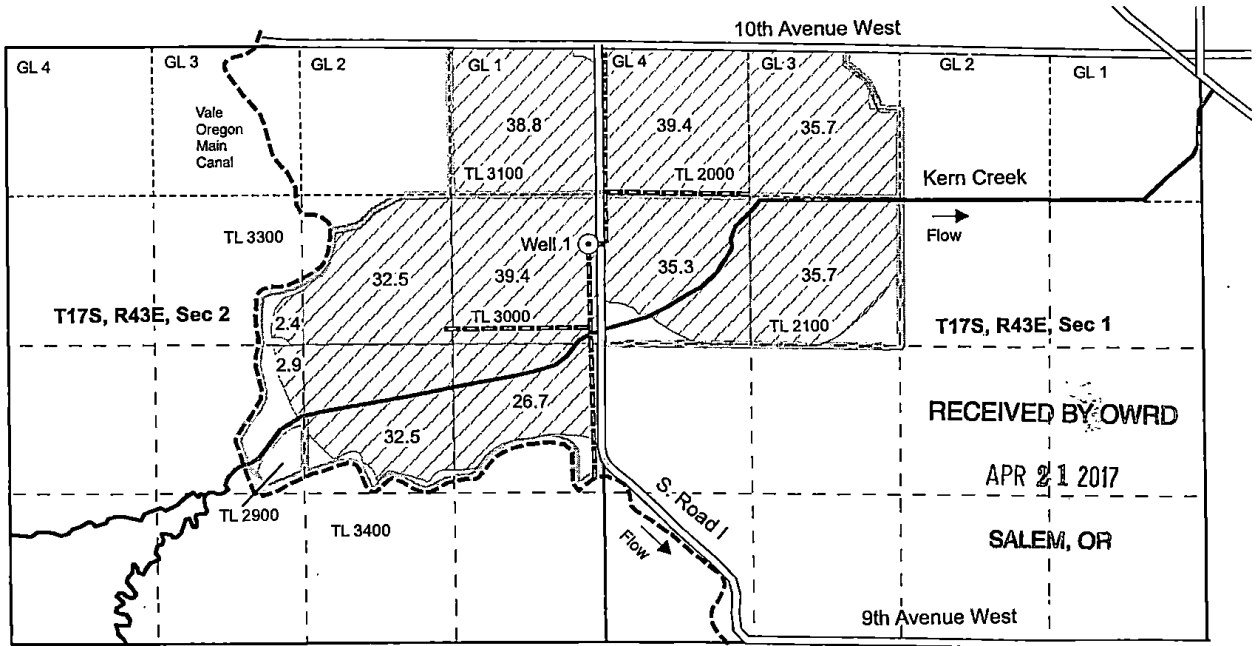

RECEIVED BY OWRD

APR 21 2017

SALEM, OR

- Well
- Main lines
- Tax lot lines
- Canal
- Road
- Stream
- Government lot line
- - - Quarter quarter line
- Section line
- ▨ Proposed supplemental groundwater right

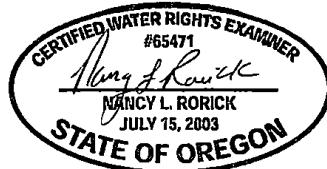

Expires 12/31/2018

Well 1 (MALH 54164) is located 120 feet west and 1,790 feet south of the NE corner of Section 2.

This map is not intended to provide legal dimensions or locations of property ownership lines.

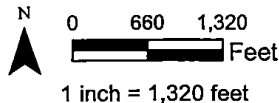

Grant 4D Farms
Groundwater Permit Application
Malheur County
Tax lots 2000, 2100, 3000, and 3100

map prepared by:

Nancy Rorick Consulting