

# Water Right Application Map in the Name of the City of Monroe Proposed Point of Diversion and Place of Use

Township 14 South, Range 5 West (W.M.)

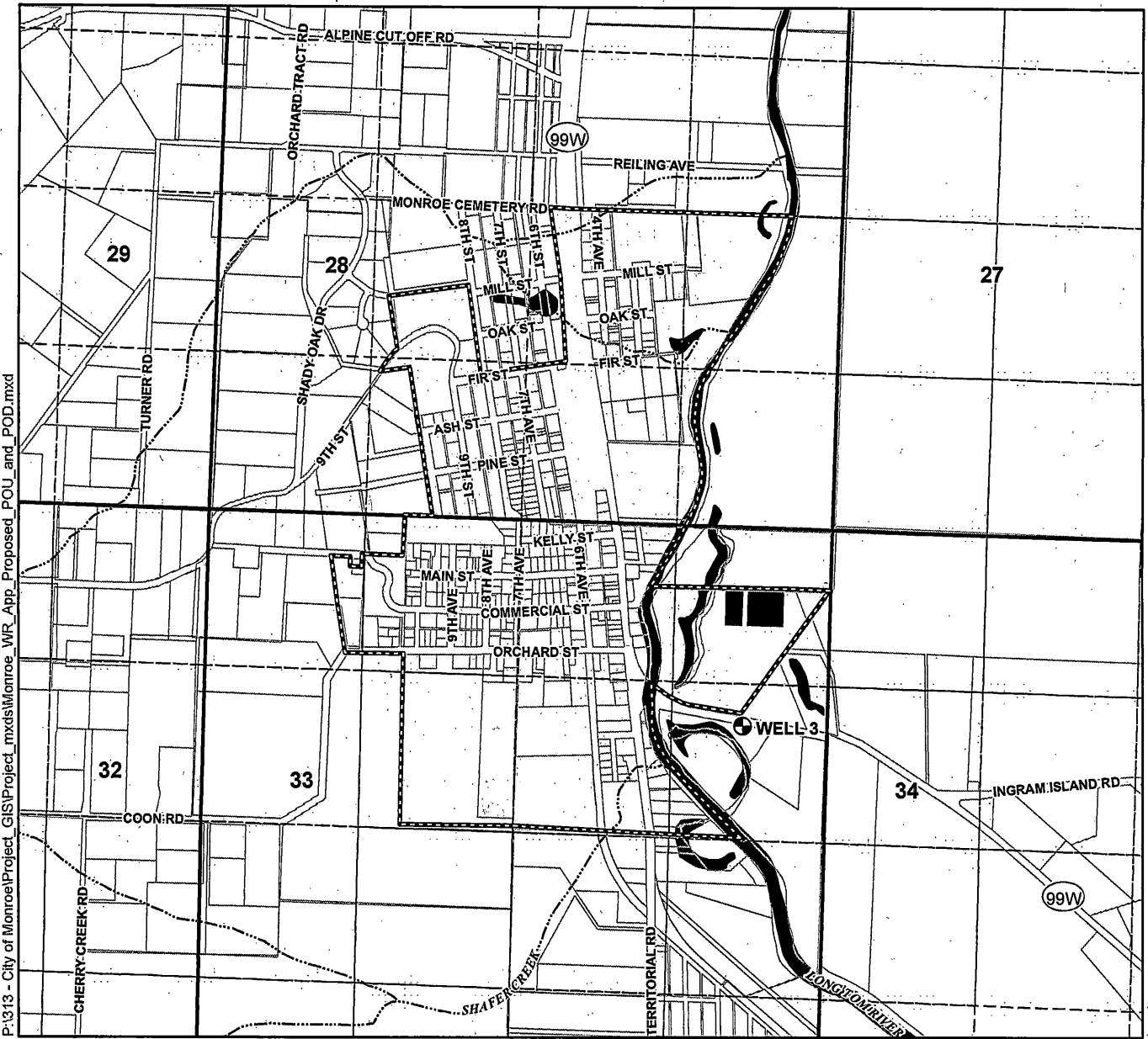

P:\313 - City of Monroe\Project\_GIS\Project\_mxd\Monroe\_WR\_App\_Proposed\_POU\_and\_POD.mxd

### Legend

- Proposed Point of Diversion (POD)
- Proposed Place of Use (POU)
- Tax Lots
- Waterbodies
- Watercourses

### POD Location Description

**Well 3**  
 Located 1,670 feet South and 720 feet West from the NE corner of  
 Section 33, Township 14 South, Range 5 West (W.M.), within tax lot 2500

RECEIVED

OCT 05 2009

WATER RESOURCES DEPT  
SALEM, OREGON

### Map Information

Projection: Oregon State Plane North Zone  
 Datum: North American Datum of 1983  
 Date: March 5, 2009  
 Prepared By: GSI Water Solutions, Inc.

### Data Sources

Oregon Geospatial Data Clearinghouse, Benton County GIS

### Disclaimer

This map was prepared for the purpose of identifying the location of a water right only and it is not intended to provide legal dimensions or location of property ownership lines.

