

T.7S. R.2W. Section 14, W.M.

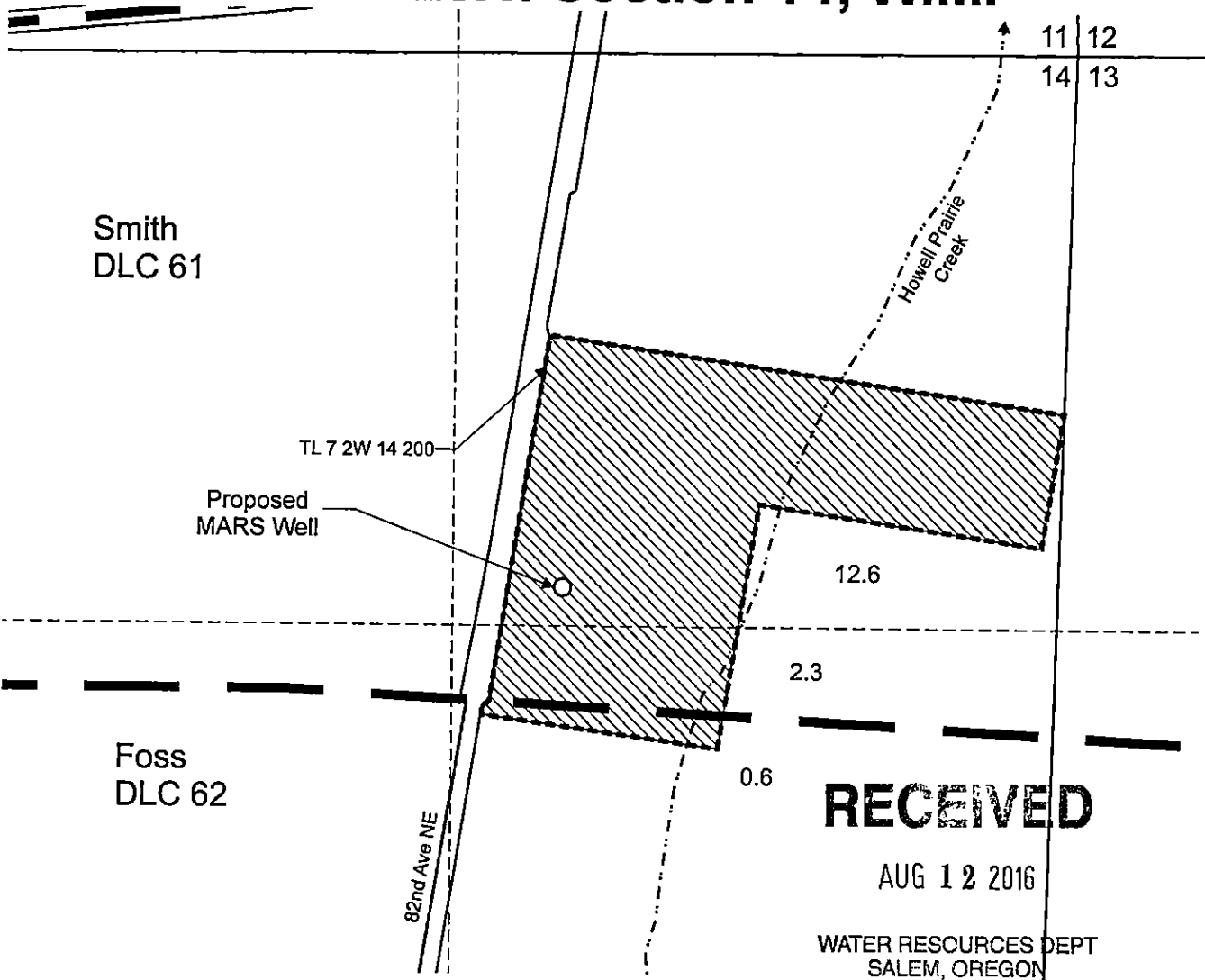

RECEIVED
 AUG 12 2016
 WATER RESOURCES DEPT
 SALEM, OREGON

Proposed MARS Well is located 1,235 feet south and 1,185 feet west from the NE corner, Section 14.

 Area to be used for commercial use.

 Tax lot boundary

 Donation Land Claim boundary

Scale: 1" = 400'

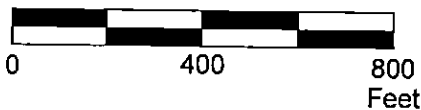

RENEWS June 30 2017

This map was prepared for the purpose of identifying the location of a water right only and is not intended to provide legal dimensions or location of property ownership lines.

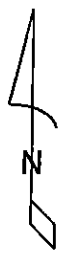

GandCGWAppMap.cdr

Pacific Hydro-Geology Inc.

Groundwater Application Map

MARS Enterprises, LLC
 T.7S. R.2W. Section 14, W.M.

07/2016

G-19365