

# Groundwater Application for 12 Acres of Irrigation/Nursery Use

## 34S-3W-32-TL 2500

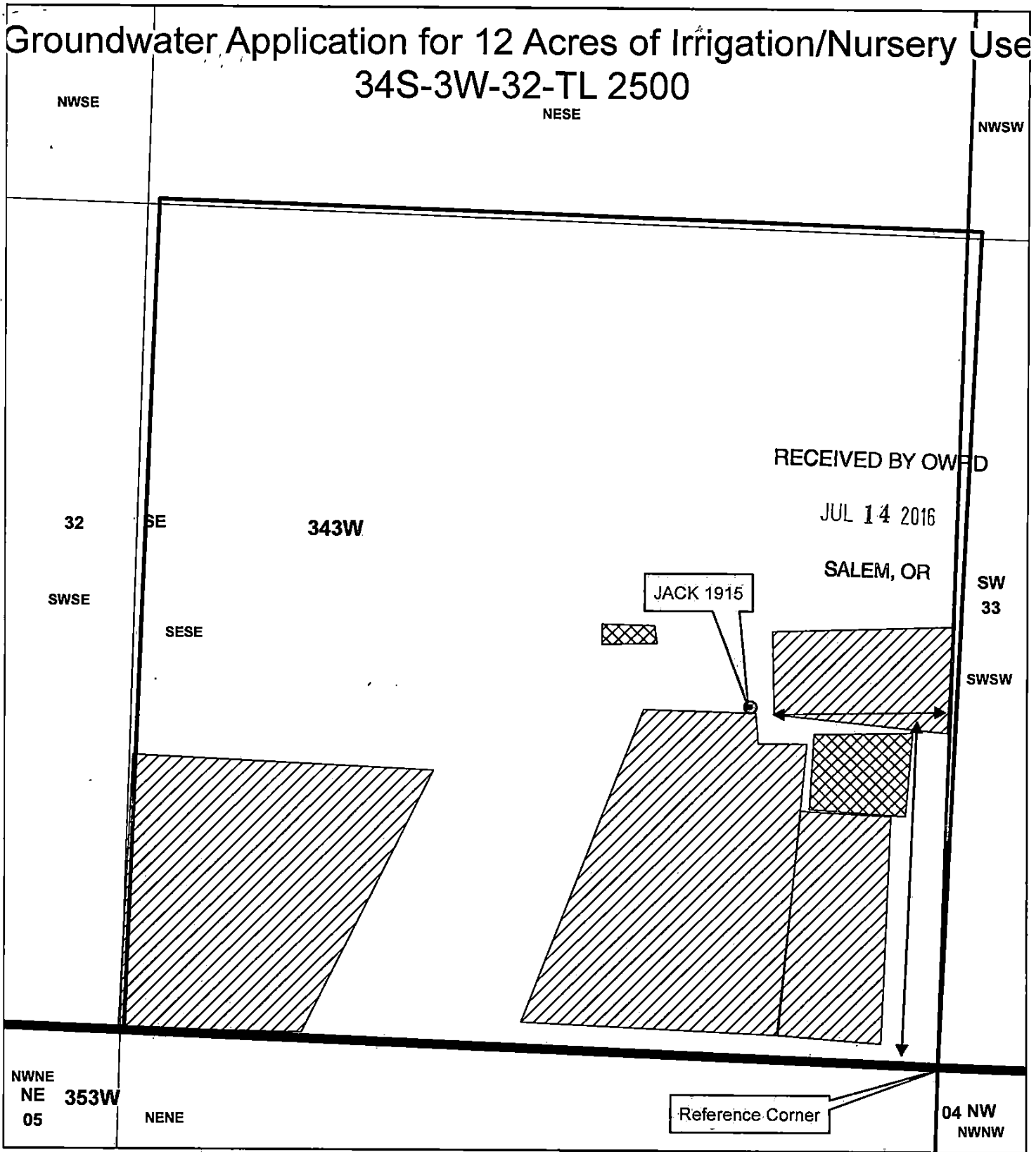

### Legend

- TL 2500
- Well JACK 1915
- Place of use for Irrigation
- Sections
- Quarter Sections

Place of use for Nursery 1 inch = 208 feet

Well is 575 ft N  
and 331 ft W from  
SE Corner of Section 32

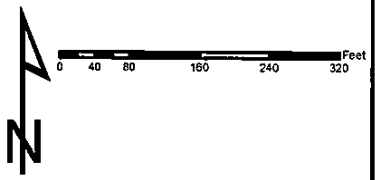

JACKSON COUNTY  
**WATERMASTER**

Prepared by Shavon Haynes  
This map is based on a digital database compiled by Jackson County from a variety of sources. Jackson County cannot accept responsibility for errors, omissions, or positional accuracy. There are no warranties, expressed or implied.

Date: 03/30/2016; 34-3-32 TL 2500.mxd; haynes1

6-18343