

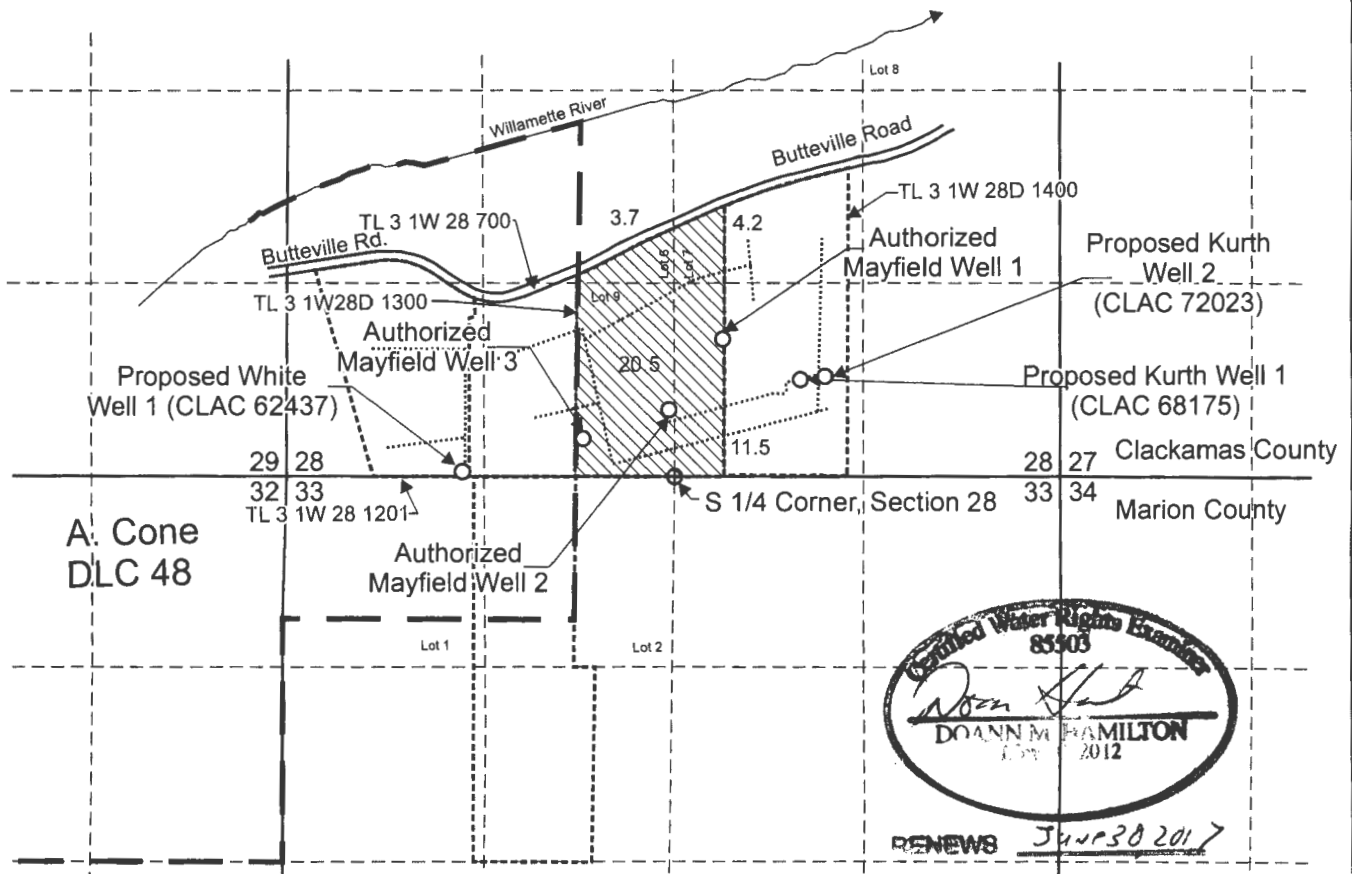



T.3S. R.1W. Section 28, W.M.



Authorized Mayfield Well 1 is located 940 feet north and 330 feet east from the S1/4 corner, Section 28.
 Authorized Mayfield Well 2 is located 450 feet north and 40 feet west from the S1/4 corner, Section 28.
 Authorized Mayfield Well 3 is located 260 feet north and 630 feet west from the S1/4 corner, Section 28.
 Proposed Kurth Well 1 (CLAC 68175) is located 665 feet north and 1,770 feet west from the SE corner, Section 28.
 Proposed Kurth Well 2 (CLAC 72023) is located 685 feet north and 1,600 feet west from the SE corner, Section 28.
 Proposed White Well 1 (CLAC 62437) is located 30 feet north and 1,200 feet east from the SW corner, Section 28.

-  Area (39.9 Acres) irrigated under Application G-16504, Permit G-16070, priority date, August 1, 2005.
-  Tax Lot boundary
-  Donation Land Claim boundary
-  Irrigation mainline

Scale: 1" = 1,320'

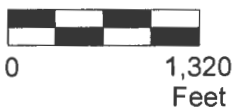

RECEIVED

SEP 23 2016

WATER RESOURCES DEPT
 This map was prepared for the purpose of identifying the location of a water right only and is not intended to provide legal dimensions or location of property ownership lines.



Permit Amendment Application Map
 Application G-16504, Permit G-16070

Elsinore Development Group, L.L.C.
 T.3S. R.1W. Section 28, W.M.

Pacific Hydro-Geology Inc.

08/2016

Page 1 of 2

T 12490