

MAP TO ACCOMPANY APPLICATION TO CHANGE PLACE OF USE & POINT OF APPROPRIATION FOR BANK OF EASTERN OREGON

TAX LOTS 4300 & 4400
IN SECTION 16, TOWNSHIP 24 SOUTH, RANGE 32.5 EAST, W.M.
HARNEY COUNTY, OREGON

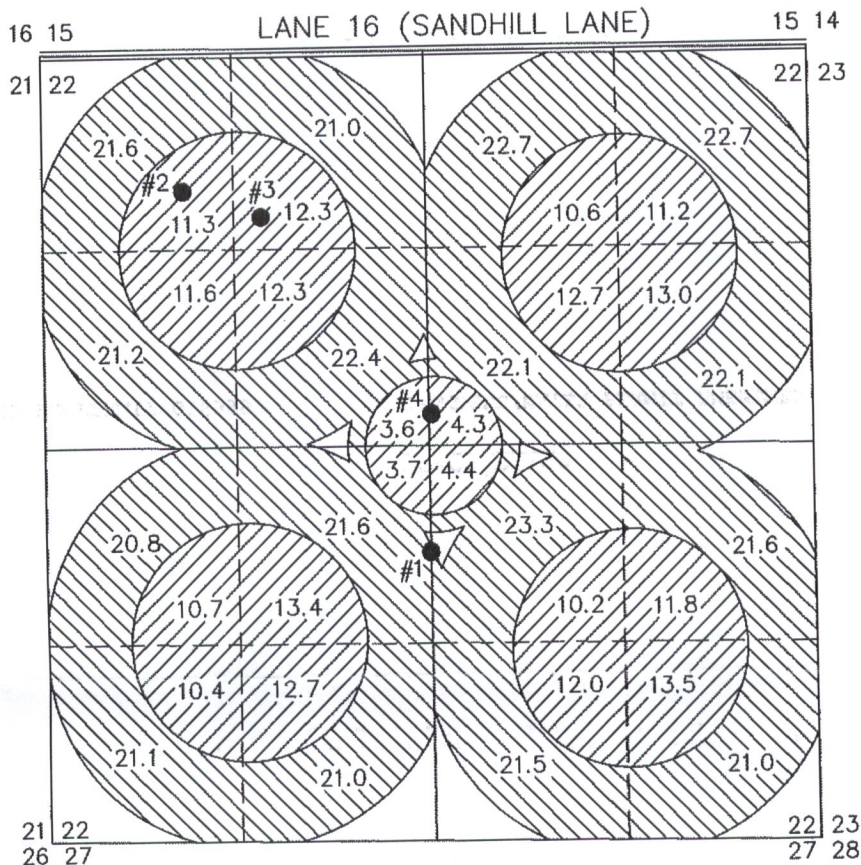

RECEIVED

MAR 22 2018

OWRD

THIS MAP IS FOR THE PURPOSE OF LOCATING A WATER
RIGHT ONLY AND HAS NO INTENT TO PROVIDE LEGAL
DIMENSIONS OR THE LOCATION OF PROPERTY LINES.

 206.0 ACRES IR FROM PERMIT G-12033, AS SHOWN

 347.7 ACRES IS FROM PERMIT G-16399, AS SHOWN

- WELL #1 (HARN 51855) IN THE NE 1/4 OF THE SW 1/4 SECTION 16 & 2970' SOUTH & 2640' EAST FROM THE NW CORNER SECTION 16.
- WELL #2 (HARN 960/51482) IN THE NW 1/4 OF THE NW 1/4 SECTION 16 & 948' SOUTH & 971' EAST FROM THE NW CORNER SECTION 16.
- WELL #3/5 (HARN 958) IN THE NE 1/4 OF THE NW 1/4 SECTION 16 & 1141' SOUTH & 1509' EAST FROM THE NW CORNER SECTION 16.
- WELL #4 (HARN 959) IN THE SE 1/4 OF THE NW 1/4 SECTION 16 & 2442' SOUTH & 2640' EAST FROM THE NW CORNER SECTION 16.

PROJECT No. 17-062

PREPARED AT THE REQUEST OF:
BANK OF EASTERN OREGON
P.O. BOX 39
HEPPNER, OR 97836

**ALL POINTS ENGINEERING
& SURVEYING, INC.**



P.O. BOX 767
TERREBONNE, OREGON 97760
(541) 548-5833 PH
scott@apeands.com
www.APEandS.com