

**Application for a  
Groundwater Permit  
in the Name of City of Prineville**  
Proposed Points of Appropriation  
Township 15 South  
Range 16 East (W.M.)

**LEGEND**

- Proposed Point of Appropriation (POA)
- Pipeline
- Existing Water Mainline
- City Boundary
- Tax Lot
- Watercourse
- Waterbody

**RECEIVED**

APR 25 2018

**OWRD**

**DISCLAIMER**

This map was prepared for the purpose of identifying the location of a water right only and it is not intended to provide legal dimensions or location of property ownership lines.

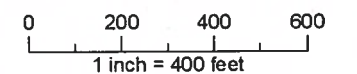

Date: April 10, 2018  
Data Sources: OGIC, USGS, ESRI,  
OWRD, DOGAMI

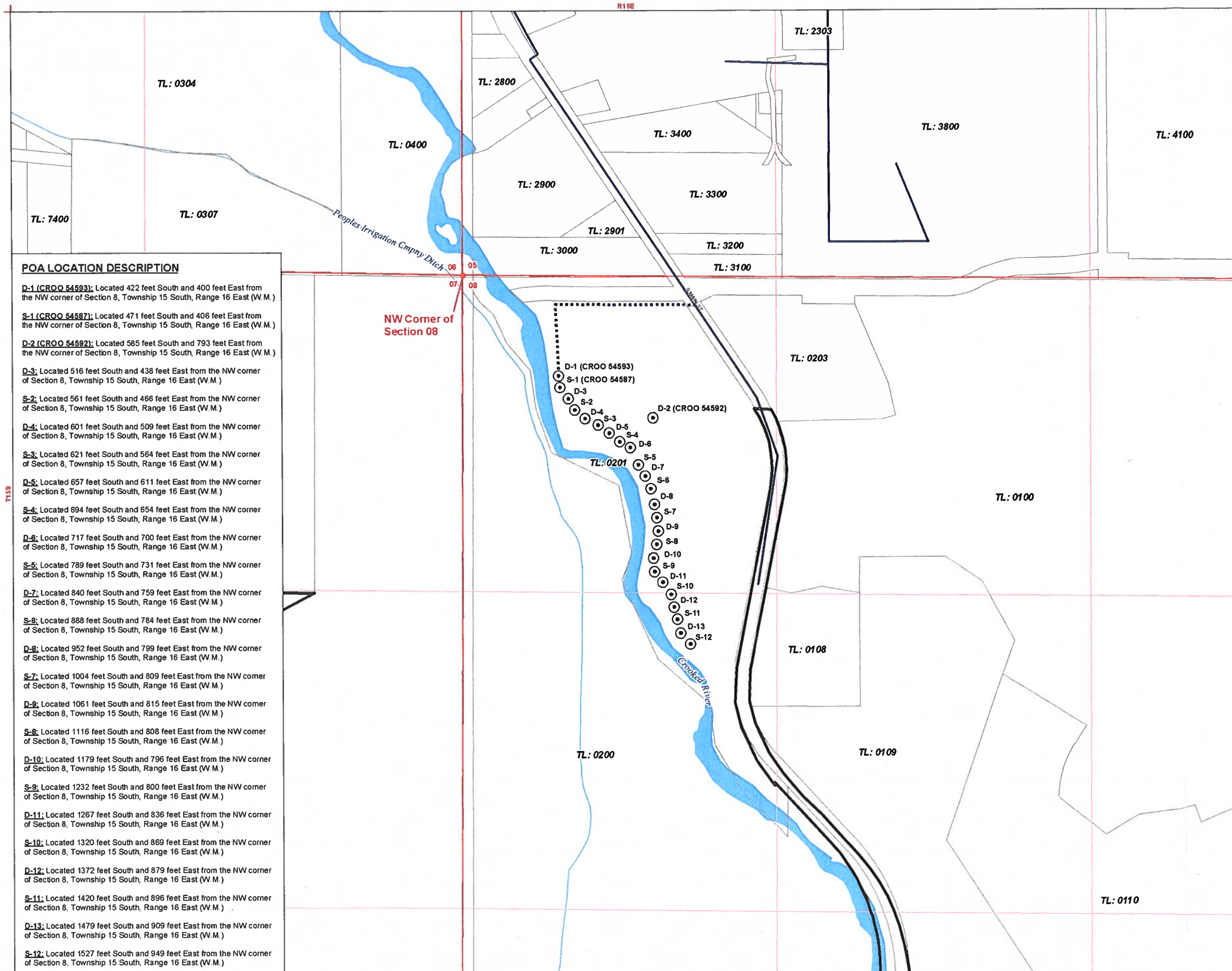









**POA LOCATION DESCRIPTION**

- D-1 (CROO 54593):** Located 422 feet South and 400 feet East from the NW corner of Section 8, Township 15 South, Range 16 East (W.M.)
- S-1 (CROO 54587):** Located 471 feet South and 406 feet East from the NW corner of Section 8, Township 15 South, Range 16 East (W.M.)
- D-2 (CROO 54592):** Located 585 feet South and 793 feet East from the NW corner of Section 8, Township 15 South, Range 16 East (W.M.)
- D-3:** Located 516 feet South and 438 feet East from the NW corner of Section 8, Township 15 South, Range 16 East (W.M.)
- S-2:** Located 561 feet South and 466 feet East from the NW corner of Section 8, Township 15 South, Range 16 East (W.M.)
- D-4:** Located 601 feet South and 509 feet East from the NW corner of Section 8, Township 15 South, Range 16 East (W.M.)
- S-3:** Located 621 feet South and 564 feet East from the NW corner of Section 8, Township 15 South, Range 16 East (W.M.)
- D-5:** Located 657 feet South and 611 feet East from the NW corner of Section 8, Township 15 South, Range 16 East (W.M.)
- S-4:** Located 694 feet South and 654 feet East from the NW corner of Section 8, Township 15 South, Range 16 East (W.M.)
- D-6:** Located 717 feet South and 700 feet East from the NW corner of Section 8, Township 15 South, Range 16 East (W.M.)
- S-5:** Located 789 feet South and 731 feet East from the NW corner of Section 8, Township 15 South, Range 16 East (W.M.)
- D-7:** Located 840 feet South and 759 feet East from the NW corner of Section 8, Township 15 South, Range 16 East (W.M.)
- S-6:** Located 888 feet South and 784 feet East from the NW corner of Section 8, Township 15 South, Range 16 East (W.M.)
- D-8:** Located 952 feet South and 799 feet East from the NW corner of Section 8, Township 15 South, Range 16 East (W.M.)
- S-7:** Located 1004 feet South and 809 feet East from the NW corner of Section 8, Township 15 South, Range 16 East (W.M.)
- D-9:** Located 1061 feet South and 815 feet East from the NW corner of Section 8, Township 15 South, Range 16 East (W.M.)
- S-8:** Located 1116 feet South and 808 feet East from the NW corner of Section 8, Township 15 South, Range 16 East (W.M.)
- D-10:** Located 1179 feet South and 796 feet East from the NW corner of Section 8, Township 15 South, Range 16 East (W.M.)
- S-9:** Located 1232 feet South and 800 feet East from the NW corner of Section 8, Township 15 South, Range 16 East (W.M.)
- D-11:** Located 1267 feet South and 836 feet East from the NW corner of Section 8, Township 15 South, Range 16 East (W.M.)
- S-10:** Located 1320 feet South and 869 feet East from the NW corner of Section 8, Township 15 South, Range 16 East (W.M.)
- D-12:** Located 1372 feet South and 879 feet East from the NW corner of Section 8, Township 15 South, Range 16 East (W.M.)
- S-11:** Located 1420 feet South and 896 feet East from the NW corner of Section 8, Township 15 South, Range 16 East (W.M.)
- D-13:** Located 1479 feet South and 909 feet East from the NW corner of Section 8, Township 15 South, Range 16 East (W.M.)
- S-12:** Located 1527 feet South and 949 feet East from the NW corner of Section 8, Township 15 South, Range 16 East (W.M.)

G18662

**Application for a  
Groundwater Permit  
in the Name of City of Prineville**  
Proposed Place of Use

**LEGEND**

-  Proposed Points of Appropriation (POA)
-  Proposed Place of Use (POU)
-  Existing Water Mainlines
-  Prineville City Limit
-  Tax Lot
-  Major Road
-  Railroad
-  Watercourse
-  Waterbody

RECEIVED

APR 25 2018

OWRD

**DISCLAIMER**

This map was prepared for the purpose of identifying the location of a water right only and it is not intended to provide legal dimensions or location of property ownership lines.

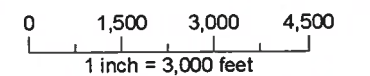

Date: April 2, 2018  
Data Sources: OWRD, Crook Co. GIS, OGIC, ESRI Water Solutions, Inc.

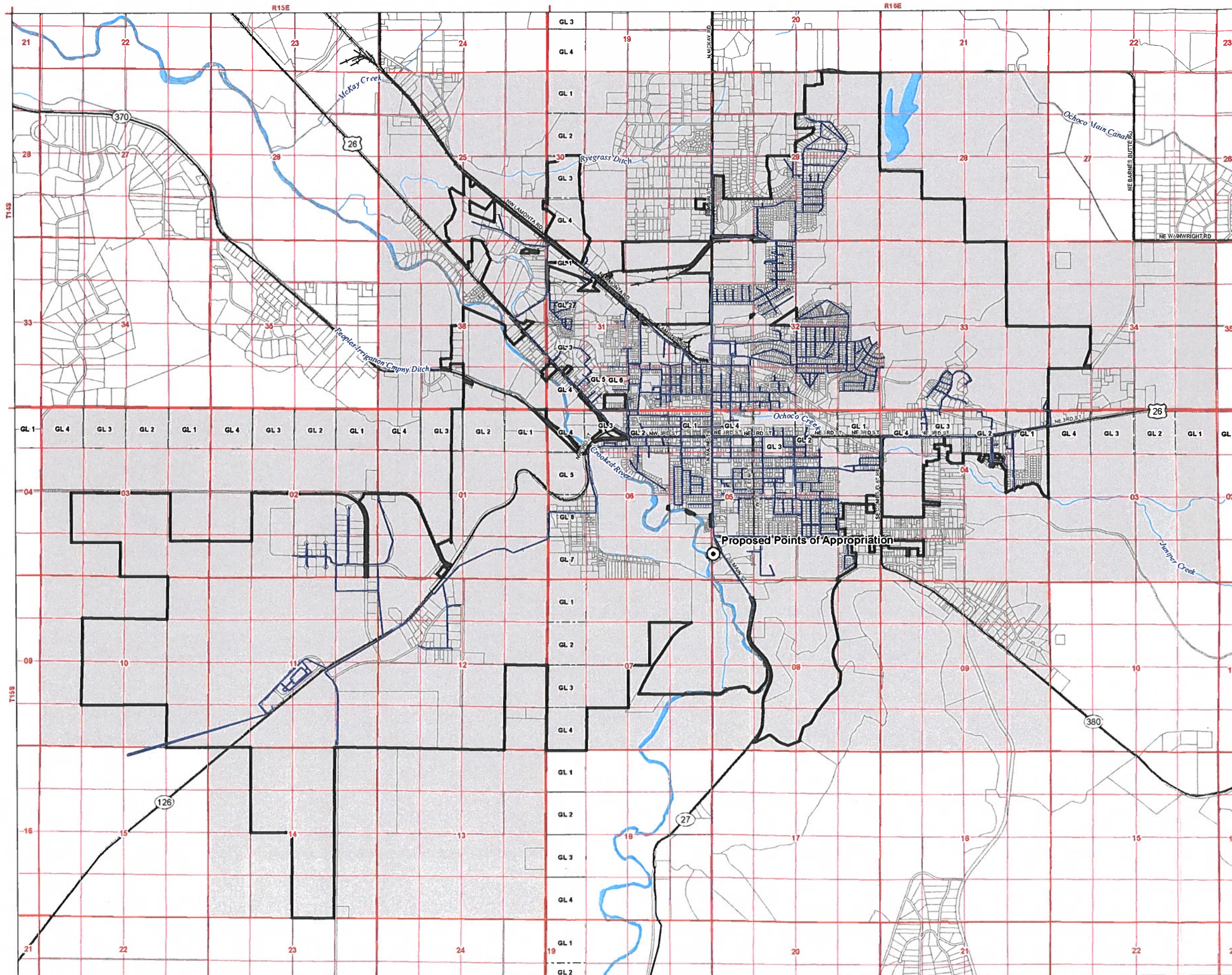

R-10117