

36-5-32

TWP. 36 S. R. 5 W. WM

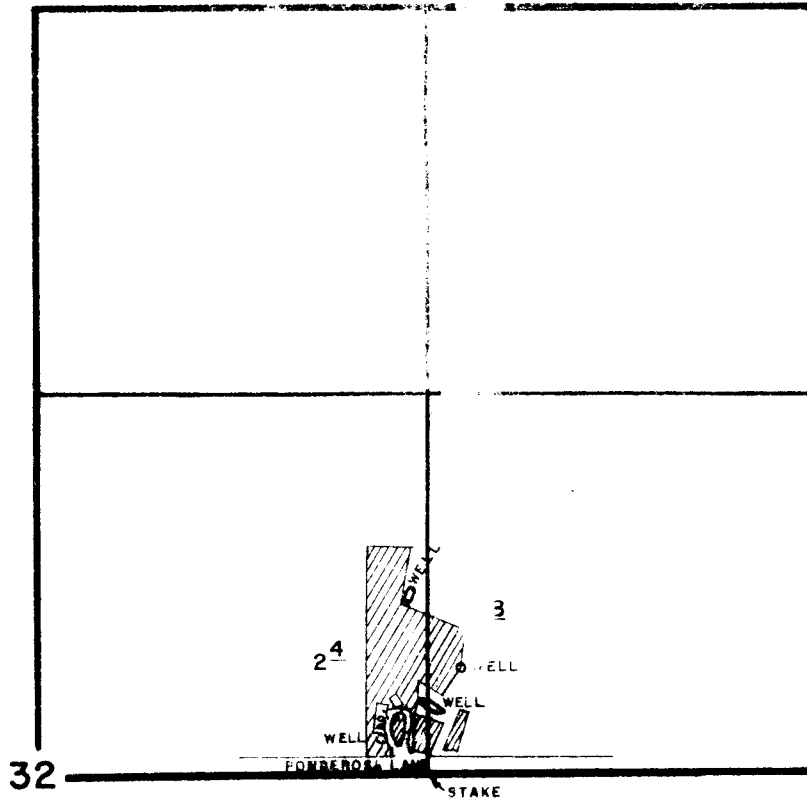

**FINAL PROOF SURVEY**

UNDER

SCALE: 8" = 1 MILE

Application No. G-1933 Permit No. G-1818  
IN NAME OF

JOHN H. TELFORD

Surveyed AUG. 15, 1963, by R. B. STEIMER